



**WESTERN  
SHELTER** SYSTEMS™



# CHALLENGE EVERYTHING

Western Shelter has been supporting life in the face of adverse weather conditions since 1988. We are dedicated to building the toughest shelters and field support systems on the market, and pride ourselves on providing safe and comfortable working environments for our customers around the globe. The Western Shelter System has been proven to reliably support field applications that range from temporary housing camps, bases of operation, mobile field hospitals, and many more.



# TABLE OF CONTENTS

RIGID FRAME SHELTERS	4	WATER HANDLING	50
INFLATABLE SHELTERS	12	WATER PURIFICATION	59
RUGGEDIZED POP UP	16	SANITATION	63
HYBRID SHELTERS	18	FURNISHINGS	64
RESPONSE TRAILERS	20	MEDICAL	69
CONTAINER SYSTEMS	26	DECON	77
SHELTER OPTIONS	28	AUDIO VISUAL	78
CLIMATE CONTROL	39	WS POWER	83
POWER	45	TRAINING	93

# 1935 SHELTER SYSTEM

Part Number SW-1935BC

A Tactical Shelter For Up To 20 Personnel



ISO 9001:2008 Registered Company



The Western Shelter system was designed to provide an easily transportable, simple to erect, and weather-secure working environment for operations in remote locations.

The 1935 shelter system can be rapidly deployed in the field without the use of tools or lifts, making it an ideal component of both stand alone operations and large scale interoperable systems.

## Key Features and Benefits

- Rapid deployment without aid of ancillary equipment, set-up anywhere
- Lightweight frame, packaging allows shelter to be moved / stowed by two people
- Vertical 6 ft. sidewalls maximize usable square footage
- Sealable vinyl floor maintains environmentally secure shelter
- Can be configured with roof or walls only for maximum flexibility in deployment
- Interior frame allows access to horizontal support bars capable of holding up to 50 lbs
- Rigid double doors provide a large entryway with ramp, move gurneys, large equipment
- Roof vent caps significantly reduces condensation
- Framework design allows individual replacement of parts
- Flame retardant vinyl is UV resistant for long life, resists mildew and abrasion

## Standard Components

- Aircraft aluminum mainframe assembly
- Berry Compliant fabric
- 14 oz. vinyl wall panels (4)
- 14 oz. vinyl roof panel
- 18 oz. sealable vinyl floor
- 46" double door with door ramp (2)
- Roof vent cap (2)
- High-wind tie down kit
- Expansion wall strips
- Vinyl repair kit
- Vinyl storage/transport bags

## Shelter Dimensions

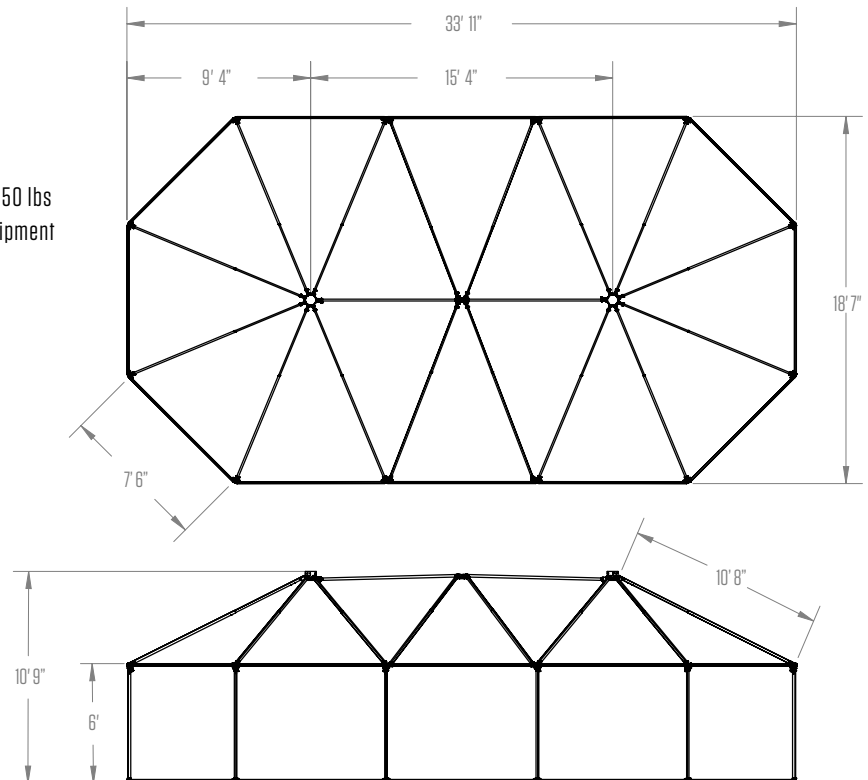

# 1935 SHELTER SYSTEM

Part Number SW-1935BC

A Tactical Shelter For Up To 20 Personnel



## SW-1935BC Specifications NSN Pending

<b>Usable Area</b>	18' 7" x 33' 11" (5.7 x 10.4 m)
<b>Total Weight</b>	596 lbs (270 kg)
<b>Environment</b>	-40°F - 120°F (4.4°C to 49°C)
<b>Snow Load</b>	10 lbs / ft <sup>2</sup> for 12 hrs (50 kg / m <sup>2</sup> for 12 hrs)
<b>Wind Load</b>	55 mph w/gusts to 65 mph (89 km/h w/gusts to 105 km / h)
<b>Time Under Canopy</b>	20 min / 4 personnel
<b>Total Set-Up Time</b>	35 min / 4 personnel
<b>Dimensions</b>	
Footprint	18' 7" x 33' 11" (5.7 x 10.4 m)
Sidewall	6' (1.8m)
Peak	10' 10" (3.3m)
Square Footage	570 ft <sup>2</sup> (53m <sup>2</sup> )
Cube	3,420 ft <sup>3</sup> (96.84 m <sup>3</sup> )
<b>Packaged Dimensions</b>	
Roof	21 x 23 x 14" (53 x 58.5 x 35.5 cm)
Door (2)	26 x 3.5 x 72" (66 x 9 x 183 cm)
Wall	28 x 28 x 14" (71 x 71 x 35.5 cm)
Vinyl Floor	23 x 20 x 14" (58.5 x 51 x 35.5 cm)
Frame #1	91 x 16 x 16" (231 x 40.5 x 40.5 cm)
Frame #2	91 x 14 x 16" (231 x 35.5 x 40.5 cm)
<b>Berry Compliant</b>	✓

## Recommended Support Systems

### Shelter Connecting Systems

Increase the footprint of your shelter system with rigid frame connectors and entryways

### Electrical Distribution

Portable power and lighting to sustain your shelter complex

### Climate Control

Air heating, cooling, purifying and dehumidifying

### Water Distribution

Purification, storage, heating and distribution kits

### Hygiene Systems

Field showers and toilet stations

### Storage And Transport

Heavy-duty cases and customizable cargo trailers

### Digital ID

Your logo or name custom printed on roofs and doors for easy identification

### Anchoring Systems

Secure your shelter against high winds

### Shelter Accessories

Beds, work stations, tables, seating and food prep



Shelter billeting featuring Western Shelter bunk beds, air distribution plenum, lighting and wiring harness.



Schedule  
Contract GS03F084CA



# 20 SHELTER SYSTEM

Part Number SW-20BC

A Tactical Shelter For Up To 10 Personnel



ISO 9001:2008 Registered Company



The 20 Shelter system was designed to provide an easily transported, simple to erect, and, most importantly, weather-secure working environment for operations in remote locations. From the arctic

to the tropics, the proven reliability of our designs, material, and construction has consistently exceeded customer expectations in the harshest of conditions.

## Key Features and Benefits

- Rapid deployment without aid of ancillary equipment, set-up anywhere
- Lightweight frame, packaging allows shelter to be moved / stowed by two people
- Vertical 6 ft. sidewalls maximize usable square footage
- Sealable vinyl floor maintains environmentally secure shelter
- Can be configured with roof or walls only for maximum flexibility in deployment
- Interior frame allows access to horizontal support bars capable of holding up to 50 lbs
- Rigid double doors provide a large entryway with ramp, move gurneys, large equipment
- Roof vent caps significantly reduces condensation
- Framework design allows individual replacement of parts
- Flame retardant vinyl is UV resistant for long life, resists mildew and abrasion

## Standard Components

- Aircraft aluminum mainframe assembly
- Berry Compliant fabric
- 14 oz. vinyl wall panels (4)
- 14 oz. vinyl roof panel
- 18 oz. sealable vinyl floor
- 46" double door with door ramp (1)
- Roof vent cap (1)
- High-wind tie down kit
- Expansion wall strips
- Vinyl repair kit
- Vinyl storage/transport bags

## Shelter Dimensions

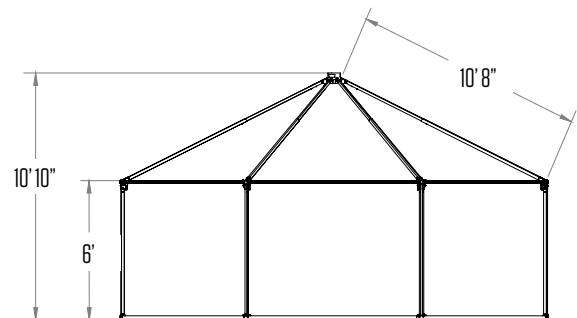
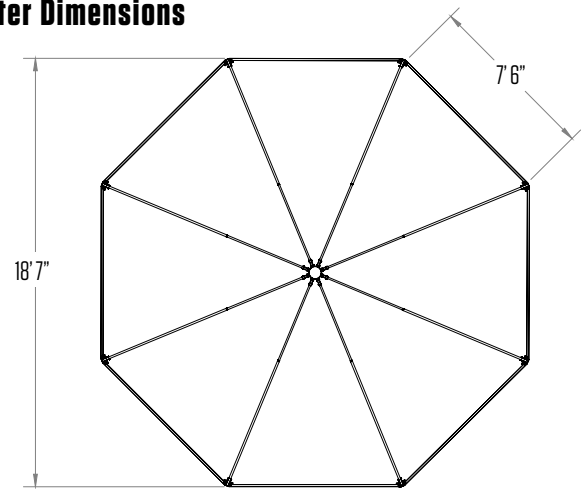

# 20 SHELTER SYSTEM

Part Number SW-20BC

A Tactical Shelter For Up To 10 Personnel



## SW-20BC Specifications NSN Pending

<b>Usable Area</b>	18' 7" x 18' 7" (5.7 x 5.7 m)
<b>Total Weight</b>	344 lbs (156 kg)
<b>Environment</b>	-40°F - 120°F (-40°C to 48.9°C)
<b>Snow Load</b>	10 lbs / ft <sup>2</sup> for 12 hrs (50 kg / m <sup>2</sup> for 12 hrs)
<b>Wind Load</b>	55 mph w/gusts to 65 mph (89 km/h w/gusts to 105 km / h)
<b>Time Under Canopy</b>	16 min / 4 personnel
<b>Total Set-Up Time</b>	25 min / 4 personnel
<b>Dimensions</b>	
Footprint	18' 7" x 18' 7" (5.7 x 5.7 m)
Sidewall	6' (1.8 m)
Peak	10' 10" (3.3 m)
Square Footage	286 ft <sup>2</sup> (26.6 m <sup>2</sup> )
Cube	2178 ft <sup>3</sup> (663.9 m <sup>3</sup> )
<b>Packaged Dimensions</b>	
Roof	24 x 20 x 10" (60 x 51 x 25 cm)
Door	26 x 3.5 x 72" (66 x 9 x 183 cm)
Wall	27 x 28 x 12" (69 x 71 x 31 cm)
Vinyl Floor	23 x 20 x 8" (59 x 51 x 20 cm)
Frame	91 x 14 x 16" (231 x 36 x 41 cm)

**Berry Compliant** ✓

## Recommended Support Systems

### Shelter Connecting Systems

Increase the footprint of your shelter system with rigid frame connectors and entryways

### Electrical Distribution

Portable power and lighting to sustain your shelter complex

### Climate Control

Air heating, cooling, purifying and dehumidifying

### Water Distribution

Purification, storage, heating and distribution kits

### Hygiene Systems

Field showers and toilet stations

### Storage And Transport

Heavy-duty cases and customizable cargo trailers

### Digital ID

Your logo or name custom printed on roofs and doors for easy identification

### Anchoring Systems

Secure your shelter against high winds

### Shelter Accessories

Beds, work stations, tables, seating and food prep



20 System shelter featuring SOI equipment set up and ready for use.



Schedule  
Contract GS03F084CA



International  
Organization for  
Standardization

# 2360 SHELTER SYSTEM

Part Number SW-2360BC

Large Scale Operational System



ISO 9001:2008 Registered Company



The 2360 Shelter System is our largest single shelter operational system. This system provides 1,274 square feet of space, and is built to sustain large scale military operations, camp dining, as well as alternative care and hospital accommodations.

This addition to the Western Shelter line can be bought individually or as a pre-packaged system to handle a larger response area. Its easily collapsible package allows for quick and efficient transport by ground or air.

## Key Features and Benefits

- Rapid deployment without aid of ancillary equipment, no tools necessary
- Vertical walls to maximize usable square footage of over 1270 sq. ft
- Sealable vinyl floor maintains environmentally secure shelter
- Can be configured with roof or walls only for maximum flexibility in deployment
- Interior frame allows access to horizontal support bars capable of hanging supplies or equipment up to 50 lbs
- Rigid double doors provide a large entryway with ramp, to allow use of wheel chairs, gurneys and movement of large equipment in and out of shelter
- Roof vent caps significantly reduce condensation
- Assemble and Disassemble in 40 to 60 minutes with a 6 to 8 person crew
- Framework design allows individual replacement of parts
- Flame retardant vinyl allows for safe occupation of shelter
- UV resistant, resists mildew and abrasion for longer life

## Standard Components

- Aircraft aluminum mainframe assembly
- Wiring harness with 16 outlets
- 14 oz. vinyl wall panels (8)
- 14 oz. vinyl roof panel
- 18 oz. sealable vinyl floor
- Double door with door ramp (4)
- Roof vent cap (2)
- High-wind tie down kit - 16 anchor points
- Expansion wall strips
- Vinyl repair kit
- Vinyl storage/transport bags

## Shelter Dimensions

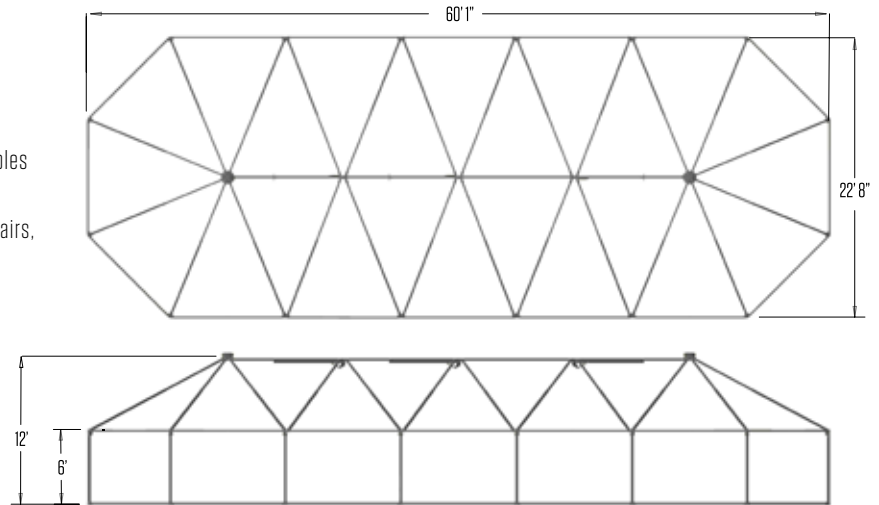



# 2360 SHELTER SYSTEM

Part Number SW-2360BC

Large Scale Operational System



ISO 9001:2008 Registered Company

## SW-2360 Specifications NSN Pending

<b>Usable Area</b>	22' 8" x 60' 1" (5.7 x 10.4 m)
<b>Total Weight</b>	998 lbs (452 kg)
<b>Environment</b>	-20°F to 140°F (-40°C to 60°C)
<b>Snow Load</b>	10 lbs / ft <sup>2</sup> for 12 hrs (50 kg / m <sup>2</sup> for 12 hrs)
<b>Wind Load</b>	55 mph w/gusts to 65 mph (89 km/h w/gusts to 105 km / h)
<b>Time Under Canopy</b>	40 min / 4 personnel
<b>Total Set-Up Time</b>	60 min / 6 personnel
<b>Dimensions</b>	
Footprint	22' 8" x 60' 1" (5.7 x 10.4 m)
Sidewall	6' (1.8m)
Peak	12' (3.6m)
Square Footage	1274 ft <sup>2</sup> (388m <sup>2</sup> )
Cube	7644 ft <sup>3</sup> (216m <sup>3</sup> )
<b>Packaged Dimensions</b>	
Roof	21 x 23 x 14" (53 x 58.5 x 35.5 cm)
Door (2)	26 x 3.5 x 72" (66 x 9 x 183 cm)
Wall	28 x 28 x 14" (71 x 71 x 35.5 cm)
Vinyl Floor	23 x 20 x 14" (58.5 x 51 x 35.5 cm)
Frame #1	91 x 91 x 16" (231 x 231 x 40.5 cm)
Frame #2	91 x 14 x 16" (231 x 35.5 x 40.5 cm)
<b>Berry Compliant</b>	✓

## Recommended Support Systems

### Shelter Connecting Systems

Increase the footprint of your shelter system with rigid frame connectors and entryways

### Electrical Distribution

Portable power and lighting to sustain your shelter complex

### Climate Control

Air heating, cooling, purifying and dehumidifying

### Water Distribution

Purification, storage, heating and distribution kits

### Hygiene Systems

Field showers and toilet stations

### Storage And Transport

Heavy-duty cases and customizable cargo trailers

### Digital ID

Your logo or name custom printed on roofs and doors for easy identification

### Anchoring Systems

Secure your shelter against high winds

### Shelter Accessories

Beds, work stations, tables, seating and food prep



Schedule  
Contract GS03F084CA



International  
Organization for  
Standardization

# GUARDIAN 20 SHELTER SYSTEM

Part Number SG-20

Rapidly Deployable Shelter For Up To 10 Personnel

**WESTERN  
SHELTER** SYSTEMS

ISO 9001:2008 Registered Company



## Fast and Rugged

The Guardian 20 Shelter builds upon the proven Western Shelter octagonal frame with some serious design upgrades. The result: a shelter that gets you out of the weather in less than three minutes, but is also robust enough to offer protection for decades of use and countless deployment cycles.

Built around a single piece frame, the Guardian 20 simplifies logistics by limiting the number of parts that could be lost or broken. Similarly, the cover set and insulation only require two packages, with the roof, walls, and roof insulation in one, and the floor and wall insulation in the other.

## Key Features and Benefits

- Rapidly deploys with only four people and no additional tools or equipment
- Single piece frame expedites deployment and simplifies logistics
- 6.5 foot vertical sidewalls maximize square footage and expedite ingress and egress
- Blackout vinyl cover set allows for zero light emittance
- Single piece roof and wall design results in superior water resistance
- Combined vinyl floor and wall insulation simplifies setup
- Permanently attached roof vent significantly reduces condensation
- Framework design allows for individual replacement of parts
- Optional integrated cable management system
- Shelter can be configured with one to four doors

## Standard Components

- Aircraft aluminum mainframe assembly
- 14 oz. exterior vinyl cover set with attached vent roof cap
- 18 oz. vinyl floor plus wall insulation set
- Zippered doors (2 standard, up to 4 doors)
- Windows with replaceable screens and clear vinyl (2)
- High-wind tie down kit
- Duct openings (4)
- Vinyl repair kit
- Vinyl storage/transport bags

## Shelter Dimensions

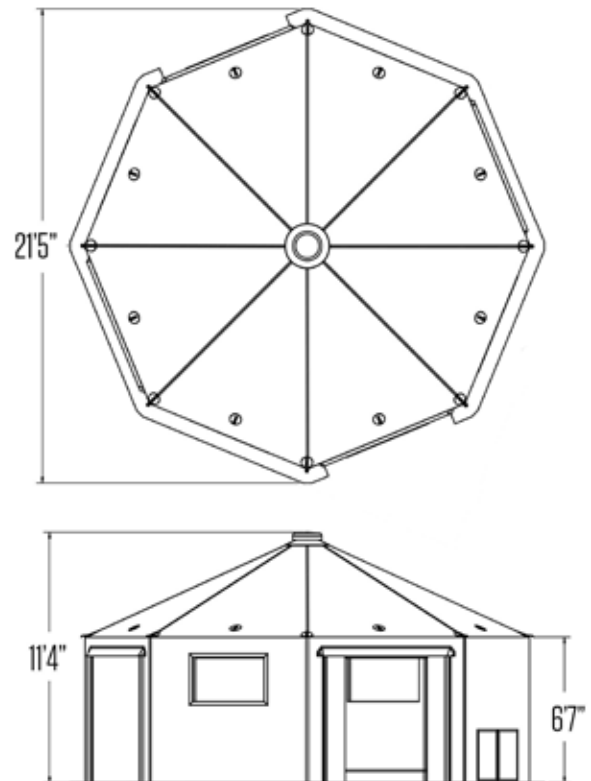

# GUARDIAN 20 SHELTER SYSTEM

Part Number SG-20

Rapidly Deployable Shelter For Up To 10 Personnel



ISO 9001:2008 Registered Company

## SG-20 Specifications NSN Pending

<b>Usable Area</b>	18' 7" x 18' 7"	(5.7 x 5.7 m)
<b>Total Weight</b>	425 lbs	(193 kg)
<b>Environment</b>	-40°F - 120°F	(4.4°C to 49°C)
<b>Time Under Canopy</b>	3 min / 4 personnel	
<b>Total Set-Up Time</b>	15 min / 4 personnel	
<b>Dimensions</b>		
Footprint	21'5" x 21'5"	(6.5 x 6.5 m)
Sidewall	6' 7"	(2.0 m)
Peak	11' 3"	(3.4 m)
Square Footage	286 ft <sup>2</sup>	(27 m <sup>2</sup> )
Cube	2,177 ft <sup>3</sup>	(62 m <sup>3</sup> )
<b>Packaged Dimensions</b>		
Frame	17.25 x 17.25 x 105.25"	(0.43 x 0.43 x 2.67 m)
Exterior Vinyl/Roof Insulation	38 x 28 x 18.05"	(0.9 x 0.9 x 0.45 m)
Floor/Wall Insulation	28 x 24 x 12"	(0.7 x 0.6 x 0.3 m)
<b>Weights</b>		
Frame	225 lbs	102 kg
Exterior Vinyl/Roof Insulation	125 lbs	57 kg
Floor/Wall Insulation	75 lbs	34 kg

## Recommended Support Systems

### Electrical Distribution

Portable power and lighting to sustain your shelter complex

### Climate Control

Air heating, cooling, purifying and dehumidifying

### Water Distribution

Purification, storage, heating and distribution kits

### Hygiene Systems

Field showers and toilet stations

### Storage And Transport

Heavy-duty cases and customizable cargo trailers

### Digital ID

Your logo or name custom printed on roofs and doors for easy identification

### Anchoring Systems

Secure your shelter against high winds

### Shelter Accessories

Beds, work stations, tables, seating and food prep

## Only 3 Pieces Make Up the Guardian 20 Shelter

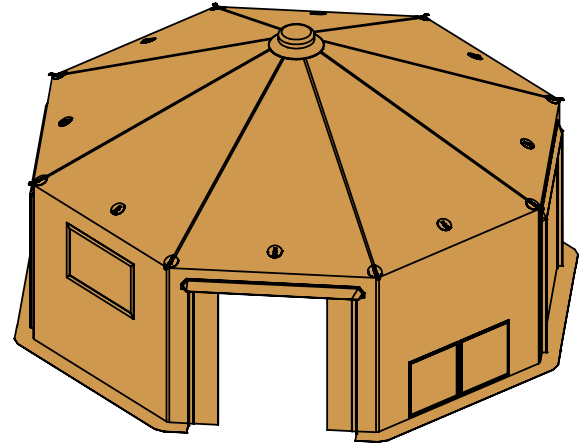

Vinyl Roof + Walls + Roof Insulation + Vent Cap

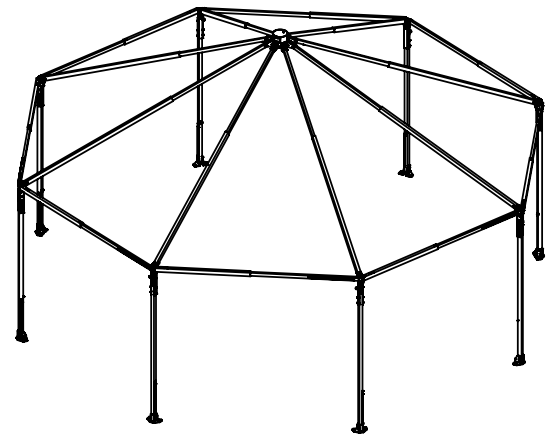

One Piece Aluminum Frame

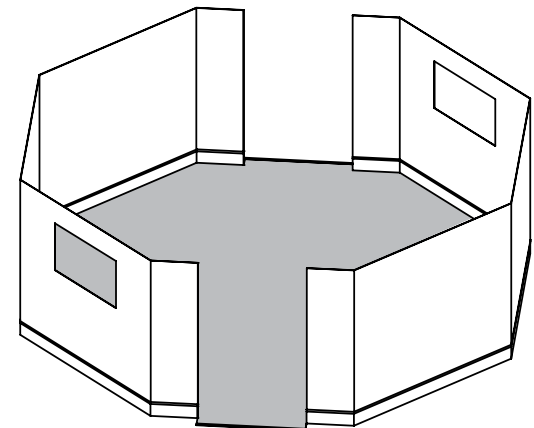

Vinyl Floor + Wall Insulation



Schedule  
Contract GS03F084CA



International  
Organization for  
Standardization

# SENTINEL I

Part Number SW-SI  
Rapid Response Inflatable Shelter



ISO 9001:2008 Registered Company



This lightweight Sentinel shelter can be fully erected by one person in under 5 minutes. Its standard internal inflator allows for rapid inflation without the use of additional pumps or hoses. The speedy set up of this

durable inflatable makes it the perfect fit for rapid response scenarios. It features a removable floor, integrated LED lighting, and the modular design can be connected to multiple shelters.

## Key Features and Benefits

- Can be deployed by 1-2 people in less than 5 minutes
- Removable vinyl floor maintains environmentally secure shelter and gives each unit more flexibility when used in the line of duty
- Roof vent caps significantly reduces condensation
- Framework design allows individual replacement of parts
- Flame retardant vinyl is UV resistant for long life, resists mildew and abrasion
- Integrated LED lighting

## Standard Components

- Plug In & Go internal inflation system (Built into shelter frame)
- Pre-fitted docking zippers around doors
- Heavy-duty non-slip PVC coated removable floor
- Integrated LED lighting

## Optional Equipment

- 4 windows, 3-way system
- 4 duct openings for HVAC unit entry
- Modular inflatable frame with double inflation deflation valves
- Expansion wall strips
- Vinyl repair kit
- Vinyl storage/transport bags
- Inflation adapter with compressed air

# SENTINEL I

Part Number SW-SI

Rapid Response Inflatable Shelter

## SW-SI Specifications NSN Pending

Part Number	Sentinel I <b>SW-SI3W</b> (white) <b>SW-SI3O</b> (orange)	Sentinel I-W <b>SW-SIW3W</b> (white) <b>SW-SIW3O</b> (orange)
-------------	---	---

### Dimensions

Dimensions	Sentinel I 15'1" x 13'1" (4.5 x 4 m)	Sentinel I-W 15'1" x 19'4" (4.5 x 5.9 m)
Footprint	15'1" x 13'1" (4.5 x 4 m)	15'1" x 19'4" (4.5 x 5.9 m)
Peak	9'2"	9'2"
Square Footage	172 ft <sup>2</sup> (16 m <sup>2</sup> )	258 ft <sup>2</sup> (24 m <sup>2</sup> )

### Packaged Dimensions

Tent	35 x 32 x 24" (89 x 82 x 61 cm)	43 x 32 x 24" (109 x 82 x 61 cm)
Stakes	Included	Included
Repair kit	Included	Included
Electrical inflator	Included « Plug in & go system »	Included « Plug in & go system »
Total Weight	156 lbs (70 kg)	172 lbs (78 kg)
Setup Time	3 min	4 min



Flame resistant, polyester fabric cover with removable floor and pre-fitted guy lines.

## Recommended Support Systems

### Shelter Connecting Systems

Increase the footprint of your shelter system with rigid frame connectors and entryways

### Electrical Distribution

Portable power and lighting to sustain your shelter complex

### Climate Control

Air heating, cooling, purifying and dehumidifying

### Water Distribution

Purification, storage, heating and distribution kits

### Hygiene Systems

Field showers and toilet stations

### Storage And Transport

Heavy-duty cases and customizable cargo trailers

### Digital ID

Your logo or name custom printed on roofs and doors for easy identification

### Anchoring Systems

Secure your shelter against high winds

### Shelter Accessories

Beds, work stations, tables, seating and food prep

# SENTINEL II SHELTER SYSTEM

Part Number SW-SII

An Inflatable Shelter For Up To 10 Personnel



ISO 9001:2008 Registered Company



Ready for use in under 6 minutes and available in five different sizes, the Sentinel II's ease of deployment makes it an ideal, all purpose emergency shelter when speed is crucial. Quick to deploy and to

strike, these shelters offer a short term solution to most mission needs. Its light weight, modular form allows it to easily connect with other shelter's in any direction.

## Key Features and Benefits

- Speed and ease of deployment—ready for use in under 6 minutes.
- All-weather inflator and hose kit
- Modular design allows shelters to connect in any direction
- Sealable vinyl floor maintains environmentally secure shelter
- Available in sizes ranging from 312 ft<sup>2</sup> to 840 ft<sup>2</sup>.
- Wind load 55 mph with gusts to 65 mph.
- Color options include white, orange, desert sand and dark green

## Standard Components

- Electric inflator
- Flooring
- Pre-fitted docking zippers around doors

## Shelter Dimensions

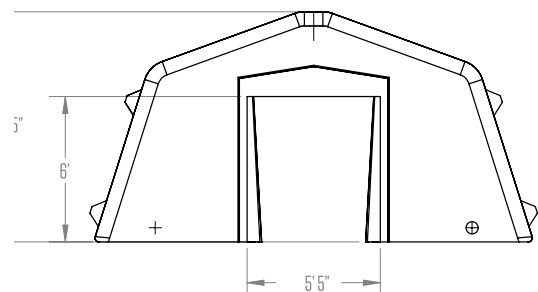
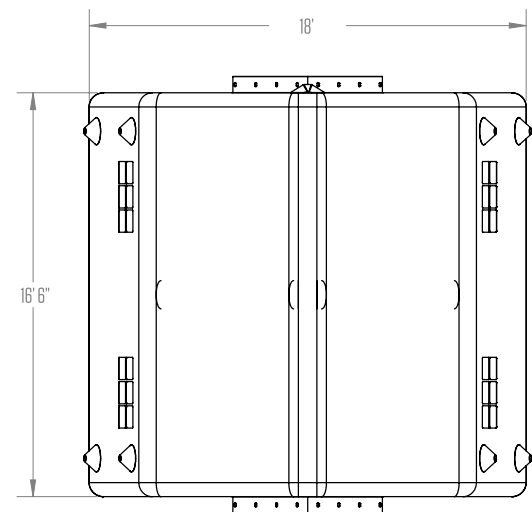

# SENTINEL II SHELTER SYSTEM

Part Number SW-SII

An Inflatable Shelter For Up To 10 Personnel



## Specifications NSN Pending

Part Number	Sentinel II-3	Sentinel II-4	Sentinel II-5	Sentinel II-6
	SW-SII3W (white)	SW-SII4W (white)	SW-SII5W (white)	SW-SII6W (white)
	SW-SII3G (green)	SW-SII4G (green)	SW-SII5G (green)	SW-SII6G (green)
	SW-II3S (sand)	SW-II4S (sand)	SW-II5S (sand)	SW-II6S (sand)
	SW-II3O (orange)	SW-II4O (orange)	SW-II5O (orange)	SW-II6O (orange)
<b>Setup Time</b>	4 min	5 min	6 min	6 min
<b>Dimensions</b>				
Footprint	16'11" x 18'4" (5.2 x 5.8 m)	24'9" x 18'4" (7.4 x 5.8 m)	32'8" x 18'4" (10 x 5.8 m)	40'6" x 20'8" (12.4 x 5.8 m)
Arches	3	4	5	6
Peak	9'2"	9'2"	9'2"	10'2"
Square Footage	312 ft <sup>2</sup> (95 m <sup>2</sup> )	452 ft <sup>2</sup> (137.8 m <sup>2</sup> )	603 ft <sup>2</sup> (183.8 m <sup>2</sup> )	840 ft <sup>2</sup> (256 m <sup>2</sup> )
Total Weight	431 lbs (195.5 kg)	536 lbs (243.2 kg)	640 lbs (290.3 kg)	604 lbs (274 kg)
<b>Packaged Dimensions</b>				
Tent	47" x 39" x 26" (1.2 x 1 x 0.7 m)	51" x 39" x 28" (1.3 x 1 x 0.7 m)	55" x 39" x 30" (1.4 x 1 x 0.8 m)	59" x 39" x 35" (1.5 x 1 x 0.9 m)
Tents per 20' Container	15	15	12	12
Poles	16" x 16" x 43" (0.4 x 0.4 x 1.1 m)			
Pegs and Hammer	16" x 16" x 24" (0.4 x 0.4 x 0.6 m)			
Electric Inflator	24" x 24" x 43" (0.6 x 0.6 x 1.1 m)			
<b>Environment</b>				
Wind Load	-20°F to 135°F (-29°C to 57°C)			
	55 mph w/gusts to 65 mph (89 km/h w/gusts to 105 km/h)			

## Recommended Support Systems

### Shelter Connecting Systems

Increase the footprint of your shelter system with rigid frame connectors and entryways

### Electrical Distribution

Portable power and lighting to sustain your shelter complex

### Climate Control

Air heating, cooling, purifying and dehumidifying

### Water Distribution

Purification, storage, heating and distribution kits

### Hygiene Systems

Field showers and toilet stations

### Storage And Transport

Heavy-duty cases and customizable cargo trailers

### Digital ID

Your logo or name custom printed on roofs and doors for easy identification

### Anchoring Systems

Secure your shelter against high winds

### Shelter Accessories

Beds, work stations, tables, seating and food prep



Schedule  
Contract GS03F084CA



International  
Organization for  
Standardization

# RUGGEDIZED POP-UP

Part Number SP-1010 | SP-1015 | SP-1020

Portable and Durable Tent



ISO 9001:2008 Registered Company



The Ruggedized Pop-Up series compliments the standard Western Shelter product line in scenarios where a smaller footprint is required. These are not your average big box store pop-ups, our Ruggedized Pop-Up shelters are built for the demands of repeated use. This shelter is seriously tough, with anodized hexagonal aluminum legs, and a unique level frame structure that adds strength but not weight versus a traditional pyramid frame design. The cover set is equally durable, with 600 denier polyester, or vinyl options. The Ruggedized Pop-Up also comes in three sizes, and two duty grades to meet your budget and use case needs.

## Key Features and Benefits

- Commercial anodized aluminum for lightweight strength and durability
- Compact package for effortless transportation and portability
- Superb visual smooth aluminum finishing for professional presentation
- 600 denier polyester offers black-out capability
- Optional wall panels attach easily with hook and loop
- Zipper wall closure for easy access
- Available in a variety of colors

Standard Duty Shelter	Part Number	Wall Panel Option	Color Options*	Vinyl Cover Option**
10' x 10' Shelter Includes Frame, Roof, Dust Cover	SP-1010	4 each PA-SPWP10	BK, WT, GR, FG, NB, RB, RD, OR, YL, BG	V
10' x 15' Shelter Includes Frame, Roof, Dust Cover	SP-1015	2 each PA-SPWP10 + 2 each PA-SPWP15	BK, WT, GR, FG, NB, RB, RD, OR, YL, BG	V
10' x 20' Shelter Includes Frame, Roof, Dust Cover	SP-1020	6 each PA-SPWP10	BK, WT, GR, FG, NB, RB, RD, OR, YL, BG	V
Heavy-Duty Frame Shelter				
10' x 10' Shelter Includes Frame, Roof, Dust Cover	SP-1010HD	4 each PA-SPWP10	BK, WT, GR, FG, NB, RB, RD, OR, YL, BG	
10' x 15' Shelter Includes Frame, Roof, Dust Cover	SP-1015HD	2 each SP-1015 + 2 each SP1015	BK, WT, GR, FG, NB, RB, RD, OR, YL, BG	
10' x 20' Shelter Includes Frame, Roof, Dust Cover	SP-1020HD	6 each SP-1020	BK, WT, GR, FG, NB, RB, RD, OR, YL, BG	
Individual Wall Panels				
10' Wall Panel	PA-SPWP10		BK, WT, GR, FG, NB, RB, RD, OR, YL, BG	V
15' Wall Panel	PA-SPWP15		BK, WT, GR, FG, NB, RB, RD, OR, YL, BG	V
Wall Panel Options				
Window	WN (Add to end of panel part #)			
Door	DO (Add to end of panel part #)			

\*Add 2 letter color code to end of shelter part#. BLACK-BK, WHITE-WT, GREEN-GR, FOREST GREEN-FG, NAVY BLUE-NB, ROYAL BLUE-RB, RED-RD, ORANGE-OR, YELLOW-YL, BEIGE-BG

\*\*Add V to end of part # if vinyl is the desired cover material



# RUGGEDIZED POP-UP

Part Number SO-HWTDSK4 | SO-HWTDSB4 | SO-HWTDSRB4 | SO-HWTDSHD4  
Stake Down Options

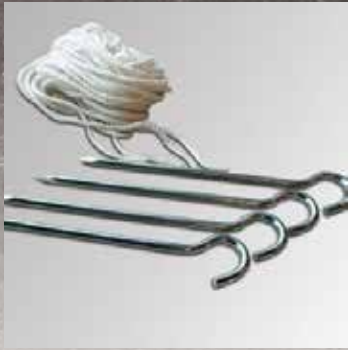

SO-HWTDSK4



SO-HWTDSB4



SO-HWTDSRB4



SO-HWTDSHD4

Part Number	Dimensions
SO-HWTDSB4	High-wind tie-down Sand Bag Kit for SP-1010, SP-1015, SP-1020. Set of 4
SO-HWTDSK4	High-wind tie-down Stake Kit for SP-1010, SP-1015, SP-1020. Set of 4
SO-HWTDSHD4	High-wind tie-down Heavy Wind tie down assembly. Includes 3/8" rope with ratchet assembly. Sold as individual rope/ratchet set.
SO-HWTDSRB4	High-wind tie-down 30lbs Rubber Weight. Sold as individual weight

## Standard Duty Shelter Details

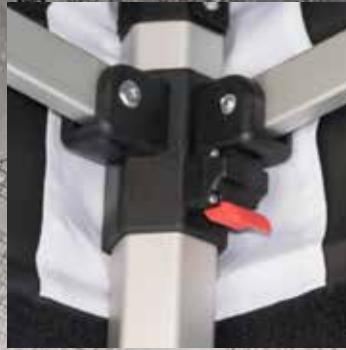

High Quality ABS Fittings For Frame Support



Crank Up Technology Adjusts Peak Tension



Reinforced Truss Bars For Stability

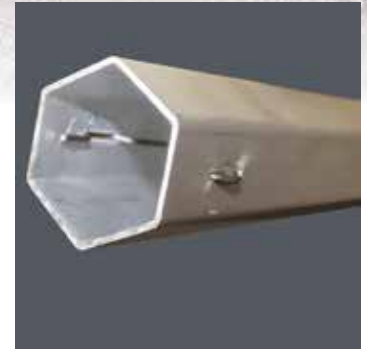

45 mm Hexagonal Legs For Frame Durability

## Heavy Duty Shelter Details



50mm Hexagonal Legs



Fiberglass Fittings



Oversized Triangle Footplates



Reinforced Oval Truss Bars



Schedule  
Contract GS03F084CA



International  
Organization for  
Standardization

# MHCS SHELTER SYSTEM

Part Number SK-MHCSM

A Container-Based Shelter System For Up To 20 Personnel



ISO 9001:2008 Registered Company



A rapidly-deploying, self-sustaining shelter system providing full living capability for small expeditionary forces. Utilities include showering, toilet systems, water containment and distribution, HVAC capacity, independent

energy generation, energy-efficient lighting, and interoperability with existing 20, 1935, and 2360 Western Shelter structures.

## Key Features and Benefits

- Reduces pallet position/weight
- ISO Certified for Air, Land, or Sea Transport
- Air Lift Transportable (C-130 and larger military/civilian cargo aircraft)
- Helicopter Sling Certifiable: 4 Way Forkliftable Internal Airlift/Helicopter Slingable Container
- Deployment can be completed without the use of ladders or tools by a six-person crew in under 2 hours
- Support packages for general use, billeting, command and control, medical applications
- Provides complete 20-person camp in one ISU-90 container
- Over 755 sq. ft of usable space in 55 sq. ft package
- Fully insulated for use in any environmental condition
- Expandable - Add shelter systems to increase your footprint
- Container converts to separate areas capable of direct connection to shelters

## Standard Components (Basic System)

- ISU-90 Container
- SW1935-BC Shelter (Berry Compliant)
- Entryway (Berry Compliant)
- Vestibule (Berry Compliant)
- 120V Inlet With 12V Converter And LED Red/White Lights
- Shelving System
- Armor Coated Floor
- Man Door Pass Through Cut Out

## Container Systems

- General Purpose
- Billeting
- Command and Control
- Medical

## Shelter Dimensions

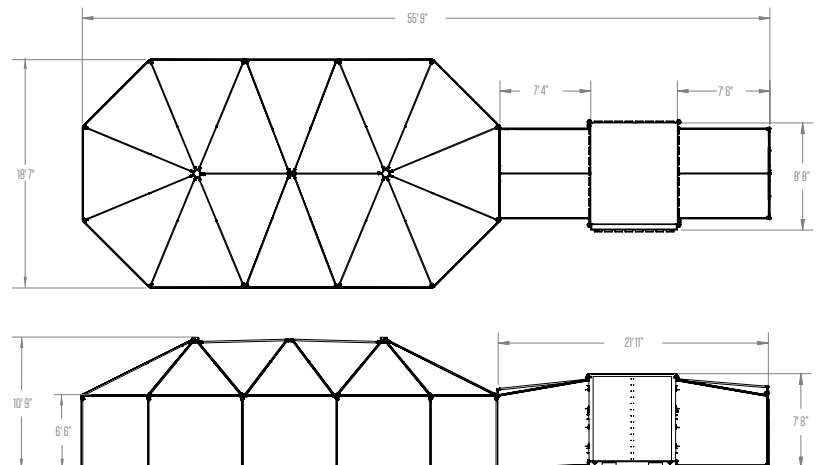

# MHCSM SHELTER SYSTEM

Part Number SK-MHCSM

A Container-Based Shelter For Up To 20 Personnel



ISO 9001:2008 Registered Company

## SK-MHCSM Specifications

<b>Footprint Transport</b>	108 x 88 x 90" (274 x 223 x 229 cm)
<b>Usable Area</b>	755 ft <sup>2</sup> (70.2m <sup>2</sup> )
<b>Total Weight</b>	5900 lbs (2676 kg)
<b>Environment</b>	-40°F to 120°F (4.4°C to 49°C)
<b>Snow Load</b>	10 lbs / ft <sup>2</sup> for 12 hrs (50 kg / m <sup>2</sup> for 12 hrs)
<b>Wind Load</b>	55 mph w/gusts to 65 mph (89 km/h w/gusts to 105 km/h)
<b>Operational Temp</b>	-60 to 120°F (-51 to 49°C)
<b>Total Set-Up Time</b>	2 hours / 6 personnel

Dimensions		
GK1935 Berry Compliant shelter	570 ft <sup>2</sup>	(52.95 m <sup>2</sup> )
Berry Compliant vestibule connector	65 ft <sup>2</sup>	(6 m <sup>2</sup> )
Berry Compliant vestibule entryway	65 ft <sup>2</sup>	(6 m <sup>2</sup> )
ISU-90 Container w/double doors both sides	55 ft <sup>2</sup>	(5.1 m <sup>2</sup> )

Container Electrical System	
230 V L6-30 receptacle for water heater (Billeting and Medical only)	
120 V NEMA 15-5 receptacles for LED lighting and exhaust fan	
12 V converter	

Shelter Electrical System	
15 KW diesel generator ultra quiet	
50 Amp electrical distribution panel	
Wiring harness w/12 duplex receptacles	
3.5 ton HVAC w/integrated thermostat and ducting	

Container Plumbing System*	
Fittings: 3/4" garden hose thread fittings	
Tank less hot water heater rated at 4 GPM	
Integrated 12 V pumping systems	

\* Billeting and Medical Systems

## SK-MHCSM Packages (Container Only)

### SK-MHCSM Basic

- ISU90
- SW-1935BC Shelter (Berry Compliant)
- Entryway (Berry Compliant)
- Vestibule Connector (Berry Compliant)
- 120 V inlet w/12 volt converter and LED Red/White Lights
- Shelving System
- Armor Coated Floor
- Man Door Cut Out

### SK-MHCSM-B Billeting

- Basic Configuration (SK-MHCSM)
- 10 Bunk Beds (Berry Compliant)
- Shower System with Water Handling Kit (Berry Compliant)
- Toilet System with Brief Relief Product (Berry Compliant)
- 15K Generator
- HVAC

### SK-MHCSM-C Command

- Basic Configuration (SK-MHCSM)
- AV-S025SD72 Dual Display
- 5 Tables
- 8 Chairs
- 15K Generator
- HVAC

### SK-MHCSM-M Medical

- Basic Configuration (SK-MHCSM)
- 5 Medical Organizer Bags
- 10 Medical Cots
- Shower System w/Water Handling Kit (Berry Compliant)
- Toilet System with Brief Relief Product (Berry Compliant)
- 15K Generator
- HVAC

### SK-MHCSM-G General Purpose

- Basic Configuration (SK-MHCSM)
- 15K Generator
- HVAC

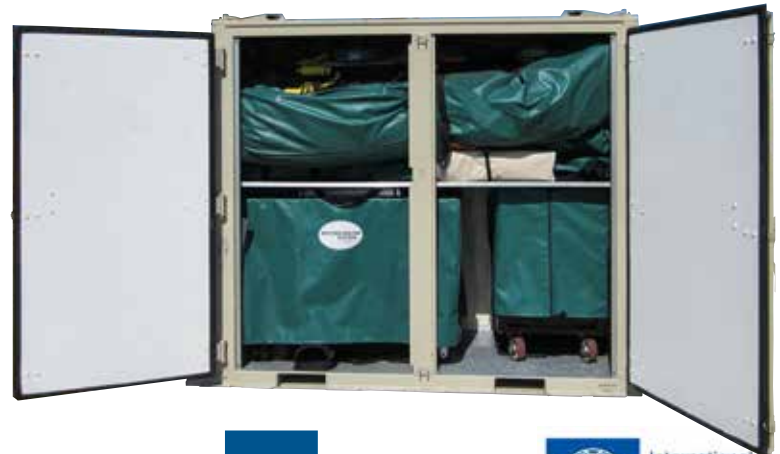

Schedule  
Contract GS03F084CA



International  
Organization for  
Standardization

# MOBILE RESPONSE TRAILER SYSTEM

Part Number TR-TRMRTS

Command Center BoD With Billeting For 24 Responders



ISO 9001:2008 Registered Company



The MRTS is a mobile trailer system specifically created to meet the ever changing demands of emergency response. The function of this package is to provide a full functional First Response Mobile Field Hospital, utilizing Gatekeeper shelter kits and specified 53' support trailer system.

The trailer can be converted into a multi-functional command center or billeting and storage. The trailer is capable of billeting 24 plus persons utilizing the Western Shelter bunk bed.

## Key Features and Benefits

- 3,826 ft<sup>2</sup> turn-key system comes completely contained within a 53 ft trailer
- Front 12' command center includes 42" touch screen monitor, built-in appliances and dry erase board walls, cabinets and computer floor
- Security cameras in all four corners of trailer with command center monitor and DVD
- Onboard mounted 100kW genset and shore power cam-loc cords for 350 amp power supply
- Two 5 ton HVAC units with air supply ducts provide heating and cooling, T-grid ceiling with HVAC supply ducts
- Two 36" insulated outward doors with retractable locking aluminum platforms allow for full door movement
- Each platform is secured with stainless steel railings stored in the belly boxes of the trailer
- Additional 36" door on rear of trailer for easy access
- Lift gate system designed to provide safe and smooth loading and off loading, operated with remote control and floor foot pedals.
- 64 ft<sup>2</sup> observation deck with folding ladder access
- Two 16' awnings installed over the entry doors with an additional 8' awning installed over the lift gate provide shelter from the elements

## Standard Components

- 53' Trailer
- Manual leveling system
- 5 Ton HVAC (2)
- 100kW genset
- 42" touch screen monitor
- 4 Security cameras and command center monitor
- 12 Bunk beds

## TR-TRMETTS Dimension

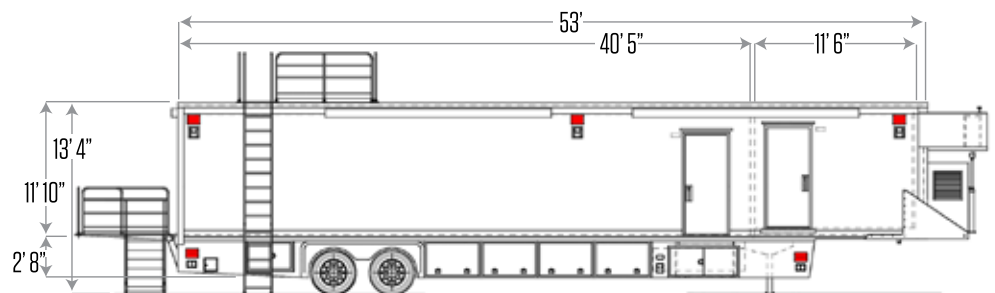

# MOBILE RESPONSE TRAILER SYSTEM

Part Number TR-TRMRTS

Command Center BoD With Billeting For 24 Responders



## TR-TRMERTS Specifications

<b>Usable Area</b>	3,826 ft <sup>2</sup>	(355.4 m <sup>2</sup> )
<b>Dry Weight</b>	36,000 lbs	(16,329 kg)
<b>Full Weight</b>	50,000 lbs	(22,679 kg)
<b>Capacity</b>	65,000 GVWR	
<b>Dimensions (Trailer Body Less Gen Set)</b>		
Exterior	53' x 8'5" x 13'6"	(16 x 2.4 x 4.1 m)
Interior	52'6" x 8'3" x 9'2"	(16 x 2.5 x 2.8 m)
<b>Command and Control Room</b>		
Dimensions	10'6" x 8'3"	(3.2 x 2.5 m)
GFI electrical outlets (20)		
L shaped desk	8' x 8' x 24"	(2.4 x 2.4 x 0.6 m)
Cabinets	2 adj. shelves	18 x 16" (0.45 x 0.4 m)
LCD Monitor	42" flat screen, wireless board, video terminal, touch screen	
<b>Floor</b>	1.3750" Laminated Wood Floor	
<b>Electrical</b>		
AC Main Panel	1-Main 200A, 3-Phase Molded Breaker Box, 120V	
AC Main Transfer Switch	315A, 4-Pole/3 Position Generator to Shore Power	
12 V Main Panel	15A Illuminated Switches/Marine Grade ATC Fuse Panel	
<b>Shore Power</b>		
Shore Power 1	Exterior 200A 208VAC 3 Phase	10' Pigtail Cable
Shore Power 2	Exterior Isolated 20A-120V	Motor-Based
<b>Interior Lighting</b>		
32 Watt U-tube	2 X 2' Fluorescent Fixtures Recessed (10)	
40 Watt red incandescent light recessed mounted in suspended ceiling grid (10)		
Battery Backup Emergency Light Mounted at Exits (2)		
12V Lights mounted in suspended ceiling grid (6)		
<b>Exterior Lighting</b> Operated at 12V Main Panel		
Trailer Running Lights		
12V 50W Halogen Load/Operating Lights	6 per side/3 upper, 3 lower	
12V Generator Pedestal Mounted Operating Light		
Entry Door Lights	3 - 12V Amber	1 per Door
12V Generator pedestal mounted operating light		

Portable scene lights	110V/1000W removable tripod lights (2)	
110V/500W load lights rear (2)		
Red super LED emergency lights (5 per side)		
Yellow super LED emergency lights (2)		
<b>ECU/HVAC</b>		
2 A/C Units, upper deck	42,000 BTU 11 kW Electric Heat Strip	
Concealed and Balance Ducting to Distribute Airflow		
Electronic Thermostat with Digital Readout		
HVAC Operates on either Generator or Shoreline Power		
<b>Diesel Generator</b>		
100 kW mounted on front exterior wall		
Thermostat Regulated Block Heater		
200 Gal Fuel Storage Outside Trailer Body	12V Fuel Gauge	
<b>Curbside Doors</b>		
36" Insulated Outward Swing Door With Locking Hardware (2)	(0.9 m)	
Recessed, Retractable Non-Skid aluminum Platform Beneath Door		
Detachable Aluminum Non-Skid Stairs		
Stainless Steel Stair Railings		
<b>Rear Doors</b>	3' x 6'8"	(0.9 x 2 m)
<b>Life Gate/Platform</b>		
Payload rating of 5,500 lbs	(2,494 kg)	
7,800 in <sup>2</sup> usable area	(5 m <sup>2</sup> )	
5000 lb Capacity Lift (2267.9 kg)	Stainless Steel Side Rails and Stairs	
4' Roll Up Door, Push Button Control (1.2 m)	5' Auto Awning (1.5 m)	
<b>Awnings</b> electric	(2) 16' and (1) 8'	(2) 4.8m and (1) 2.4 m
<b>Under Belly Boxes</b> Full Width Storage Compartments (4)		
36" x 31" (0.9 x 0.7 m)	Slide Out, 1000 lb Rating (453.5 kg)	
39" x 24" x 36" (0.9 x 0.6 x 0.9 m)	(Storage Compartments (2) Swing Doors	
<b>Electrical Outlets</b> GFCI Protected		
<b>Interior Shelving</b> Anodized aluminum	Supports (40) 24 x 20 x 20" bins	
<b>Observation Platform</b> diamond plated Removable Ladder		
Dimensions	8 x 8'	(2.4 x 2.4m)



Schedule  
Contract GS03F084CA



# MOBILE TRAUMA TRAILER SYSTEM

Part Number TR-TRMETTS

Quick Response 8 - 10 Bed Trauma Trailer with Operating Room



ISO 9001:2008 Registered Company



The METTS is a cutting edge trauma trailer that provides hardened trauma, OR and ER capabilities in a clean and sterile environment. Fully contained in a 53' trailer, the system is equipped with seven patient rooms with privacy curtains, designated operating room, lab area, nurse's station, rest room and a pre-plumbed oxygen and central vacuum system. The patient treatment beds include a storage compartment

for medical supplies and tools while the unique design allows each bed to be quickly removed in order to provide areas for gurneys during an emergency.

## Key Features and Benefits

- Three 44' deep expansions expand the footprint of the 53' trailer for a usable 630 ft<sup>2</sup>
- Operating room with patient monitoring and procedure table
- Rear 4' wide roll-up door for easy patient entry
- Seven patient bed each with oxygen, medical air and vacuum, in addition to overhead storage cabinets and privacy curtains. Fully adjustable from lying to seated position
- Centrally located staff workstation/intake area
- Lab area with storage cabinets
- Transform treatment bed to nurse station by utilizing wall-mounted workstation
- Medical gas monitoring system, control panels on interior rear wall for convenience
- Staff washroom and surgical scrub area
- On-board fresh water, waste and diesel fuel tanks
- Pre-cabled for data/phone and terminals
- Rear lift gate doubles as an entry platform
- 64 ft<sup>2</sup> observation deck with folding ladder access
- On board diesel generator with 200 gal fuel tank and 350 amp service output supports additional power needs or backup

## Standard Components

- 53' Trailer With Three Slide-Outs
- Manual Leveling System
- Dual On Board Vacuum Pumps
- Medical Exam Rooms with Furnishings (7)
- Operating Room and Furnishings
- Anesthesia Cart
- Crash Cart
- Staff Restroom
- Lab Area with Foot Controlled Scrub Sink
- 5 Ton Hvac (2)
- Wall Mounted Medical Air, Oxygen And Vacuum (7)



## TR-TRMETTS Dimensions

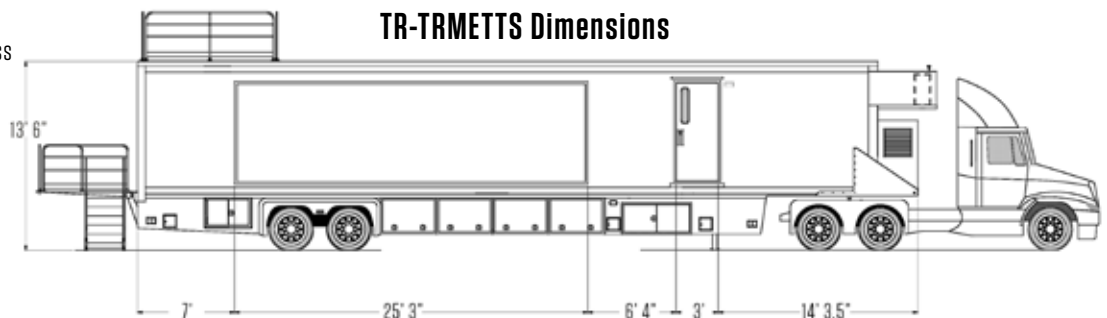

# MOBILE TRAUMA TRAILER SYSTEM

Part Number TR-TRMETTS

Quick Response 8 - 10 Bed Trauma Trailer with Operating Room



## TR-TRMETTS Specifications

<b>Usable Area</b>	630 ft <sup>2</sup> (58.5m <sup>2</sup> )		
<b>Total Weight</b>	65,000 lbs GVWR (29.4 M ton)		
<b>Dimensions (Trailer Body Less Gen Set)</b>			
Exterior	4' x 17' 10" (16 x 2.6 x 4 m)		
Interior	52' 6" x 8' 3" x 9" 2" (16 x 2.5 x 2.9 m)		
Street Side Expansion 1	4' x 17' 10"	(0.9 x 5.4 m)	12 V Hydraulic
Street Side Expansion 2	4' x 11' 11"	(0.9 x 3.6 m)	12 V Hydraulic
Curb Side Expansion	24' x 11"	(7.3 x 0.3 m)	12 V Hydraulic
<b>Floor</b>	1.3750" Laminated Wood Floor/Covered By Raised Computer Floor 2 x 2'		
<b>Electrical</b>			
AC Main Panel	1-Main 200A, 3-Phase Molded Breaker Box, 120V		
AC Main Transfer Switch	315A, 4-Pole/3 Position Generator to Shore Power		
12 V Main Panel	15A Illuminated Switches/Marine Grade ATC Fuse Panel		
<b>Shore Power</b>			
Shore Power 1	Exterior 200A 208VAC 3 Phase	10' Pigtail Cable	
Shore Power 2	Exterior Isolated 20A-120V	Motor-Based	
<b>Interior Lighting</b>			
32 Watt U-tube	2 X 2' Fluorescent Fixtures Recessed (10)		
Surface Mounted Fluorescent Light In Expansions (9)			
Battery Backup Emergency Light Mounted at Exits (2)			
12V Lights mounted in suspended ceiling grid (6)			
<b>Exterior Lighting</b> Operated at 12V Main Panel			
Trailer Running Lights	12V Generator Pedestal Mounted Operating Light		
12V 50W Halogen Load/Operating Lights Recessed in Lower Skirt (2)			
Entry Door Lights	2 - 12V Amber	1 per Door	
<b>ECU/HVAC</b>			
2 A/C Units, upper deck	56,000 BTU 11 kW Electric Heat Strip		
Concealed and Balance Ducting to Distribute Airflow			
Electronic Thermostat with Digital Readout			
HVAC Operates on either Generator or Shoreline Power			
<b>Oxygen, Vacuum/Suction and Compressed Air (10 Stations)</b>			
Medical Oxygen Outlet (2)	Compressed Air Connection		
Vacuum/Suction Connections (2)	H Cylinder Tanks and Rack		

<b>Curbside Doors</b>		
36" Insulated Outward Swing Door With Locking Hardware		
Recessed, Retractable Non-Skid aluminum Platform Beneath Door		
Detachable Aluminum Non-Skid Stairs		
Stainless Steel Stair Railings		
<b>Diesel Generator</b>		
100 kW mounted on front exterior wall		
Thermostat Regulated Block Heater		
200 Gal Fuel Storage Outside Trailer Body	12V Fuel Gauge	
<b>Under Belly Boxes</b>		
36" x 31" Full Width Storage Compartments (4)	Slide Out, 1000 lb Rating	
39" x 24" x 36" Storage Compartments (2)	Swing Doors	
<b>Exam Tables</b>		
Custom Built Exam Table with Storage Space and Table Mounted Lamp (8)		
Custom Built Exam Table/X-Ray Exam Table (1)		
Ritter 230 Powered Procedure Table (1)		
<b>Restroom</b>	Flush toilet with 30 Gal Black Tank	
<b>Electrical Outlets</b>	GFCI Protected	
<b>Plumbing</b>		
Stainless Steel Single Basin Sink (2)		
60 Gal Fresh Water Tank, 12 V Pump	65 Gal Gray Tank	
<b>Exam Room (7)</b>		
Integrated Wall Exam System	Instrument Cart	Retractable Privacy Curtain
<b>Operating Room</b>		
Ritter 230 Powered Procedure Table	Centurion Surgical Light	
Welch Allyn 767 Integrated Wall System	Wolf X-Ray Illuminator	
Space Lab Patient Monitor	Caster leg stool	
Stainless Steel Mayo Stand	Workstation with cabinets	
Walls and Floor with Bio-Guard Finish	HVAC HEPA Filters	
<b>Lab Area</b>		
Double Stainless Steel Scrub Sink (Foot Controls)	Gooseneck Faucet	
So-Lo Medical Refrigerators (2)	Storage Cabinets	
<b>Intake Area</b>		
5000 lb Capacity Lift	Stainless Steel Side Rails and Stairs	
4' Roll Up Door, Push Button Controls	5' Auto Awning	
<b>Observation Platform</b>	8' x 8' diamond plated	Removable Ladder



# PRIMARY CARE VAN



ISO 9001:2008 Registered Company



A self-contained system, this mobile health care facility is perfect for health initiatives that focus on community outreach. The system was built to take health care into rural environments and promote health maintenance. This van system allows for a completely mobile environment with all of the functionality of a stand-alone health clinic.

## Standard Features

- 45' long overall with a 33' box
- Two expansions
- Automatic leveling system
- Wheelchair lift
- Two exam rooms
- Reception/waiting area with 26" TV and DVD
- Full rest room with UA Lab pass-through
- Office/lab area
- On board generator
- Fresh and waste water systems
- 3G mobile internet access

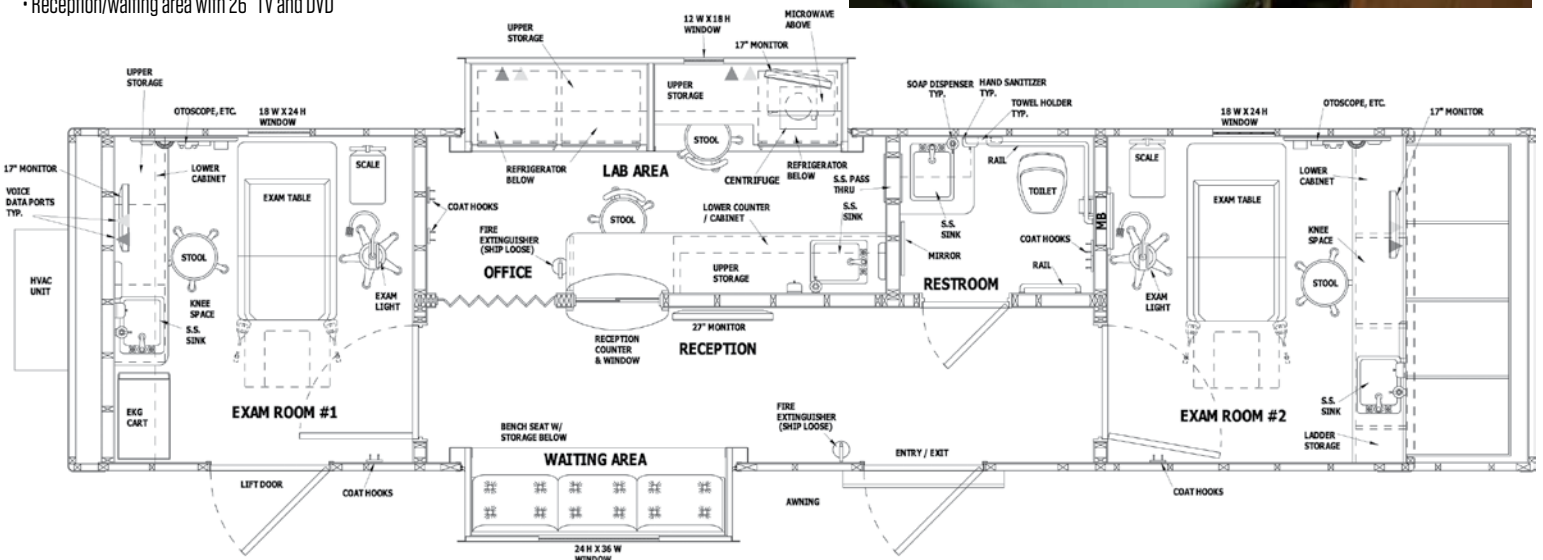

Schedule Contract GS03F084CA



International Organization for Standardization



# MOBILE MAMMOGRAPHY

Self-Propelled and Trailers



ISO 9001:2008 Registered Company



Western Shelter Mobility manufactures mobile mammography units custom built to your specifications. Choose from our existing floor plans or work with our engineering team to provide the solution that's right for you.

All of our vehicles are fully tested and inspected to meet or exceed stringent quality standards established to comply with OEM specifications and regulatory standards. Our team can provide on-site training and start up assistance.

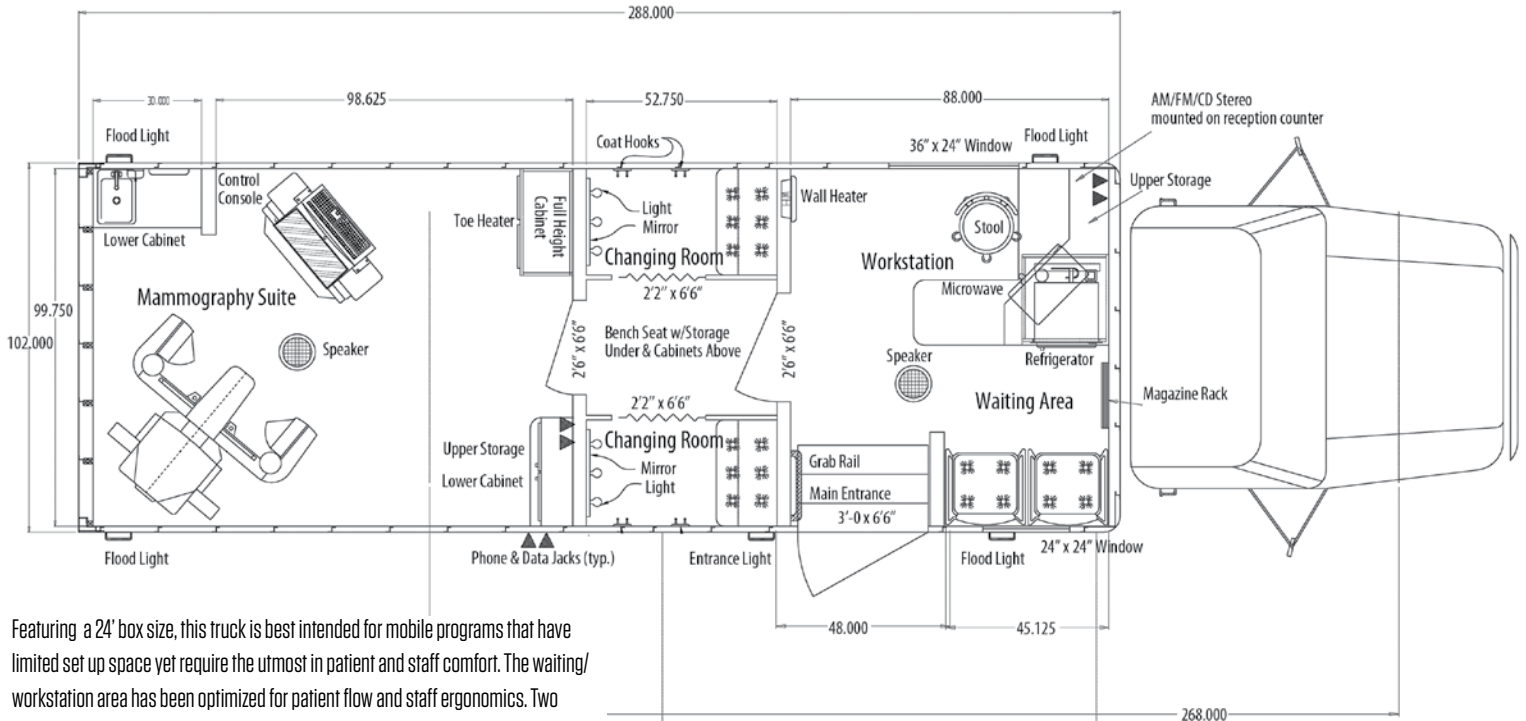

Featuring a 24' box size, this truck is best intended for mobile programs that have limited set up space yet require the utmost in patient and staff comfort. The waiting/workstation area has been optimized for patient flow and staff ergonomics. Two changing rooms allow for the steady flow of patients to the rear mammography suite.



Schedule  
Contract GS03F084CA



International  
Organization for  
Standardization

# Container Based Field Hospital System

Rugged, Flexible, and Rapidly Deployable



ISO 9001:2008 Registered Company



## Western Shelter Field Hospitals

At Western Shelter Systems, field medicine is in our DNA. Over the years we have built thousands of shelter systems that serve as mobile clinics, disaster medical hospitals, and comprehensive military field hospitals.

## Design

Building a field hospital isn't just about components. Understanding hospital layout, patient flow, sterilization and infection control practices are all critical to ensuring that a field hospital performs as planned every time. Our team includes highly experienced medical responders, designers, and technicians. This means that our customers can expect a field hospital system that is flexible, efficient, safe, and simple to use. We understand that lives depend on it.

## Customers

Our field hospitals have been used by some of the world's most demanding customers, including the US Department of Health and Human Services (HHS), Disaster Medical Assistance Teams (DMAT), the US Federal Emergency Management Agency (FEMA), and the US Army's Military Medical Material Agency (USAMMA). As such, our products have been battle-tested in some of the planet's toughest environments. Every lesson we have learned along the way has been used to continuously improve our field hospital systems.

## Service and Support

When you buy a Western Shelter field hospital, you're buying more than just a product. Our sales and support team is the best in the business. We support our customers 24 hours a day, 7 days a week, 365 days a year. We know that our customers have unique missions, and our staff is ready to support trainings, demonstrations, and real-world deployments whenever we're needed, anywhere in the world.

## Standard Field Hospital Components

<b>Field Surgical Unit</b>	Available with expansions for increased workspace
<b>Pre-Op</b>	2 bed configuration standard
<b>Post-Op</b>	2 bed configuration standard
<b>Intensive Care Unit</b>	2 bed configuration, includes patient monitoring
<b>General Examination</b>	Includes exam beds, sinks and cabinetry
<b>Dental Surgery</b>	Includes surgical chair and lighting
<b>Ophthalmology</b>	Comes equipped with full diagnostic suite
<b>X-Ray</b>	Includes shielding, fixed and portable X-ray machines
<b>Laboratory</b>	Fully equipped, incl. refrigerated specimen storage
<b>Pharmacy</b>	Includes secured pharmaceutical storage
<b>Power Generation</b>	Available power outputs from 50-500KW
<b>Water Purification</b>	Desalination option available
<b>Shower/Hygiene</b>	Multiple shower and ablution configurations
<b>Office</b>	Desks, storage cabinets, power and data jacks
<b>Medical Sterilization</b>	Bulk sterilization for large hospital systems
<b>Storage</b>	Flexible storage containers can have multiple uses
<b>Workshop</b>	Workshop includes power, work benches and storage

## Complete Customization Available

Western Shelter Systems understands that field medicine is not a "one size fits all" proposition. Our experienced design team can work with our customers to tailor a solution that meets a wide range of needs and operating conditions. Options include vehicle based solutions, trailer-based systems, and tent/container hybrid systems. We understand that lives depend on it.

# Container Based Field Hospital System

Rugged, Flexible, and Rapidly Deployable

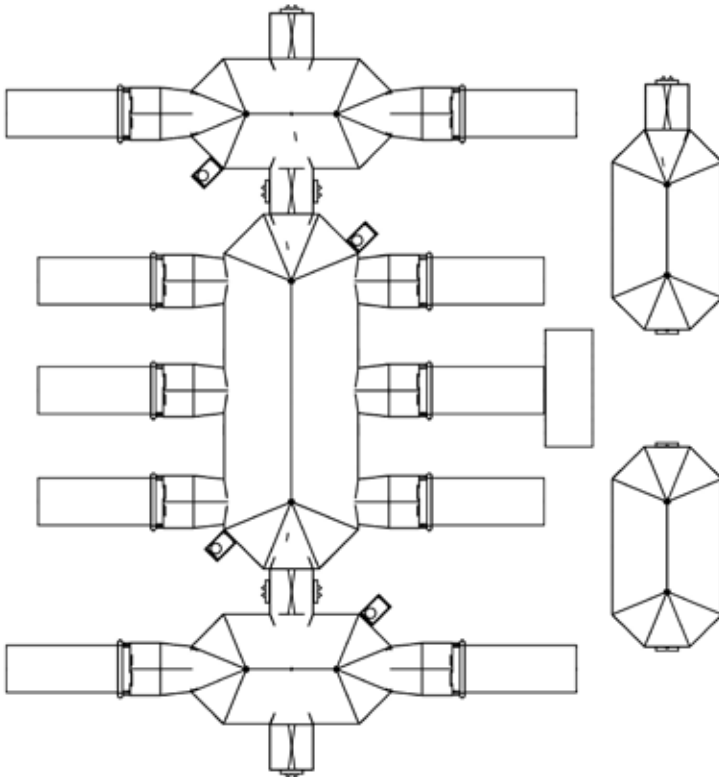

Drawing Depicts 11 Container/50 Bed Field Hospital Incorporating 4 Western Shelter 1935s, 1 Western Shelter 2360, Vestibule Connectors and Entryways



# VESTIBULE CONNECTOR

Part Number SO-VC8H

Quickly Connect Multiple Shelters Into A Large Complex



ISO 9001:2008 Registered Company



## Key Features and Benefits

- **Expandability:** allows for unlimited expansion of Western Shelter systems
- **Quickly deployable:** integrates with the existing shelter in only 10 minutes by one trained person and one volunteer
- **Additional square footage:** expands the operational footprint with 56 sq. ft. of usable floor space in a 7' 8" x 7' 4" space with 6' head clearance
- **Flexibility:** connects to an existing shelter at the wall seam or doorway allowing you to expand to given footprint
- **Negative/positive isolation** can be achieved with Isolation upgrade kit
- **Standardized components** provide easy shelter integration

## Standard Components

- Aircraft aluminum mainframe assembly constructed of 6063-T5/T6
- Sealable floor
- Integrated vinyl and insulation roof panels
- 3-part environmental partition
- Vinyl storage/transport bags



A Vestibule Connector with double doors installed

## SO-VC8H Dimensions

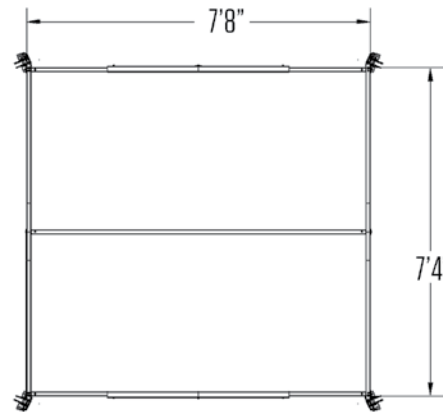

## SO-VC8H Specifications NSN Pending

<b>Usable Area</b>	56 ft <sup>2</sup>	(5.2m <sup>2</sup> )
<b>Total Weight</b>	65 lb	(29.5 kg)
<b>Total Set Up-Time</b>	10 min / 1 personnel	
<b>Dimensions</b>		
Footprint	7' 8" x 7' 4"	(2.3 x 2.3 m)
Sidewall	6'	(1.8 m)
Peak	6' 7"	(2 m)
<b>Packaged Dimensions</b>	92" x 17" x 12"	(2.3 x 0.4 x 0.3 m)



Schedule  
Contract GS03F084CA



International  
Organization for  
Standardization

# VESTIBULE ENTRYWAY KIT

Part Number SO-VE8H

Weather Secure Shelter Expansion



ISO 9001:2008 Registered Company



## Key Features and Benefits

- Antechamber serves as a sheltered entrance or mudroom
- Reduces introduction of air into shelter, conserving energy
- Expandability: allows for unlimited expansion of Western Shelter systems
- Quickly deployable: integrates with the existing shelter in only 10 minutes by one trained person and one volunteer
- Additional square footage: expands the operational footprint with 56 sq. ft. of usable floor space in a 7' 8" x 7' 4" space with 6' head clearance
- Flexibility: connects to an existing shelter at the wall seam or doorway allowing you to expand to given footprint
- Negative/positive isolation can be achieved with optional isolation upgrade kit
- Standardized components provide easy inter-agency shelter integration

## Standard Components

- Aircraft aluminum mainframe assembly constructed of 6063-T5/T6
- Sealable floor
- Integrated vinyl and insulation roof panels
- 3-part environmental partition
- Vinyl storage/transport bags

## SO-VE8H Specifications NSN Pending

<b>Usable Area</b>	56 ft <sup>2</sup>	5.2 m <sup>2</sup>
<b>Total Weight</b>	56 lbs	(25 kg)
<b>Total Set-Up Time</b>	10 min / 1 personnel	
<b>Dimensions</b>		
Footprint	7' 8" x 7' 4"	(2.3 x 2.2 m)
Sidewall	6'	(1.8 m)
Peak	6' 7"	(2 m)
<b>Packaged Dimensions</b>	92" x 17" x 12"	(2.3 x 0.4 x 0.3 m)

## SO-VE8H Dimensions

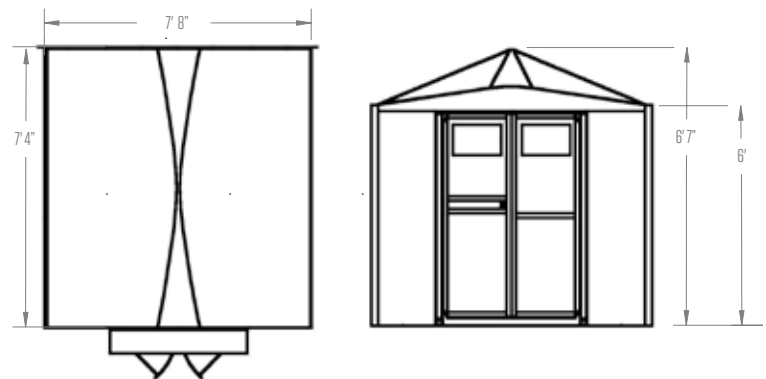

Schedule  
Contract GS03F084CA



International  
Organization for  
Standardization

ISO 9001:2008 Registered Company 29

ISO 9001:2008 Registered Company

# HYGIENE CENTER

Part Number WA-HYHCK  
Shower, Sink and Toilet



ISO 9001:2008 Registered Company

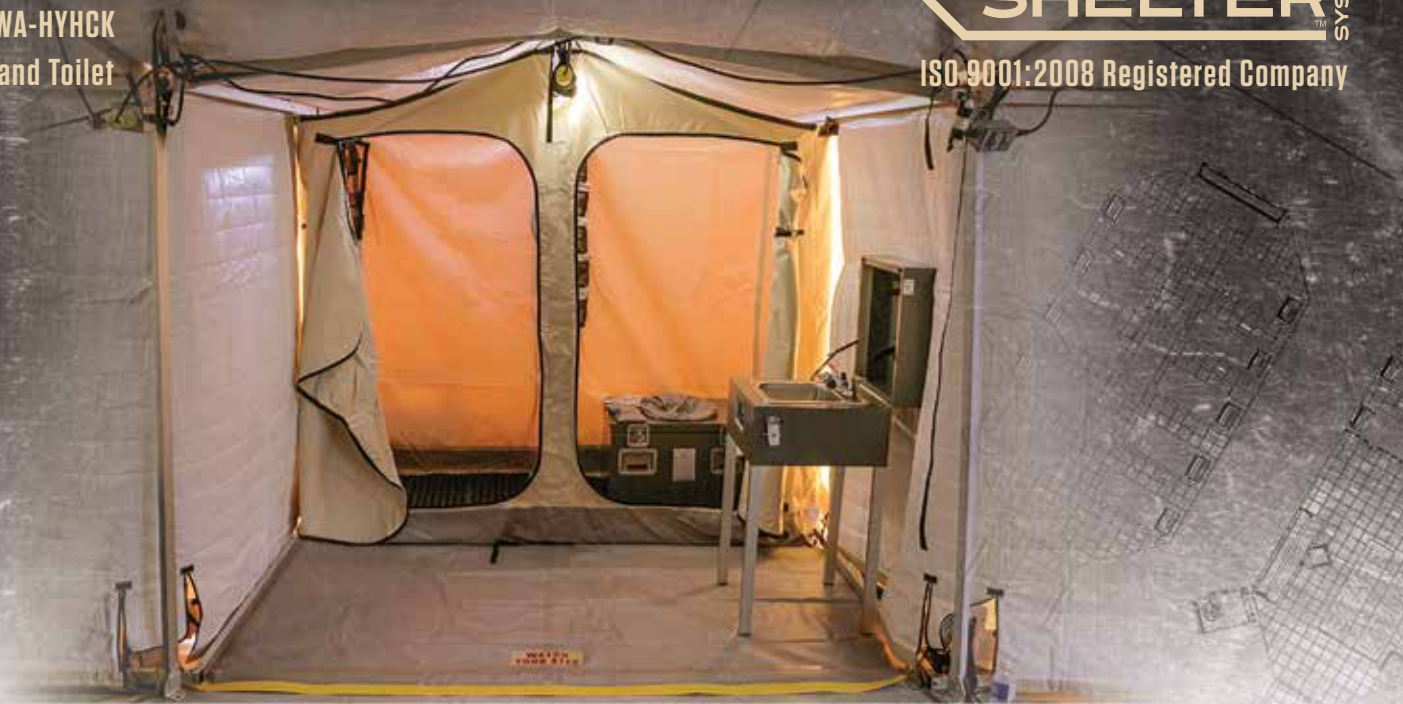

The Hygiene Center is an optional addition to your shelter that provides a self-contained unit with shower, sink and toilet. This system is an asset for mobile hospitals, billeting or longer field operations. Attaching as a stand-alone vestibule that connects directly to an existing shelter, the Hygiene Center offers the complete convenience of a shower, sink and toilet in a private space.

## Key Features and Benefits

- User-friendly, private hygiene system integrates directly into the shelter system
- Attaches to the existing shelter in 20 minutes
- Two individual private stalls
- Hot and cold sink with efficient propane water heater with two hot water outlets
- Water distribution system with potable and gray water collection
- All hoses and fittings for water distribution are included
- Dry chemical self-containing toilet system approved by the EPA
- Can also be used as a 58 sq. ft. storage unit, changing room, pharmacy area, etc.

## Standard Components

- Aircraft grade frame assembly
- Vinyl wall, roof (with insulation) and flooring system
- Vinyl hanging shower and toilet stall
- Single basin sink
- Propane water heater
- Toilet-in-a-box with Brief Relief system
- Privacy curtain
- Shower floor mat (2)
- Shower caddy
- Dry bag for shower
- High-wind tie-down stake kit
- 2020 powder coated aluminum storage case
- 2060 powder coated aluminum storage case

## WA-HYHCK Specifications

<b>Usable Area</b>	58 ft <sup>2</sup>	(17.7 m <sup>2</sup> )
<b>Total Weight</b>	568 lb	(258 kg)
<b>Total Set Up-Time</b>	20 min / 2 personnel	
<b>Dimensions</b>		
Footprint	7' 8.5" x 7' 8.5"	(2.4 x 2.4 m)
Sidewall	6"	(1.8 m)
Peak	6' 7.3"	(2 m)
<b>Packaged Dimensions</b>		<b>Weights</b>
2020 Case	94 x 18 x 21" (2.3 x 0.4 x 0.5 m)	248 lbs (112 kg)
2060 Case	34 x 28 x 21" (0.8 x 0.7 x 0.5 m)	186 lbs (84 kg)
Water Heater	39.5 x 22.5 x 13.5" (1 x 0.5 x 0.3 m)	77 lbs (35 kg)

## WA-HYHCK Dimensions

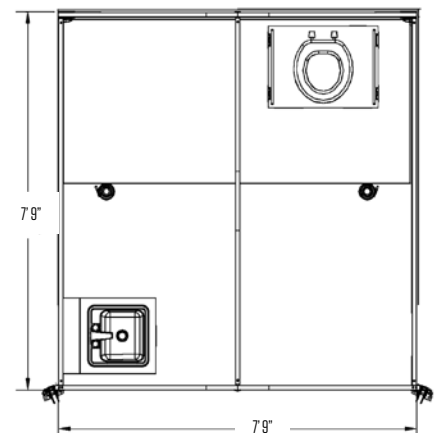

Schedule  
Contract GS03F084CA



International  
Organization for  
Standardization

# SHELTER INSULATION PACKAGES

Part Number SO-IN20 | SO-IN1935 | SO-IN2360 | SO-IN1935RP | SO-IN20RP | SO-IN2360RP

Reduce Heating and Cooling Requirements



ISO 9001:2008 Registered Company



This optional component creates an energy reflective Thermal Barrier directly below the outer vinyl layer of your shelter. The barrier maintains several important functions. Namely, it provides insulation and noise abatement, creates dead air space and minimizes heating and cooling energy requirements.

Made of a bright white and easily cleanable interior space paired with a highly reflective Mylar exterior surface, the thermal barrier is of the shelter roof and walls and can be removed or used separately.

## Key Features and Benefits

- Cost effective insulation minimizes heating and cool requirements and costs
- Configurable independently of shelter roof and walls for easy set up and options
- May be used separately
- Improved Thermal Comfort All Year Round - Insulation assists greatly in keeping heat within the shelter in winter and slowing the flow of heat into the building in summer
- Shelter insulation is an excellent sound absorber and can assist in reducing noise transmission for a quieter work environment
- Insulation reduces condensation by keeping the temperature of the surface at or below the dew-point of the air in contact with it
- Includes vinyl storage bag

## Specifications NSN Pending

<b>Fits</b>	SW/GK1935	HS1935	SW/GK20	SW/GK2360
<b>Part Number   Walls</b>	SO-IN1935		SO-IN20	SO-IN2360
<b>Packaged Dims</b>	96 x 16 x 16" (2.4 x 0.4 x 0.4)		96 x 16 x 16" (2.4 x 0.4 x 0.4)	(2x) 96 x 16 x 16" (2.4 x 0.4 x 0.4)
<b>Total Weight</b>	70 lbs (31.7 kg)		51 lbs (23 kg)	140 lbs (63.5 kg)
<b>Part Number   Roofs</b>	SO-IN1935RP		SO-IN20RP	SO-IN2360RP
<b>Packaged Dims</b>	24 x 19 x 14" (0.6 x 0.5 x 0.25 m)		24 x 19 x 8" (0.6 x 0.5 x 0.4 m)	40 x 31 x 9" (1 x 0.8 x 0.2)
<b>Total Weight</b>	63 lbs (28.5 kg)		34 lbs (15.4 kg)	146 lbs (66.2 kg)
<b>Interior Material</b>	White interior layer made of 200-denier fire retardant fabric			
<b>Exterior Material</b>	Exterior made of highly reflective Mylar			



# SCREEN WALLS

Part Number CL-SWGK1935 | CL-SWGK20 | CL-SWH1935 | CL-SWH20  
 Natural Ventilation



ISO 9001:2008 Registered Company



Maximize natural ventilation in hot or humid weather by installing optional Screen Wall Panels. Used as a replacement for one or more of the standard wall panels, the Screen Wall Panels provide a natural cross-ventilation and air circulation throughout the shelter or complex.

## Key Features and Benefits

- Screen Wall Panels incorporate white, fire-retardant mesh
- Solid vinyl skirt around the base reduces the introduction of dust and dirt
- Wall panels can be changed from solid to screen in less than 5 minutes without the use of tools
- To fully wrap a GK1935, order both a right and left side panel
- Vector control and maximize natural cross-ventilation and air circulation throughout the shelter

## Specifications NSN Pending

### Part Number CL-SWGK1935

Dimensions	(2x) 21' 5" x 6' 8"	2x (6.5 x 2 m)
Weight	(2x) 34 lb.	2x (15.5 kg)

### Part Number CL-SWH1935

Dimensions	(2x) 21' 5" x 6' 8"	2x (6.5 x 2 m)
Weight	(2x) 34 lb.	2x (15.5 kg)

### Part Number CL-SWGK20

Dimensions	(2x) 15' 10" x 6' 8"	2x (4.8 x 2 m)
Weight	(2x) 26 lb.	2x (11.8 kg)

### Part Number CL-SW20

Dimensions	(2x) 15' 10" x 6' 8"	2x (4.8 x 2 m)
Weight	(2x) 26 lb.	2x (4.8 x 2 m)





# DIVIDER WALLS

Part Number PA-SHDW20

Privacy Made Easy



ISO 9001:2008 Registered Company



The addition of Divider Walls to your shelter layout can allow for added privacy or simply to designate work spaces. These fabric divider walls can be quickly and easily installed in any Western Shelter and come complete with zippered doorways for entry into other work spaces.

## Key Features and Benefits

- Quick and easy to store and deploy
- Zipper doorway allows pass through access.
- Easy installation allows for placement before or after shelter set-up
- Divides any shelter to create separate work space and added privacy

## Standard Components

- Fabric Divider Wall
- Zipper Doorway
- Mounting Brackets

## PA-SHDW20 Specifications

<b>Dimensions</b>	27 x 12 x 10"	(0.68 x 0.3 x 0.25 m)
<b>Weight</b>	18 lbs	(8 kg)
<b>Cube</b>	1.9 ft <sup>3</sup>	(0.05 m <sup>3</sup> )



# HARD FLOORING SYSTEM

Part Number SO-FL1935 | SO-FL20 | SO-FL2360 | SOFLV  
Clean And Stable Flooring System



ISO 9001:2008 Registered Company



## Key Features and Benefits

- Provides a clean and stable platform
- Allows gurneys, wheelchairs and other equipment to roll easily across the smooth, even flooring surface
- Custom-sized to fit shelters and vestibules
- Hinged sections are secured with simple hook-and-loop seam connections for easy installation

## Specifications

Product Number	SO-FL1935	SO-FL20	SO-FL2360	SO-FLV
Fits Shelter	1935	20	2360	Vestibule Connector/Entryway
Dimensions	18' 7" x 33' 11" (5.7 x 10.4 m)	18' 7" x 18' 7" (5.7 x 5.7 m)	22' 8" x 60' 1" (5.7 x 10.4 m)	7' 8" x 7' 4" (2.3 x 2.2 m)
Total Weight	488 lbs (221.3 kg)	245 lbs (111.1 kg)	1195 lbs (542 kg)	54 lbs
Number Of Sections	7	4	12	2
Thickness	0.5" (1.3 cm)	0.5" (1.3 cm)	0.5" (1.3 cm)	0.5" (1.3 cm)
Load Strength	500 psi	500 psi	500 psi	500 psi
Fire Resistance	UL94HB	UL94HB	UL94HB	UL94HB
Temperature Use	-35 to 200 F°	-35 to 200 F°	-35 to 200 F°	35 to 200 F



Schedule  
Contract GS03F084CA



International  
Organization for  
Standardization

# Modular Plastic Flooring

Part Numbers SO-FL20BT1 | SO-FLVCBT1 | SO-FL20BT2 | SO-FL20BT2  
 Added Ground Stability

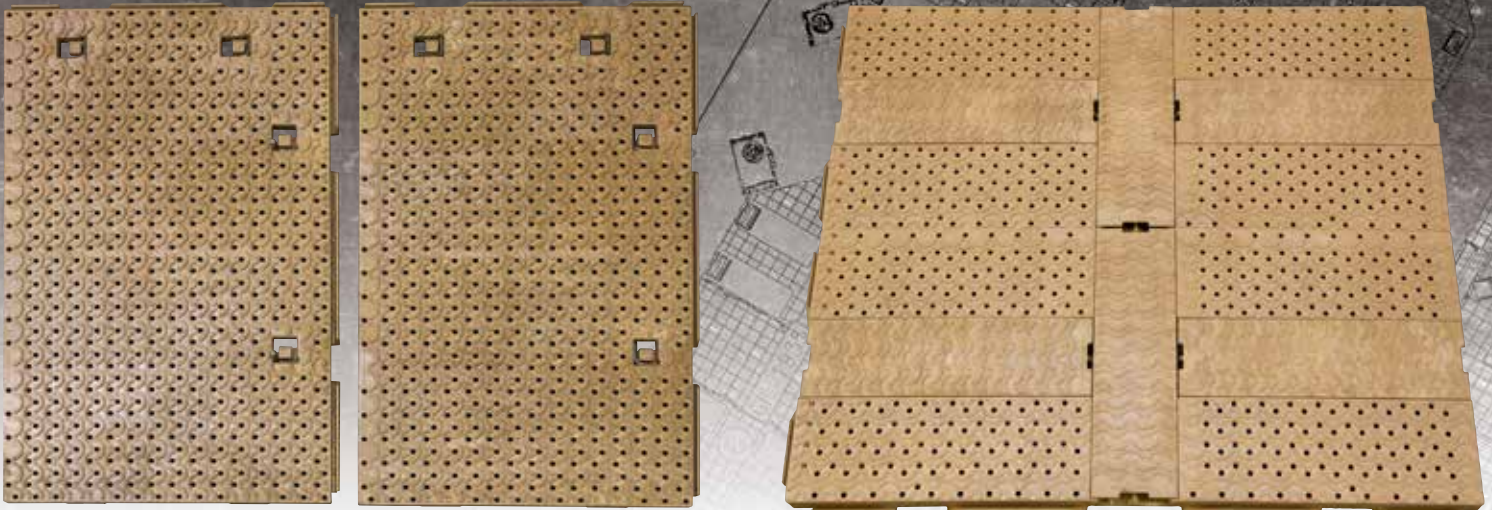

Modular Plastic Flooring has long been a core product used for military and emergency response deployments across the world. Deployed prior to establishing the shelter, this rigid flooring system provides a strong and stable floor underneath the traditional Western Shelters. Three available options allow temporary shelters to take advantage of a variety of different environments and applications. The 2" ICM model features in-floor cable management, built in to each panel, providing an easy way to organize power, communication and other electrical systems.

## Key Features and Benefits

- Stacks flat and interlocks for stable load
- Approximately half the cubic displacement of two inch sheet version at approximately two-thirds the weight (SO-FL20BT1)
- Fast installation: no additional connectors, tools or training required
- Sheets self-align. Steel pins allow positive sheet connection (SO-FL20BT1)
- Flooring sheets are supplied on re-usable pallets with ratchet straps
- All one inch sheet components are modular, durable, interchangeable, and designed for repeated use
- Will support light vehicles

## Standard Components

- Modular Plastic Flooring Sheets

## Specifications

Part Number	One Inch Shelter Flooring SO-FL20BT1	Once Inch Vestibule Flooring SO-FLVCBT1	Two Inch Shelter Flooring* SO-FL20BT2	Two Inch Vestibule Flooring* SO-FL20BT2
Usage	20 Shelter System	Vestibule Connector	20 Shelter System	Vestibule Connector
Number of Tiles	30	9	30	9
Usable Area	420 ft <sup>2</sup> (128 m <sup>2</sup> )	126 ft <sup>2</sup> (128 m <sup>2</sup> )	420 ft <sup>2</sup> (128 m <sup>2</sup> )	126 ft <sup>2</sup> (128 m <sup>2</sup> )
Weight	786 lbs (356.5 kg)	235 lbs (106.5 kg)	1020 lbs (462.6 kg)	306 (138.7 kg)
Packaged Dimensions	32 x 42 x 48" (0.8 x 1 x 1.2 m)	9 x 42 x 48" (0.2 x 1 x 1.2 m)	62 x 42 x 48" (1.5 x 1 x 1.2 m)	20 x 42 x 48 (0.5 x 1 x 1.2 m)
Tile Dimensions	1 x 42 x 48" (0.03 x 0.6 x 1.2 m)		2 x 42 x 48" (0.03 x 0.6 x 1.2 m)	
Material	High density anti-static polyethylene			
Color	Desert Sand			

\*Two Inch Shelter flooring can be configured for In-Floor Cable Management system (ICM)



Schedule  
 Contract GS03F084CA



# HIGH WIND TIE-DOWN KIT

Part Number HWTSK

Stay Grounded In Harsh Weather



ISO 9001:2008 Registered Company



The High Wind Tie-Down Kit was designed and engineered to bring added stability to your shelter whether it's for deployment in harsh environments or simply for everyday use. This kit is strongly recommended for use on every deployed shelter to protect against unanticipated weather. Each kit contains a hammer and recommended number of tie-downs.

## Key Features and Benefits

- Added safety with proper staking of the shelter
- Standardized components provided to allow all necessary tools for proper staking
- The High Wind Tie-Down Kit are strongly recommended for use on every deployed shelter to protect against unanticipated weather

## Standard Components

- Tie-Down Strap Assembly
- 18-Inch Stakes
- 8 lbs Sledge Hammer

## HWTSK Specifications

<b>Product Number</b>	HWTSK-2	
Usage	Vestibule Connector	
Number of Straps/Stakes	2	
Packaged Weight	12 lbs	(5.4 kg)
<b>Product Number</b>	HWTSK-4	
Usage	SW-20BC Shelter System	
Number of Straps/Stakes	4	
Packaged Weight	19 lbs	(8.6 kg)
<b>Product Number</b>	HWTSK-6	
Usage	SW-1935BC Shelter System	
Number of Straps/Stakes	6	
Packaged Weight	25 lbs	(11.3 kg)
All HWTSK kits come standard with a sledge hammer		



Schedule  
Contract GS03F084CA



International  
Organization for  
Standardization

# WATER ANCHORING KIT

Part Number S0-HWWA50  
Stay Grounded In Harsh Weather



ISO 9001:2008 Registered Company



The Water Anchor system is perfect for deployment on concrete or pavement where drilling or driving stakes is not an option. Each 50 gallon water anchor will weigh up to 420 lbs to create a secure anchoring point.

## Key Features and Benefits

- Secures shelters without stakes
- Quick and easy to store and deploy
- 50 gallon water anchor will weigh up to 420 lbs to create a secure anchoring point
- 4-inch fill port and garden hose fitting to allow for quick filling of bladder
- Perfect for deployment on concrete or pavement where drilling or driving stakes is not an option

## Standard Components

- 50 gallon Water Anchor with 4-inch fill port and garden hose fitting
- Each tie down includes:
  - Stainless Steel Brackets
  - 1 Reflective strap to anchor tent (reduces trip hazard)
  - 1 Strap to secure roof fabric
- Vinyl Storage Bag

## S0-HWWA50 Specifications

Dimensions (empty)	25 x 83 x .5"	(0.6 x 2.1 x 0.01 m)
Dimensions (rolled)	25 x 11 x 5"	(25 x 0.27 x 0.1 m)
Weight (empty)	7.6 lbs	(3.4 kg)



Schedule  
Contract GS03F084CA



International  
Organization for  
Standardization

# SITE PREPARATION ANCHORING KIT

Part Number SO-SPAK

Deploy On Asphalt Or Concrete



ISO 9001:2008 Registered Company



While all Western Shelter Systems have been rated for safety under high wind conditions, the Site Preparation Anchoring Kit provides an added level of safety during deployments that might encounter inclement weather. The Site Preparation Anchoring Kit is a recommended option for use when deploying shelters on asphalt or concrete in preparation for high winds. The kit includes enough lag screws to secure up to six SW-1935 shelters and anchors the High Wind Tie-Down stake kits.

## Key Features and Benefits

- Proper anchoring kit for use when deploying shelters on asphalt or concrete
- Safety rated for high wind conditions
- All-in-one kit provides enough lag screws to secure up to six SW-1935 shelters
- Empathetic solution allows responders to leave area in as good a condition as found with repair kit

## SO-SPAK Specifications

### Case Dimensions

Total Weight	85 lbs	(38.5 kg)
--------------	--------	-----------

## Standard Components

- 1/2" Hammer Drill
- Channel Lock Pliers
- Sledge Hammer
- Caulking Gun
- Wheeled Tape Measure
- Caution Tape
- Marker Twine
- Double Bolt Anchors (40)
- Turn-Eye Bolts (40)
- Tube Concrete And Tube Asphalt Repair (4 Each)
- 50' Extension Cord
- Chalk Line
- Ear Plugs (4 Pair) And Protective Glasses (2)
- Wheeled Protective Case



Schedule  
Contract GS03F084CA



International  
Organization for  
Standardization

# HVAC

Part Number CL-ACXE1200

All in One: Heating, Cooling, Dehumidifying



ISO 9001:2008 Registered Company



The XE-1200 HVAC System offers all-in-one services for air conditioning, area cooling, dehumidifying, and portable heating needs. Completely self-contained and portable, this unit provides 3.5 tons/42,000 Btu per hour of cooling and heating. It is also available as a stacking unit, allowing multiple XE-1200 devices to be easily stacked upon transport.

## Key Features and Benefits

- Up-fitted Trane® combination heat pump for reliable performance
- Wrap-around coil guard increases moisture removal of A/C units, dryer supply ducts, humidity control, and energy savings through passive reheat
- Over/under ducting design for efficient direct connection with removable filter
- Cost effective - no fan belts to replace
- Internally insulated cabinet for quiet operation
- Full tube frame with lifting bars for easy transport
- Baked-on powder coated finish for long lasting coverage
- Remote thermostat with 50' cord to allow for proper installation with in the shelter
- Easy to remove, built in filter housing to allow for easy filter replacement

## Standard Components

- HVAC Unit
- Vinyl Cover
- 11.52 kW Heat Strip
- Connection Boots
- 16 x 25 x 1" Filter
- 50' Power Cord
- Electronic Thermostat
- Condensation Runoff Drain System
- Thermostat Cable
- Hvac Stackable Cart (Optional)
- Connector Cord
- Caster Tech Lock Brake Kit

## CL-ACXE1200 Specifications NSN Pending

<b>Dimensions</b>	56 x 35 x 41.5" (1.4 x 0.9 x 1 m)	
<b>Cube</b>	48.5 ft (14.8 m)	
<b>Weight</b>	526 lb (238.5 kg)	
<b>Rated</b>	208/240 Volts, 30-Amp	Single-Phase, 60 Hertz
<b>CFM</b>	1,400	
<b>Cooling</b>	42,000 Btu/hr	
<b>Heating</b>	40,000 Btu/hr	
<b>Ducting</b>		
XE12UD Supply Boot	12" (30.5 cm)	
XE12UD Return Boot	14" (35.5 cm)	
XE12LD Replaceable Filter	16" x 25" x 1" (40.6 x 63.5 x 2.5 cm)	

### Standard Supplemental Heating

27/36k Btu/hr	(For use when ambient temperature is below 40° F (4.5° C) and requires 50 amp circuit for operation)
---------------	--

Remote Thermostat with 50' (15.3 m) cord controls both standard HVAC and aux. heat.



Schedule  
Contract GS03F084CA



# SKID MOUNTED HVAC

Part Number CL-ACXE1200LC

All in One: Heating, Cooling, Dehumidifying



ISO 9001:2008 Registered Company



The Skid Mounted HVAC System offers all-in-one services for air conditioning, area cooling, dehumidifying, and portable heating needs. Completely self-contained and portable, this unit provides 3.5 tons/42,000 Btu per hour of cooling and heating.

## Key Features and Benefits

- Up-fitted Trane® combination heat pump for reliable performance
- Wrap-around coil guard increases moisture removal of A/C units, dryer supply ducts, humidity control, and energy savings through passive reheat
- Over/under ducting design for efficient direct connection with removable filter
- Cost effective - no fan belts to replace
- Internally insulated cabinet for quiet operation
- On board thermostat for temperature control
- Baked-on powder coated finish for long lasting coverage
- Easy to remove, built in filter housing to allow for easy filter replacement

## Standard Components

- HVAC Unit
- Powder Coated Skid
- 11.52 kW Heat Strip
- 16 x 25 x 1" Filter
- On Board Thermostat
- 8' Power Cord With L6-30P End
- Condensation Runoff Drain System

## CL-ACXE1200LC Specifications NSN Pending

<b>Dimensions</b>	55 x 35 x 36"	(1.4 x 0.88 x 0.91 m)
<b>Cube</b>	40.1 ft <sup>3</sup>	(1.13 m <sup>3</sup> )
<b>Weight</b>	425 lbs	(192.7 kg)
<b>Rated</b>	208/240 Volts, 30-Amp	Single-Phase, 60 Hertz
<b>CFM</b>	1,400	
<b>Cooling</b>	42,000 Btu/hr	
<b>Heating</b>	40,000 Btu/hr	
XE12UD Supply Boot	12"	(30.5 cm)
XE12UD Return Boot	14"	(35.5 cm)
XE12LD Replaceable Filter	16" x 25" x 1"	(40.6 x 63.5 x 2.5 cm)

## Standard Supplemental Heating

27/36k Btu/hr (For use when ambient temperature is below 40° F (4.5° C) and requires 50 amp circuit for operation)



Schedule  
Contract GS03F084CA



International  
Organization for  
Standardization



# Mil-Spec HVAC

Part Number CL-ACT65T

All in One: Heating, Cooling, Dehumidifying



ISO 9001:2008 Registered Company



This System offers all-in-one services for air conditioning, area cooling, dehumidifying, and portable heating needs. Completely self-contained and portable. It is also available as a stacking unit, allowing multiple devices to be easily stacked upon transport.

## Key Features and Benefits

- Hot Gas Bypass
- Phase Protection
- Remote Controls
- EMI Suppression
- Stackable
- External Service Ports
- Staggered Start - Compressor Only
- Elapsed time Indicator
- Service Outlet
- Duct Covers
- Fork Pockets and Lifting Eyes
- Optional Casters



## CL-ACT65T Specifications NSN Pending

<b>Dimensions</b>	52 x 42 x 30"	(1.3 x 1 x 0.7 m)
<b>Weight</b>	500 lb	(226.8 kg)
<b>Cooling Capacity</b>	60,000 BTU/HR	
<b>CFM</b>	2,000 CFM Min. @1" ESP	
<b>Heating Capacity</b>	10 kW	
<b>Max Operating Ambient</b>	+140 °F	(+60 °C)
<b>Rating Ambient</b>	+125 °F	(+51 °C)
<b>Min Operating Ambient</b>	-40 °F	(-40 °C)
<b>Refrigeration Stages</b>	1	
<b>Compressor Type</b>	Scroll	
<b>Refrigerant Type</b>	R-407C	
<b>Evaporator Coil</b>	Copper Tube / Aluminum Fin	
<b>Condenser Coil</b>	Microchannel Aluminum	
<b>Duct Connections</b>	Supply 16" Diameter	Return 16" Diameter
<b>Voltage / Phase/ HZ</b>	380 / 3 / 50, 5 Wire	
<b>Max Power Draw</b>	12 kW	
<b>Heating stages</b>	2 Stages	
<b>Frame and Panel Material</b>	5052 Aluminum	



# INDIRECT HEATING KIT

Part Number CL- HT1000

Heat Your Shelter With A Variety Of Fuels



ISO 9001:2008 Registered Company



The Indirect Heater Kit is a clean, powerful, indirect-fired air heater that can be used to effectively heat your shelter system. The powerful fan system in the CL-HT1000 allows the heater to deliver uncontaminated heat to your shelter or duct system. Running a variety of fuels including: kerosene, diesel, JP8, and Jet A/B, the Indirect Heater provides one of the most reliable and effective sources of powered outdoor heating available.

## Key Features and Benefits

- Runs on a variety of fuels including: kerosene, diesel, JP8 and Jet A/B
- Lightweight, portable design
- Low maintenance
- Thermostat for constant temperature control
- Heat for one WS/GK-1935 shelter or for two WS/GK-20 shelters
- Heat exchanger to keep exhaust gas and heated air separate
- Large capacity diesel fuel tanks provide hours of continuous operation

## Standard Components

- One 91,000 Btu, Indirect-Fired, Trifuel Heater
- Remote room thermostat

## CL- HT1000 Specifications

<b>Dimensions</b>	(49.3 x 20 x 30.5")	(1.25 x 0.5 x 0.77m)
<b>Weight</b>	94lbs	42 kg
<b>Heat Input</b>	110 kBTU/h	
<b>Heat Output</b>	91.9 kBTU/h	
<b>Air Flow</b>	880 cfm	
<b>Fuel Type</b>	Diesel/Kerosene	JP8 and Jet A/B
<b>Power Supply</b>	120 v, 60Hz	
<b>Electric Usage</b>	520 W, 5.76 A	
<b>Fuel Usage</b>	.80 g/h	5.53lb/h
<b>Tank Capacity</b>	10.8 gallons	40.9 liters
<b>Pump Pressure</b>	167 PSI	
<b>Max Temp. Air Duct</b>	250° F	
<b>Flue Diameter</b>	5.9in	15cm



# SHELTER CEILING FAN

Part Number CL-FNC48VS

Energy Efficient Air Circulation



ISO 9001:2008 Registered Company



## Key Features and Benefits

- Variable speed design allows for enhanced air circulation
- High-humidity and high-moisture applications
- Mixes air to save you money on heating and cooling bills
- Energy efficient 9,415 CFM of air movement using less energy than a 100 Watt light bulb
- Ceiling fan breaks down to fit into rugged carrying case for quick transportation and convenient storage
- Corrosion-resistant white powder coated finish
- UL/CUL certified (File # E130543) for outdoor and agricultural use

## Standard Components

- Fan
- Hanging Bracket
- Speed Control Switch
- Carrying Case

## CL-FNC48VS Specifications

<b>Packaged Dimensions</b>	31 x 12 x 12"	(0.78 x 0.3 x 0.3 m)
<b>Weight</b>	17 lb	(7 kg)
<b>Power</b>	120 V	



Schedule  
Contract GS03F084CA



International  
Organization for  
Standardization

# AIR DISTRIBUTION PLENUMS

Part Number WS-1935AP | WS-20AP | WS-2360AP

Efficiently Move Heated or Cooled Air



ISO 9001:2008 Registered Company



Air Distribution Plenums efficiently move heated or cooled air from an external heating/cooling unit evenly throughout the shelter. These lightweight plenums hang in the interior of the shelter connected directly to the heating/cooling unit. The compact design stores in a vinyl bag (included).

## Key Features and Benefits

- Efficient air distribution - circulate heated and cooled air throughout the shelter
- Lightweight and compact for storage, each plenum comes in its own transport bag.
- Reconfigure from any HVAC duct boot connection
- Economical plenum systems are cheaper to install from a mechanical basis as less duct work is required

## Standard Components

- White Vinyl Plenum With Hanging Straps
- Storage Bag

## Specifications NSN Pending

Part Number	WS-1935AP (fits SW-1935)	WS-20AP (fits SW20)	WS-2360AP (fits SW2360)*
Packaged Dimensions	26 x 8 x 8" (0.6 x 0.2 x 0.2 m)	26 x 8 x 8" (0.6 x 0.2 x 0.2 m)	(2)26 x 8 x 8" (0.6 x 0.2 x 0.2 m)
Weight	11 lbs (4.9 kg)	7 lbs (3.1 kg)	

\*two recommended per shelter



Plenum installed in SH-20 shelter

# MQ POWER 3 PHASE GENERATORS

Part Number EL-GN125SSJU4I | EL-GN150SSJU4F  
 EL-GN25SSIU4F | EL-GN40SSKU4F  
 EL-GN45SSIU4F | EL-GN70SSJU4I  
 Portable Power To Fit Your Mission



ISO 9001:2008 Registered Company



The MQ Power WhisperWatt™ line of portable generators provides a variety of power options to suit the needs of your mission. Each WhisperWatt™ generator features a sound-deadening, weather-resistant housing that allows substantially lower operating noise levels than competitive designs.

An automatic safety shutdown system monitors the water temperature, engine oil pressure, low coolant, low DEF, overspeed, and overcrank. Warning lights indicate abnormal conditions.

The fully covered power panel allows fast and convenient hookup for most applications including temporary power boxes, tools and lighting equipment. All are NEMA standard.

## Key Features and Benefits

- Heavy duty 4-cycle, direct injection, turbocharged, charge air cooled diesel engine provides maximum reliability
- Brushless alternator reduces service and maintenance requirements
- Shock welding to steel frame for minimum vibration and extended service life.
- Weather-resistant steel housing for durability
- Sound-deadening enables operation as low as 62dBA full load at 23 ft.
- Automatic safety shutdown system
- Meets EPA emissions standards
- Internal fuel tank with direct reading fuel gauges
- Illuminated, easy-to-read instrument panels
- Fully lockable enclosure for safe, unattended operation
- Fuel/water separator removes condensation from fuel for extended engine life!
- Transport options include trailers and wheel kits for complete mobility

## Specifications

Part Number	EL-GN125SSJU4I	EL-GN150SSJU4F	EL-GN25SSIU4F	EL-GN40SSKU4F	EL-GN45SSIU4F	EL-GN70SSJU4I
Engine	170.3hp John Deere	240hp John Deere	40.2hp Isuzu	48.3hp Kubota	65.7hp Isuzu	97.9hp John Deere
Output	125 Kva / 100 Kw	150 Kva / 120 Kw	25 Kva / 20 Kw	36 Kva / 28 Kw	45 Kva / 36 Kw	70Kva / 56 Kw
Dimensions	49 x 120 x 73" (1.25 x 3 x 1.85 m)	51 x 138 x 69" (1.2 x 3.5 x 1.75 m)	31 x 71.65 x 49.6" (0.7 x 1.8 x 1.25 m)	37.4 x 36 x 53" (0.94 x 0.91 x 1.3 m)	37.4 x 84 x 61" (0.94 x 2.1 x 1.5)	37.4 x 105 x 68" (0.94 x 2.66 x 1.7 m)
Cube	248.4 ft <sup>3</sup> (0.004 m <sup>3</sup> )	281 ft <sup>3</sup> (0.0046 m <sup>3</sup> )	63.75 ft <sup>3</sup> (0.001 m <sup>3</sup> )	41.3 ft <sup>3</sup> (0.0006 m <sup>3</sup> )	111 ft <sup>3</sup> (0.0018 m <sup>3</sup> )	154.5 ft <sup>3</sup> (0.0025 m <sup>3</sup> )
Weight (Dry)	5,137 lbs (2,330 kg)	6,615 lbs (3,000 kg)	1,797 lbs (815 kg)	2,250 lbs (1020 kg)	2,337 lbs (1,060 kg)	3,329 lbs (1,510 kg)
Fuel Consumption	7.3 gph at full load	8.4 gph at full load	1.62 gph at full load	2.2 gph at full load	1.62 gph at full load	4.4 gph at full load
Fuel Capacity	168 gallons (636 L)	69 gallons (260 L)	26 gallons (98 L)	67.4 gallons (L)	79.2 gallons	103 gallons
Decibels at 23 ft	70 dBA	66 dBA	65 dBA	61 dBA	66 dBA	65 dBA
Fits Trailer	EL-GNTRLR125USH	EL-GNTRLR180XFH	EL-GNTRLR45H EL-GNTRLR25US	EL-GNTRLR45H	EL-GNTRLR45H	EL-GNTRLR70USH



# MQ POWER 1 PHASE GENERATORS

Part Number EL-GN15SPXU4F | EL-GN20SPXU4F | EL-GN36SPXU4F

Portable Power To Fit Your Mission



ISO 9001:2008 Registered Company



The MQ Power WhisperWatt™ line of portable generators provides a variety of power options to suit the needs of your mission. Each WhisperWatt™ generator features a sound-deadening, weather-resistant housing that allows substantially lower operating noise levels than competitive designs.

An automatic safety shutdown system monitors the water temperature, engine oil pressure, low coolant, low DEF, overspeed, and overcrank. Warning lights indicate abnormal conditions.

The fully covered power panel allows fast and convenient hookup for most applications including temporary power boxes, tools and lighting equipment. All are NEMA standard.

## Key Features and Benefits

- Heavy duty 4-cycle, direct injection, turbocharged, charge air cooled diesel engine provides maximum reliability
- Brushless alternator reduces service and maintenance requirements
- Shock welding to steel frame for minimum vibration and extended service life.
- Weather-resistant steel housing for durability
- Sound proofing enables operation as low as 64 dBA full load at 23 ft.
- Automatic safety shutdown system
- Meets Tier 4 EPA emissions standards
- Internal fuel tank with direct reading fuel gauges
- Illuminated, easy-to-read instrument panels
- Fully lockable enclosure for safe, unattended operation
- Transport options include trailers and wheel kits for complete mobility

## Specifications

Part Number	EL-GN15SPXU4F	EL-GN20SPXU4F	EL-GN36SPXU4F
Engine	Kubota Tier 4 Final	Isuzu Tier 4 Final	Kubota Tier 4 Final
Output	15 Kw	20 Kw	36 Kw
Dimensions	56.3 x 35.4 x 25.6" (1430 x 900 x 650 mm)	71.65 x 31.10 x 49.61" (1820 x 790 x 1260 mm)	87.01 x 37.40 x 61.02" (2210 x 950 x 1550 mm)
Weight (Dry)	1,179 lbs (535 kg)	1,797 lbs (815 kg)	2,448 lbs (1,110 kg)
Cube	29.52 ft <sup>3</sup> (0.83 m <sup>3</sup> )	63.97 ft <sup>3</sup> (1.8 m <sup>3</sup> )	114.9 ft <sup>3</sup> (3.25 m <sup>3</sup> )
Fuel Consumption	1.09 gph at full load	1.62 gph at full load	2.93 gph at full load
Fuel Capacity	16.4 gallons (62 L)	17 gallons (64.3 L)	26.5 gallons (100.3 L)
Decibels at 23 ft	64 dBA	65 dBA	66 dBA
Fits Trailer	EL-GNTRLAMPXF		



Schedule  
Contract GS03F084CA



International  
Organization for  
Standardization

# POWER DISTRIBUTION PANELS

Part Number EL-EDP100 | EL-EDP200

EL-EDP300 | EL-EDP400

Reliable Power Dispersion



ISO 9001:2008 Registered Company

Portable Power Distribution Panels are an integral part of creating a power system capable of sustaining your entire shelter complex. Connect to a shore power source or generator, these distribution panels provide a safe and reliable way to disperse power to each shelter's electrical distribution kit.

## Key Features and Benefits

- Four to ten available outlet positions from a 15 Amp 110v duplex to 50 Amp twist locks
- Single or three phase cam-lok inlet and outlet for adding additional panels or feeding another item
- Three phase Square D QO load center
- Three individual "phase on" high intensity pilot lamps
- Use storage stand to place panel away from generator
- Customer information can be laser etched into door
- Customized to fit customer spec

## Standard Components

- Carrying handle welded on top with a hook
- Enclosure and all hardware are stainless steel or aluminum
- Break resistant polycarbonate window

## Optional Components

- Stand
- Hooks to hang from generator

## Specifications

### EL-EDP100

Power Four 50 Amp 125/250V Outlets

### Dimensions

Weight 36 lbs (16 kg)

Phase Single

Use w/ 15-20 KW Generator

### EL-EDP200

Power Six 50 Amp 125/250V Outlets

### Dimensions

Weight 45 lbs (20.4kg)

Phase Three

Use w/ 20-36 KW Generator

### EL-EDP300

Power Eight 50 Amp 125/250V Outlets

### Dimensions

Weight 50 lbs (22.6 kg)

Phase Three

Use w/ 36-70 KW Generator

### EL-EDP400

Power Ten 50 Amp 125/250V Outlets

### Dimensions

Weight 50 lbs (22.6 kg)

Phase Three

Use w/ 70-150 KW Generator



# POWER DISTRIBUTION KIT

Part Number WS-EDK50

Route Power From High-Amp Distribution Panel Directly To Each Shelter



ISO 9001:2008 Registered Company

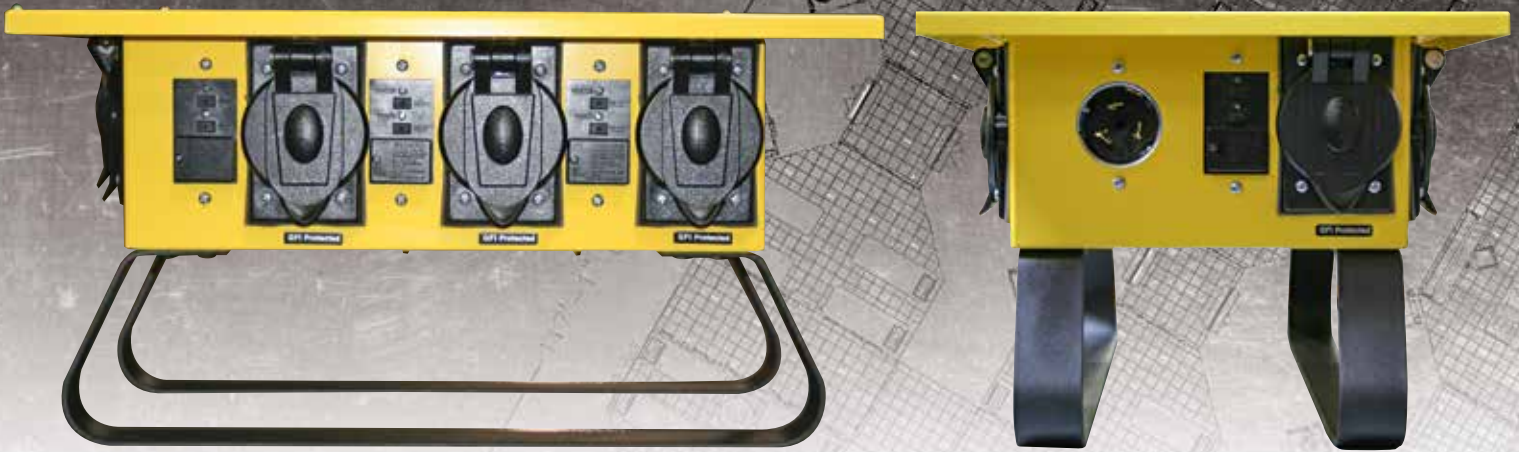

## Key Features and Benefits

- Easily route power from high amp distribution panel to each shelter within a complex
- GFCI protected with UL outdoor listing for safe and reliable power
- Weather-proof with individual circuit breakers for dependability
- Available in 220 V

## Standard Components

- Power Distribution Box
- Two 50' Power Cables
- Six 50' Extension Cords
- Powder Coated Aluminum Storage Case



## WS-EDK50 Specifications

Power Box	
Dimensions	14.5 x 21 x 11" (36.8 x 53 x 28 cm)
Weight	30 lbs (13.6 kg)
6 GFCI Protected Circuits	20 Amp 125 V
1 Protected Outlet	30 Amp 240 V
1 Feed Through	50 Amp 125/250 V
WS50A50 Power Cables	
50' 125/250 V	6/4 and 8/1 SOW Water Resistant
WS15A50 Extension Cords	
50' 110 V	Yellow Glow Flex Cord with LED Lighted Female End
Molded 3-Wire Plug	Moisture and Flame Resistant
UL/CL Listed	Meets OSHA Requirements
WS2060 Powder Coated Aluminum Storage Case	
Dimensions	28 x 34 x 21" (71 x 86 x 53 cm)
Weight	176 lbs (80 kg)
Cube	11.57 ft <sup>3</sup> (0.32m <sup>3</sup> )



Schedule  
Contract GS03F084CA



International  
Organization for  
Standardization



# STRINGABLE SHELTER LED LIGHT

Part Number EL-LTINLEDW

Energy-Efficient Lighting



ISO 9001:2008 Registered Company



## Key Features and Benefits

- Lightweight, compact design for easy transport and storage
- Connect lights to form a versatile string
- On/Off switch on each fixture allows power to pass through to next light
- Single full power white mode
- Hanging straps for easy mounting
- Humidity resistant to function in all climates

## Optional Components

- Hard plastic case (fits up to 4 lamps)

## EL-LTINLEDW Specifications

Input Voltage	100 - 240 VAC	50 or 60 Hz
Current Draw	0.14A	120 VAC
Volume	113 in <sup>3</sup>	(729 cm <sup>3</sup> )
Lumens	2,000	
Max Operating Surface Temp	122°F@ 70°F Ambient	(50°C@ 21°C Ambient)
Weight	3.9 lbs	(1.76 kg)
Major Diameter	3.75 In	(9.5 cm)
Body Length	26.8 in	(68 cm)
Std. Male Cord Length	46.6 in	(118 cm)
Std. Female Cord Length	46.6 in	(118 cm)
Overall Length	120 in	(304 cm)
Plug Type	NEMA 5-15 (standard)	



Schedule  
Contract GS03F084CA



International  
Organization for  
Standardization

# SHOWERS

Part Number WSDK

Two Person Shower System



ISO 9001:2008 Registered Company

Each WSDK system can be deployed as a two shower system or as a single stall shower with an accompanying private dressing room. Built with the same durable aluminum framing material as all Western Shelter systems, each shower utilizes a snap-lock system on eave and base bars and a hook-and-loop attachment cover system. Covered in a durable 14 oz. vinyl coated fabric with zippered doors, each system incorporates shower catch basins plumbed for the recovery of gray water.

## Key Features and Benefits

- Versatile configurations – 2 person shower or 1 shower/dressing room
- Made of aircraft grade aluminum frame and durable vinyl coated polyester
- Set up in under 15 minutes without the use of tools
- Pre-plumbed for recovery of gray water
- Includes dry bag for use during shower
- Up to 6 WSDK shower systems can be set up inside a Western Shelter 1935 shelter
- Color: Desert Sand

## Standard Components

- 14 oz vinyl wall panel with divider panel and zippered doors
- 14 oz vinyl roof panel with clear view roof panels
- Standard aluminum base bars, eave bars, leg assemblies, and roof frame assembly
- Individually controlled shower head, shower manifold bracket and 1-each hot 10' heavy duty intake hose coupled with GHT-brass male X female connectors
- 45" x 90" Heavy-duty 30 oz. vinyl catch basin with pre-plumbed drain/ sump pump fittings
- 18 oz vinyl field bag with zipper closure and side/end carry handles
- Dry storage bag with hook-and-loop closure
- Full instruction manual. No tools required for assembly

## WSDK Specifications NSN Pending

<b>Dimensions</b>	92.5" x 46.5" x 87"	(2.3 x 1.18 x 2.2 m)
<b>Sidewall Height</b>	6'	(1.8 m)
<b>Peak Height</b>	87"	(2.2 m)
<b>Unit Weight</b>	112 lb.	(50.8 kg)
<b>Total Shipping Weight</b>	237 lb.	(107.5 kg)
<b>Packaged Dimensions*</b>	87" x 19" x 12"	(2.2 x 0.5 x 0.3 m)
<b>Standard Shipping Package**</b>	92" x 19" x 20"	(2.4 x 0.5 x 0.5 m)
<b>Environment</b>	-20°F - 135°F	(-28°C to 57°C)
<b>Berry Compliant</b>	✓	

\*Packaged Dimensions include zippered frame and wall bag

\*\*Standard Shipping Package includes pallet, fits 6 double walled cardboard boxes



# PORTABLE FIELD SINKS

Part Number WS-SK3 | WS-SK2 | WS-SK1  
Self Contained Sink System



ISO 9001:2008 Registered Company



Western Shelter's Portable Field Sinks are available in three sizes; one, two or three basin sinks. These portable and rapidly deploying sink systems provide individually controlled hot and cold water capabilities for each basin.

Each sink is housed in an aluminum case with a stainless steel basin. Both the double and triple basin sinks come with unbreakable Lexan mirrors.

## Key Features and Benefits

- Individually controlled hot and cold water capabilities for each basin
- Designed to interconnect with multiple units
- Self contained in a rugged aluminum cabinet
- Unbreakable, scratch-resistant polycarbonate mirror per basin (not included with single basin)
- Quick disconnect primary drain.

## Standard Components

- 16 x 16" Plexiglass mirror (up to 3)
- 0.5" Hose, Blue Pliovic with 250 PSI (not included in single basin)
- Universal discharge hose
- Thermostatic valve included with single basin
- 15 x 15 x 5-1/8" Sink with 4" faucet

## Triple Basin Specifications

Part # WS-SK3

Dimensions	68 x 19 x 14"	(1.72 x 0.48 x 0.35 m)
Total Weight	95 lbs	(43 kg)
Cube	10.47 ft <sup>3</sup>	(0.29 m <sup>3</sup> )

## Double Basin Sink Specifications

Part # WS-SK2

Dimensions	51 x 19 x 14"	(1.3 x 0.48 x 0.35 m)
Total Weight	75 lbs	(34 kg)
Cube	7.85 ft <sup>3</sup>	(0.22 m <sup>3</sup> )

## Single Basin Sink Specifications

Part # WS-SK1

Dimensions	19 x 19 x 13"	(0.48 x 0.48 x 0.33 m)
Total Weight	45 lbs	(20 kg)
Cube	2.72 ft <sup>3</sup>	(0.08 m <sup>3</sup> )



Schedule  
Contract GS03F084CA



International  
Organization for  
Standardization

# MULTI-FUEL WATER HEATER

Part Number WSDWHM350 | WSDWHM650

On Demand Hot Water



ISO 9001:2008 Registered Company



The Water Dragon™ Multi-Fuel Hot Water Delivery System has been specifically engineered for operationally deployed teams and units who require reliable, on-demand, high-flow hot water delivery and precise holding temperatures. This durable and portable system offers tremendous interoperability and broad spectrum interface with field showers, hygiene centers, field kitchens, and other applications. The user-friendly configuration and ease of operation make this system extremely popular.

## Key Features and Benefits

- Multi-Fuel – diesel, kerosene or JP-8 aircraft fuel
- High flow hot water delivery with +/- 1° holding temperature
- Self contained in powder-coated aluminum case
- Portable design with removable wheels and recessed lifting handles

## Standard Components

- Water Connections: 2 Hot and 1 Cold water outlet with 1 water inlet,
- 1 weather tight 120V, 60 Hz, 15 amp outlet
- 1 weather tight 120V, 60 Hz, 15 amp inlet
- 1 auxiliary 120V, 60 Hz, 15 amp connection
- Fuel Cell: 8 gallon tank with gauge
- Control Panel:
  - 2 hot water valves
  - 1 cold water valve
  - 1 water inlet valve
  - 1 water pressure/temperature gauge
  - Power on/off switch
  - Fuse holder and fuse panel light toggle switch
  - 1 weather tight 120V, 60 Hz 15 amp outlet and inlet
  - System power indicator light unit.

## Specifications

Part Number	WSDWHM350	WSDWHM650
Dimensions	48 x 24 x 26" (121 x 61 x 66 cm)	48 x 28 x 24.5" (121 x 71 x 63 cm)
Weight	370 lb (168 kg)	435 lb (197 kg)
Cube	16 ft <sup>3</sup> (4.8 m <sup>3</sup> )	19 ft <sup>3</sup> (5.8 m <sup>3</sup> )
Maximum Pressure	12 gallons/min (45 L/min.)	16 gallons/min (60.6 L/min.)
Maximum PSI	150	150
Minimum Flow Rate	Min. 0.75 gallon/min (2.9 L/min.)	
Fuel Options	Diesel, Kerosene and JP-8	
Burner/Coil Output	440,000 BTU (Max)	



Schedule  
Contract GS03F084CA



International  
Organization for  
Standardization

# PROPANE FIELD WATER HEATER

Part Number WA-WHP

Instant Supply of Hot Water



ISO 9001:2008 Registered Company



This self-contained, propane-fired heating module offers a continuous, instant supply of hot water. Units come complete with heater, pre-plumbed water distribution manifold including one cold water inlet, 2-hot water outlets, and one cold water outlet.

## Key Features and Benefits

- Propane fired heating module
- Provides continuous supply of hot water for any situation
- Self contained in powder-coated aluminum case for extra protection
- Pre-plumbed water distribution manifold
- Quick-connect propane hose with regulator

## Standard Components

- Heater
- Pre-Plumbed Water Distribution Manifold Includes 1 Cold Water Inlet, 2 Hot Water Outlets And 1 Cold Water Outlet
- Quick-Connect Propane Line With Regulator
- 45 Second Quick-Lite Primer Valve
- Powder Coated Aluminum Case

## Optional Components

- Wheel Kit
- Thermostatic Control System

## WA-WHP Specifications NSN Pending

<b>Dimensions</b>	39.5 x 22.5 x 13.5"	(1 x 0.57 x 0.3 m)
<b>Weight</b>	77 lbs	(35 kg)
<b>Cube</b>	6.94 ft <sup>3</sup>	(0.19 m <sup>3</sup> )
<b>Output</b>	117,000 BTU	
<b>Rate of Rise</b>	1.90 GPM	100°F
<b>Flow</b>	Min. 0.5 GPM	Max. 4.2 GPM
<b>Water Pressure</b>	Min. 2.0 PSI	Max. 150 PSI



# WATER HANDLING

Part Number WDK-10SK/10SKM

Water on Demand



ISO 9001:2008 Registered Company



Designed to support most water handling applications in the field, the WA-WDK10 supports up to 10 people with a 4 WSD shower system. Complete with hot, cold and gray water delivery hoses, the kit will support 4 shower heads and one 3-basin sink. Each kit includes a 500 gallon potable bladder and a 500 gallon gray water bladder as well as sump pump kits and a primary water distribution pump.

## Standard Features

- Supports up to 10 person shower system
- Contains potable and gray water bladders
- Hot, cold and gray hoses
- Many common adapters

## WDK-10SK/10SKM Specifications NSN Pending

Dimensions	34 x 28 x 21"	(86 x 71 x 54 cm)
Weight	195 lb.	(88.5 kg)
Cube	11.5 ft <sup>3</sup>	(3.5 m <sup>3</sup> )

## Standard Components

### Potable Items

- 1 – EJ110 primary water distribution pump
- 1 – IPVC-36DMC 1" x 36" PVC suction hose coupled double 1" male poly-cam connection
- 1 – IPVC-12MCMK 1" x 12" PVC suction hose coupled 1" male poly-cam x 1" male king nipple
- 1 – TTP-500 500 gallon potable water bladder kit
- 2 – 0.50 x 25 GHTH 25" hot water discharge hose coupled male x female GHT – red
- 2 – 0.50 x 25 GHTC 25" cold water discharge hose coupled male x female GHT – blue
- 2 – 0.50 x 72-2W-HWDH 72" heavy-duty, hot water discharge hose with 2 male – GHT outlets to accommodate a continuous run of the WS-D shower

### Gray Water Collection

- 1 – TTG-500 500 gallon gray water bladder kit
- 1 – PTC-12A-GWA gray water bladder adapter
- 2 – DDP-550PCSB sump pump kit with poly-case, switch box with indicator light, and integrated timer for automatic shut-off of pump
- 2 – 155113 GHT – female low-liner strainer
- 2 – 0.50 x 20GHT 20" suction hose coupled male x female GHT – black
- 2 – 0.50 x 36GHT 36" suction hose coupled male x female GHT – black
- 2 – 0.50 x 25 GHTG 25" gray water discharge hose coupled male x female GHT – black
- 2 – 0.50 x 72 GHT 72" gray water discharge hose coupled male x female GHT – black

- 2 – 0.50 x 84-2W-GWDH 84" heavy-duty gray water discharge hose with one 3/4" male/female GHT inlet and one 3/4" male GHT outlet to accommodate a continuous run of the WS-D shower system gray water collection process from the DDP550PC-SB sump pump kits to the TTG500 gray water bladder – black

### M80 Military Water Heater Adapters (WDK-10SKM)

- 1 – ST.38-QCA Snap-Tite BPHN6-6F BPHN6/GM inline tee adapter quickconnect with hot water GHT discharge valve
- 1 – ST.38-QCEA Snap-tite BPHN6-6F quick-connect end adapter with hot water GHT discharge valve
- 1 – M80.1PTC M80 discharge valve and adapter assembly

### Adapters and Fittings

- 1 – ACC500GH4V 3/4" GHT 4-way manifold with shut-off valves
- 2 – 75CVA 3/4" GHT check valve assembly
- 2 – 75SV 3/4" GHT shut-off valve
- 2 – 75WV.S 3/4" GHT Wyes with shut off valves
- 2 – 75DM 3/4" GHT double male adapter
- 2 – #75DF-SW 3/4" GHT double female swivel adapter
- 2 – 75F-CCA 3/4" GHT cap and chain assembly with gasket
- 12 – 75SG 3/4" GHT rubber swivel gaskets
- 2 – WDK-FBV cordura fittings bag with hook and loop closure
- 1 – WDK-NAB nylon, 2 – compartment adapter bag with strap closure and shoulder strap



# WATER HANDLING

Part Number WA-WDK30/30M

Water on Demand



ISO 9001:2008 Registered Company



Designed to support most water handling applications in the field, the WA-WDK30 supports up to 30 people with a 4 WSD shower system. Complete with hot, cold and gray water delivery hoses, the kit will support 8 shower heads and one 3-basin sink. Each kit includes a 500 gallon potable bladder and a 500 gallon gray water bladder as well as sump pump kits and a primary water distribution pump.

## Standard Features

- Supports up to 30 person shower system
- Contains potable and gray water bladders
- Hot, cold and gray hoses
- Many common adapters
- WS-2090 powder-coated aluminum storage case with recessed handles

## WA-WDK30/30M Specifications NSN Pending

Dimensions	60 x 21 x 22"	(152 x 53 x 56cm)
Weight	275 lb.	(124.7 kg)
Cube	16 ft <sup>3</sup>	(0.45 m <sup>3</sup> )

## Standard Components

### Potable Items

- 1 - EJ110 primary water distribution pump
- 1 - 1PVC-36DMC 1" x 36" PVC suction hose coupled double 1" male poly-cam connection
- 1 - 1PVC-12MCMK 1" x 12" PVC suction hose coupled 1" male poly-cam x 1" male king nipple
- 1 - TTP-500 500 gallon potable water bladder kit
- 2 - 0.50 x 25 GHTH 25" hot water discharge hose coupled male x female GHT - red
- 2 - 0.50 x 25 GHTC 25" cold water discharge hose coupled male x female GHT - blue
- 4 - 0.50 x 72-2W-HWDH 72" heavy-duty, hot water discharge hose with 2 male - GHT outlets to accommodate a continuous run of the WS-D shower

### Gray Water Collection

- 1 - TTG-500 500 gallon gray water bladder kit
- 1 - PTC-12A-GWA gray water bladder adapter inner strainer
- 4 - 0.50 x 20GHT 20" suction hose coupled male x female GHT - black
- 4 - 0.50 x 36GHT 36" suction hose coupled male x female GHT - black
- 2 - 0.50 x 25 GHTG 25" gray water discharge hose coupled male x female GHT - black
- 4 - 0.50 x 72 GHT 72" gray water discharge hose coupled male x female GHT - black
- 2 - 0.50 x 84-2W-GWDH 84" heavy-duty gray water discharge hose with one 3/4" male/female GHT inlet and

one 3/4" male GHT outlet to accommodate a continuous run of the WS-D shower system gray water collection process from the DDP50PC-SB sump pump kits to the TTG500 gray water bladder - black

### M80 Military Water Heater Adapters (WDK-10SKM)

- 1 - ST.38-QCA Snap-Tite BPHN6-6F BPHN6/6M inline tee adapter quickconnect with hot water GHT discharge valve
- 1 - ST.38-QCEA Snap-tite BPHN6-6F quick-connect end adapter with hot water GHT discharge valve
- 1 - M80.1PTC M80 discharge valve and adapter assembly

### Adapters and Fittings

- 1 - ACC500GH4V 3/4" GHT 4-way manifold with shut-off valves
- 4 - 75CVA 3/4" GHT check valve assembly
- 4 - 75SV 3/4" GHT shut-off valve
- 4 - 75WV.S 3/4" GHT Wyes with shut off valves
- 4 - 75DM 3/4" GHT double male adapter
- 4 - #75DF-SW 3/4" GHT double female swivel adapter
- 4 - 75F-CCA 3/4" GHT cap and chain assembly with gasket
- 12 - 75SG 3/4" GHT rubber swivel gaskets
- 2 - WDK-FBV cordura fittings bag with hook and loop closure
- 1 - WDK-NAB nylon, 2-compartment adapter bag with strap closure and shoulder strap



Schedule Contract GS03F084CA



International Organization for Standardization

# POTABLE WATER STORAGE BLADDER

Part Number WA-WCB150P | WA-WCB300P | WA-WCB500P  
 WA-WCB1200P | WA-WCB2000P  
 Simple Clean Water Storage

**WESTERN SHELTER** SYSTEMS  
 ISO 9001:2008 Registered Company



## Key Features

- Constructed of heavy-duty coated fabric
- Pre-plumbed with one 1" NPT main valve with cam lock fittings and two 3/4" GHT valve ports to accept the output of the AC 201-2 water purification system and feed EJ-110 distribution pump



## Specifications NSN Pending

Part Number TTP-150		
Capacity	150 Gallons	(567 L)
Dimensions	65 x 46 x 15"	(1.6 x 1.16 x 0.38 m)
Cube	26 ft <sup>3</sup>	(0.7 m <sup>3</sup> )
Part Number TTP-300		
Capacity	300 Gallons	(1135 L)
Dimension	95 x 70 x 18"	(2.4 x 1.7 x 0.45 m)
Cube	68 ft <sup>3</sup>	(1.9 m <sup>3</sup> )
Part Number TTP-500		
Capacity	500 Gallons	(1893 L)
Dimensions	101 x 92 x 16"	(2.56 x 2.3 x 0.4 m)
Cube	86 ft <sup>3</sup>	(2.4 m <sup>3</sup> )
Part Number TTP-1200		
Capacity	1200 Gallons	(4542 L)
Dimensions	120 x 144 x 24"	(3 x 3.6 x 0.6 m)
Cube	240 ft <sup>3</sup>	(6.8 m <sup>3</sup> )
Part Number TTP-2000		
Capacity	2000 Gallons	(7570 L)
Dimensions	190 x 162 x 18"	(4.8 x 4.1 x 0.45 m)
Cube	321 ft <sup>3</sup>	(9 m <sup>3</sup> )





# GRAY WATER STORAGE BLADDER

Part Number WA-WCB150G | WA-WCB300G | WA-WCB500G  
 WA-WCB1200G | WA-WCB2000G  
 Capture And Contain Gray Water Discharge



## Key Features And Benefits

- Capture and contain gray water discharge of field equipment
- Pre-plumbed with a 1 1/4" main valve with "CAM-LOK" fittings and two 3/4" GHT valve ports, these bladders will accept the discharge of the WS-DK field shower, WS-55 Decon-Shower and the WS-SK3 field sink.
- Gray water containment tanks are clearly marked "FOR GRAY WATER SERVICE ONLY" and come with a Gray Water pipe to "CAM-LOK" adapter



WA-WCB150G storage bladder in use

## Specifications NSN Pending

Part Number WA-WCB150G		
Capacity	150 Gallons	(567 L)
Dimensions	65 x 46 x 15"	(165 x 117 x 38 cm)
Cube	26 ft <sup>3</sup>	0.7 m <sup>3</sup>
Part Number WA-WCB300G		
Capacity	300 Gallons	(1135 L)
Dimension	95 x 70 x 18"	(241 x 178 x 46 cm)
Cube	68 ft <sup>3</sup>	1.9 m <sup>3</sup>
Part Number WA-WCB500G		
Capacity	500 Gallons	(1893 L)
Dimensions	101 x 92 x 16"	(257 x 234 x 40 cm)
Cube	86 ft <sup>3</sup>	2.4 m <sup>3</sup>
Part Number WA-WCB1200G		
Capacity	1200 Gallons	(4542 L)
Dimensions	120 x 144 x 24"	(305 x 366 x 61 cm)
Cube	240 ft <sup>3</sup>	6.8 m <sup>3</sup>
Part Number WA-WCB2000G		
Capacity	2000 Gallons	(7570 L)
Dimensions	190 x 162 x 18"	(483 x 411 x 46 cm)
Cube	321 ft <sup>3</sup>	9 m <sup>3</sup>

# SNAPTANK

Part Number ST-1000 | ST-1500 | ST-2000 | ST-2500 | ST-3000

Rigid -Framed Tank



ISO 9001:2008 Registered Company



Realize all the advantages of a rigid-framed relay/dump tank with the mobility and compact packaging of an unsupported freestanding tank. No spill over, no rolling.

Nothing in the industry offers more structural integrity on flat or uneven ground than the SnapTank. With its quality components and interchangeable parts, the SnapTank can add valuable capacity to any response without the expensive apparatus modifications necessary to transport a traditional rigid tank.

Constructed of the finest aircraft quality aluminum components, SnapTank is light, yet durable and can be fully functional in minutes. Five models offer capacities from 1,000 to 3,000 gallons, each plumbed with a standard 3" threaded flange with plug and packaged in a compact field bag.

## STORAGE/TRANSPORT

MODEL	WEIGHT	LENGTH	WIDTH	HEIGHT
ST 1000	74 lbs	39"	16"	14"
ST 1500	90 lbs	49"	16"	14"
ST 2000	101 lbs	56"	16"	14"
ST 2500	110 lbs	63"	16"	14"
ST3000	121 lbs	69"	16"	14"

## CAPACITIES AND ASSEMBLED DIMENSIONS

MODEL	Gallons	A	B	C	D
ST 1000	1,000	100"	33"	38"	98"
ST 1500	1,500	136"	33"	48"	122"
ST 2000	2,000	150"	33"	55"	139"
ST 2500	2,500	169"	33"	62"	156"
ST3000	3,000	185"	33"	68"	170"

# SNAPTANK™

WESTERN SHELTER SYSTEMS™  
US AND FOREIGN PATENTS

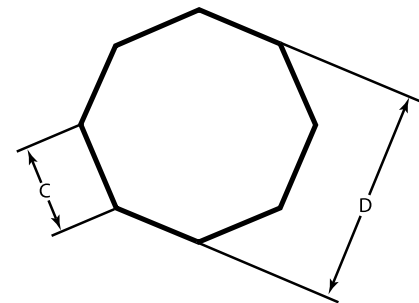
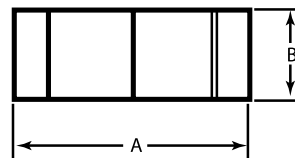

## GROUND COVERS

GC1000	Ground Cover for ST1000
GC1500	Ground Cover for ST1500
GC2000	Ground Cover for ST2000
GC2500	Ground Cover for ST2500
GC3000	Ground Cover for ST3000



Schedule  
Contract GS03F084CA



International  
Organization for  
Standardization

# PORTABLE EMERGENCY WATER PURIFICATION

Part Number WA-WPFW120

Provide Exceptional Drinking Water In Any Environment



ISO 9001:2008 Registered Company



## Key Features and Benefits

- 120 gallon per hour water purification unit to accommodate large groups
- Fully contained in a rugged transport case to add extra protection
- Onboard pump can draw water from virtually any fresh water source
- Utilizes advanced filtration technology and ultraviolet disinfection
- UV dose exceeds 40mj/cm<sup>2</sup>
- Effective to 0.019 microns
- Independently certified to USEPA and NSF standards for emergency drinking water (P231/P238)
- Optional solar powered model provides additional flexibility for field operations

## WA-WPFW120 Specifications NSN Pending

<b>Dimensions</b>	22" x 18" x 10"	(0.5 x 0.4 x 0.2m)
<b>Cube</b>	2.2917 cu"	(0.06 cu m)
<b>Weight</b>	45 lb per box	(20 kg)
<b>Purification Rate</b>	2 gpm	
<b>Power</b>	120 V AC	
<b>Amperage</b>	9 amps	



# HIGH VOLUME WATER PURIFICATION

Part Number WA-WPFW300

Ideally Suited For Emergency Response Scenarios



ISO 9001:2008 Registered Company



## Key Features and Benefits

- Dual Zeonic™ filtration and 40mj UV disinfection for high performance
- Designed to function in both fixed facility and field operations
- Mounted in a rugged wheeled transport case for easy transport/storage
- UV dose exceeds 40mj/cm<sup>2</sup>
- Effective against microbiology as small as 0.019 microns
- Effective against viruses, bacteria and cysts in fresh water
- Independently certified to USEPA and NSF standards for emergency drinking water (P231/P238)

## Optional Equipment

- Solar powered model **WA-WPFW300S** provides additional flexibility for field operations

## WA-WPFW300 Specifications NSN Pending

<b>Dimensions</b>	31 x 24 x 17"	0.7 x .6 x .4m
<b>Cube</b>	7.3 cu ft	.2 cu m
<b>Weight</b>	105 lbs	47.6 kg
<b>Power</b>	120 VAC / 12 VDC	
<b>Amperage</b>	19 amps	
<b>Purification Rate</b>	5 gpm	



Schedule  
Contract GS03F084CA



International  
Organization for  
Standardization

# LARGE SCALE WATER PURIFICATION

Part Number WA-WPFW1200

Sustain Critical Operations In Fixed Facility Or Field Operations



ISO 9001:2008 Registered Company



## Key Features and Benefits

- Daily production capability of 28,000 gallons
- Hourly production capability of 1,200 gallons
- Designed to function in both fixed facility and field operations
- Rugged aluminum frame and compact size, it is lightweight and easily transported in a SUV or van
- UV dose exceeds 40mj/cm<sup>2</sup>
- Effective to 0.019 microns, ideal for hospital support such as dialysis and laboratories
- Produces microbiologically safe water for human consumption and food preparation

## WA-WPFW1200 Specifications

<b>Dimensions</b>	40 x 24 x 32"	(1.0 x 0.6 x 0.8 m)
<b>Cube</b>	17.7 ft <sup>3</sup>	(5.4 m <sup>3</sup> )
<b>Weight</b>	150 lb	(68 kg)
<b>Water Source</b>	Fresh	
<b>Purification Rate</b>	20 Gallons per minute	(75.8 L)
<b>Power</b>	Recyclable	
<b>Amperage</b>	15 amps	
<b>Standards</b>	USEPA/NSF P248/P231	



Schedule  
Contract GS03F084CA



International  
Organization for  
Standardization

# WATER DISTRIBUTION BAG

Part Number WA-WPFWAB

Emergency Water Distribution



ISO 9001:2008 Registered Company



## Key Features and Benefits

- 1.5 gallon water containers are made of thick, food grade plastic
- BPA free
- Integrated carry handle
- Fold flat for easy storage
- Lightweight and require minimal storage space
- Recyclable
- Packaged in boxes of 200

## WA-WPFWAB Specifications NSN Pending

<b>Dimensions</b>	12.5 x 14.5"	(0.3 x .36 m)
<b>Thickness</b>	.008"	(0.20 mm)
<b>Weight</b>	33 lb per box	(15 kg)
<b>Capacity</b>	1.5 gal	(5.5 L)
<b>Box Dimensions</b>	22 x 21 x 10"	(0.6 x 0.5 x 0.3 m)
<b>PET/LLDPE</b>	Recyclable	



Schedule  
Contract GS03F084CA



International  
Organization for  
Standardization

# SINGLE STALL RELIEF STATION

Part Number HY-TLRFK

Fully Enclosed Field Toilet



ISO 9001:2008 Registered Company



The Western Shelter Portable Single-Stall Relief Station Kit features a single-stall, fully enclosed field toilet. The Relief Station is quickly and easily assembled from the same articulated aluminum frame components as the single-stall shower.

The interior floor and cabinet is a one-piece, folding aluminum component that folds flat for storage. A collapsible poly-box, lined with disposable containment bags, is positioned beneath the toilet seat to hold the sealed Brief Relief pouches for later disposal.

## Key Features and Benefits

- Single stall with enclosed toilet for privacy
- The U.S. military rated its shelf life at 10 years plus
- Easy accessibility with zipper doorway

## Standard Components

- One-piece collapsible floor and toilet cabinet
- 12 Pack collection poly-box and containment bags
- WSRFC relief caddy dispenser for Brief Relief supplies
- 2 vinyl field bags

## HY-TLRFK Specifications

<b>Dimensions</b>	48 x 48 x 72"	(1.2 x 1.2 x 1.8 m)
<b>Frame and Bag</b>	87 x 19"	(2.2 x 0.4 m)
<b>Containment Box</b>	48 x 30 x 4"	(1.2 x 0.7 x 0.1 m)
<b>Total Weight</b>	110 lbs	(49.8 kg)



Schedule  
Contract GS03F084CA



International  
Organization for  
Standardization

# AIR PURIFIER

Part Number CL-FNAP3000  
Maintain A Healthy Environment  
With Air Decontamination



**WESTERN SHELTER** SYSTEMS

ISO 9001:2008 Registered Company

Maintaining clean and odor free surroundings is critical for the comfort and well-being of both patients and staff. The AP3000 reduces odors while helping to maintain a healthier environment with aggressive, continuous air decontamination. Studies have shown the AP3000 reduces surface contaminants and control airborne particulates. The AP3000 is a portable self-contained unit with fully adjustable fan speeds and purifier levels. The LCD display on the front of the unit makes settings and maintenance reminders simple and includes a remote control.

## Key Features and Benefits

- Fully adjustable fan speed/purifier levels
- LCD display on front of unit for settings and maintenance reminders
- No filters required
- Remote control
- Bracket for hanging included
- May be used separately
- Adjustable settings for areas from 250 to 3000 sq ft
- Self contained, portable, multiple air system will reduces odors, visible smoke, and specific contaminants on surfaces commonly found in the indoor environment.

## Standard Components

- AP 3000 Air Purification Unit
- Hanger Bracket
- Hanger Shelf
- GK-AP3000 strap

## CL-FNAP3000 Specifications NSN Pending

<b>Dimensions</b>	12 x 9 x 12"	(30.5 x 22.8 x 30.5 cm)
<b>Weight</b>	16 lb	(7.3 kg)
<b>Coverage</b>	3,000 ft <sup>2</sup>	(914.4 m <sup>2</sup> )
<b>Electrical</b>	120V AC, 60 Hz, 70 Watts	
<b>Mechanical</b>	40-60 CFM fan	



Air Purifier installed in a 1935 Shelter System



Schedule  
Contract GS03F084CA



International  
Organization for  
Standardization



# BUNK BED

Part Number SA-FRBNK  
Portable Bunk Bed Kit



ISO 9001:2008 Registered Company



The portable Bunk Bed Kit is specifically designed for easy setup in the field while providing a more comfortable sleeping platform than conventional cots. No tools are required for simple 4-step assembly. Sleeps two persons in space of one.

## Key Features and Benefits

- Sturdy bunk beds rated for 900lbs combined weight rating (450 lbs per level)
- Leg stands are articulated and fold for storage
- Fully self-supporting and works well on uneven ground
- Fabricated from rectangular powder-coated aluminum tubing covered with 18 oz/yd polyester mesh for a cool, supporting surface
- Comfort, mesh surface of bed conforms to the body to create a comfortable sleeping pocket for each individual

## Standard Components

- Powdered aluminum bunk bed frame with 18 oz/yd mesh
- Heavy duty vinyl storage bag with carrying handles

## Optional Components

- Bunk Bed Cart (SA- FRBNKCRT) holds 25 bunks

The entire bunk bed disassembles and stores in a convenient, heavy-duty, zippered field bag. Some customers prefer to use the bunk set for sleeping on the bottom with the upper bunk used for personal gear.

## SA-FRBNK Specifications

<b>Dimensions</b>	72 x 32.5 x 44"	(183 x 82.5 x 112 cm)
<b>Stowed Dimensions</b>	84" x 8" diameter	(213 x 20 cm)
<b>Total Weight</b>	62 lb	(28 kg)



Schedule  
Contract GS03F084CA



International  
Organization for  
Standardization

# KITCHEN CART

Part Number SA-FRPKK

Fully Functioning Portable Kitchen



ISO 9001:2008 Registered Company



## Key Features and Benefits

- Versatile portable kitchen has the ability to heat, microwave, wash, and refrigerate
- Plenty of storage space for all you spices, utensils pots and pans
- Large prep area included once the doors are open
- Completely plumbed and wired for seamless integration into your existing Western Shelter water distribution system
- Standalone operations with a simple garden hose connection if hot water at the tap is not required

## Standard Components

- Powder Coated Aluminum Case On Heavy Duty Wheels With Recessed Handles, Cam Locks,
- Ceramic 2-Burner Cook Top With Surface Warning Lamp
- Refrigerator With Freezer
- 1000 Watt Microwave
- Stainless Steel Sink

## SA-FRPKK Specifications

Dimensions		
Closed	64 x 30 x 47"	(163 x 76 x 119 cm)
Deployed	129 x 30 x 42.5"	(328 x 76 x 108 cm)
Counter	129" wide x 28" deep	(328 x 71 cm)
Weight		
	450 lb	(204 kg)
Usable Counter Space		
	3,600 in <sup>2</sup>	(2.32 m <sup>2</sup> )
Stove Burners		
	1200 & 1700 Watts	
Usable Refrigerator Space		
	51 ft <sup>3</sup>	(0.14 m <sup>3</sup> )
Microwave Cube		
	0.7 ft <sup>3</sup>	(0.02 m <sup>3</sup> )
Sink Dimensions		
	14" x 16"	(35.5 cm x 40.6 cm)
Operates On A Single 110V/60 Hz 20 Amp Circuit		



Schedule  
Contract GS03F084CA



International  
Organization for  
Standardization

# ASSET TABLE

Part Number SA-ASTTBL  
Interchangeable Work Platform



ISO 9001:2008 Registered Company



Western Shelter Systems' ASSET™ Table (Advanced Support/Survival Equipment Table) performs many different roles and functions. These interchangeable working platforms connect at different heights, widths, and lengths to provide a stable solution for almost any inspection or task.

## Key Features and Benefits

- Sturdy table can support up to 800 pounds
- Frame constructed of surgical grade stainless steel
- Easily deployed and quickly stored
- Thermoformed ABS surface provides stable load bearing platform
- Treated to eliminate electrostatic discharge
- Interconnect in a variety of ways with unique Slotlok system
- Optional components provide heightened functionality

## Standard Components

- ABS Table Top
- Stainless Steel Frame
- 4 Reversible Foot Pads
- 4 Vertical Connection Plugs
- 4 Casters

## Optional Components

- Asset Table Shelf
- Multi-Purpose Utility Tray (36" or 60")
- Protective Bags



The tables make a great stand-alone desk and computer station that can be wheeled anywhere they are needed. By stacking the ASSET™ Tables, these platforms offer great load bearing shelves and storage space.

## SA-ASTTBL Specifications

### Dimensions

Folded	2.75 x 36 x 60"	(7 x 91 x 152 cm)
Open/No Leg Ext.	22 x 36 x 60"	(56 x 91 x 152 cm)
Open/Leg Ext.	32 x 36 x 60"	(81 x 91 x 152 cm)
Open/Leg Ext./Wheels	36 x 36 x 60"	(91 x 91 x 152 cm)

### Weight

Table	42 lb	(19 kg)
Table/Leg Extensions	55 lb	(25 kg)
Table Top Only	22.5 lb	(10 kg)
Frame	32.5 lb	(14.7 kg)
Caster Wheels	2.75 lb	(1.2 kg)



# WORK STATION

Part Number S0-WSK20

Easily Accessible Foldable Desk



ISO 9001:2008 Registered Company



Whether you use it for command and control or patient reception, the Western Shelter Work Station is a unique solution to your in field work space requirements. Each Work Station consists of a collapsible, powder-coated aluminum desk and two shelves. Integrating directly with the internal shelter walls, these work stations harness the strength of the shelter frame to provide a work capable of supporting up to 50 lbs. per table top and 25 lbs. per shelf.

## S0-WSK20 Specifications

<b>Table Dimensions</b>	26.5" wide	(0.67 m)
<b>Shelf Dimensions</b>	10" wide	(0.25)
<b>Length</b>	Length varies per shelter—work stations span one wall segment	
<b>Total Weight</b>	52 lbs	(23.5 kg)

## Key Features and Benefits

- Rapidly deployable with integration into existing shelter
- Collapsible and lightweight for easy storage
- Provides in shelter work space
- Durable desk set holds up to 50 lbs per table top and 25 lbs per shelf

## Standard Components

- Desk And Shelf Frame
- Assembly Material



Schedule  
Contract GS03F084CA



International  
Organization for  
Standardization

# QUARANTINE/ISOLATION STATION

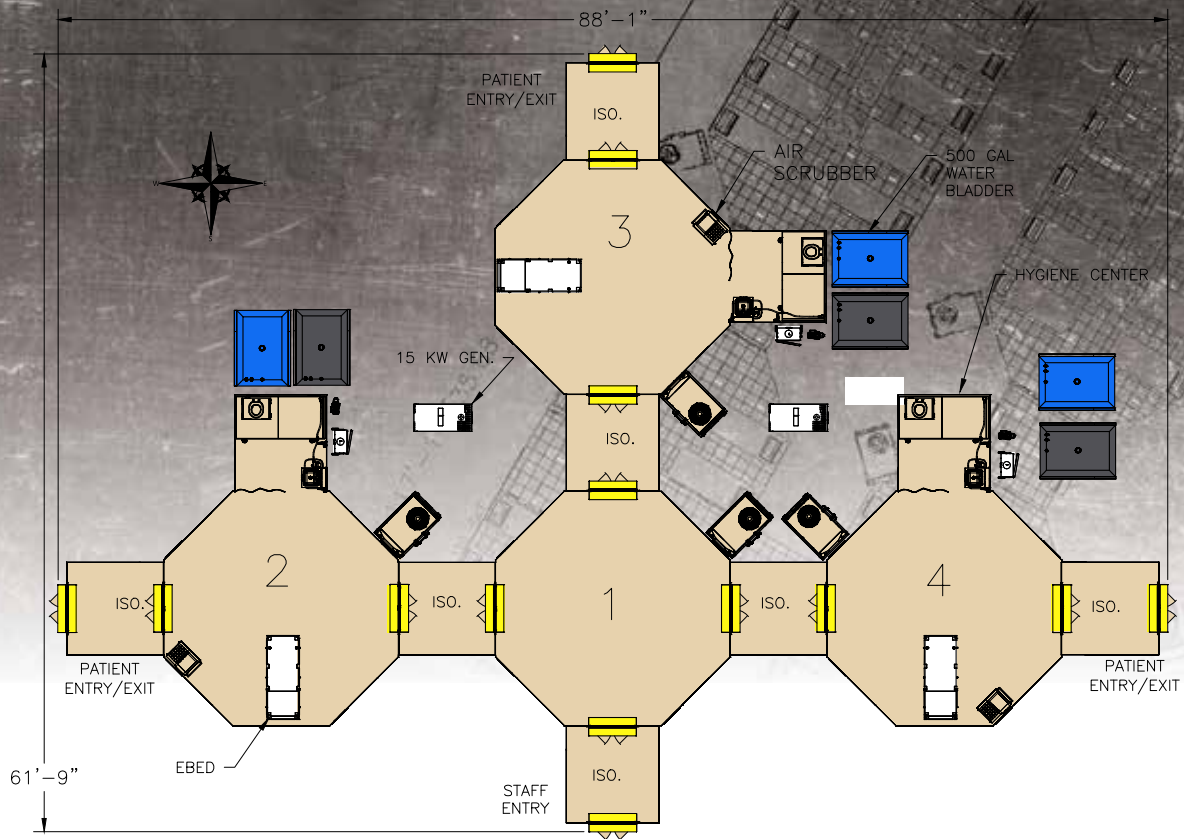

## Objective:

Provide a comprehensive alternative health facility that is designed to be functional, yet modular and portable for managing the infectious disease patient. Emerging infectious disease is an ever present danger in our society. Whether it is a seasonal influenza or an Ebola outbreak, the infrastructure of a hospital needs to remain as clean as possible during these events. Triage, treatment, quarantine, and isolation of these patients in an off-site facility may be critical to protecting the hospital's infrastructure.

## Conditions:

The facility should be portable, easy to erect, and easy to manage. The interior space should look as close to a brick and mortar structure as possible to reduce stress on patients and staff. Having spacious, well lit individual patient areas, functional staff areas, and good patient flow is also key. Isolation capability with negative pressure, HEPA filtration and climate control are required for safety. Individual patient areas that are separated by a double door air lock, and individual Hygiene Center, create the ultimate in patient isolation.

## Components:

Western Shelter's line of GateKeeper shelters is perfectly suited to meet the needs of this mission. Extended entryways with air locks help maintain the negative pressure atmosphere of the complex. Separate dressing areas that are directly connected within the complex helps maintain a secure and safe environment for both staff and patients.

## Guided Tour:

As you open the hinged door to the staff entrance, you feel a rush of air enter behind you. Once inside the airlock, a five count will ensure the correct pressure has been reestablished. Entering the Ante Room (1), you will see that this is a room designated for staff only. This is considered a clean area where personal protective gear can be donned. Medical supplies and other essential gear may be gathered here before entering one of the 3 patient area airlocks. Again, once inside the airlock, wait 5 seconds to allow for the pressure to build. Now inside one of the patient areas (2, 3 or 4) the shelter contains an E-Bed, MO bag, and any other needed equipment. There is a patient entrance on one wall, and a hygiene center on another. The hygiene center is there for patient use or gross decon of a staff member if needed. When it is time to leave the patient area, staff and patients must leave through the Exit airlock. Decontamination consistent with local standards should occur as they exit the airlock. Western Shelter can assist with decontamination components, but is not responsible for training or waste removal. Removal of waste, linens, and other "dirty" items from the interior will be passed through one of a few designated openings in the shelter. Staff areas are meant to be completely separate from the treatment complex.

# ISOLATION UPGRADE

Part Number SO-VC8IU | SO-VE8IU

A Secure and Isolated Environment



ISO 9001:2008 Registered Company



The optional Isolation Upgrade creates a secure environment that maintains the isolation integrity of each shelter. Available for the Vestibule Entryway, Vehicle Boot and Vestibule Connector. The GateKeeper Isolation System can support positive or negative pressure for surgical units and ICU patient wards.

## Key Features and Benefits

- Abatement-helps to create and maintain "clean to dirty" directional airflow when used in combination with portable HEPA filtration systems
- Vital component in maintaining +/- air pressure. Available for Entryway, Vestibule Connector or Vehicle Boot
- Versatile design allows installation without striking shelter and can be installed when needed
- Cost-effective isolation solution provides an alternative to fixed anterooms during potential airborne infectious outbreaks.
- Fast, non-permanent installation offers maximum flexibility for use when you need it, where you need it.

## Standard Components

- Rigid door

## Specifications NSN Pending

### Part Number VC-GK-ISO

Works with	Vestibule Connector	
Weight	72 lb	(32.7 kg)
Dimensions		
Cubic Feet	12.4 ft <sup>3</sup>	(3.8 m <sup>3</sup> )

### Part Number VE-GK-ISO

Works with	Vestibule Entryway or Vehicle Boot	
Weight	72 lb	(32.7 kg)
Dimensions		
Cubic Feet	7.6 ft <sup>3</sup>	(2.3 m <sup>3</sup> )



# MEDICAL TREATMENT BED

Part Number SA-MEWC18 | SA-MEWC30

An Essential in Patient Care



ISO 9001:2008 Registered Company



Western Shelter Systems offers two options of medical beds to suit the specific needs of your hospital, the SA-MEWC18 and the SA-MEWC30. These beds are essential for quality patient care within your medical facility system.

Similar in structure, the SA-MEWC30 is the medical bed for Active Patient Care. This style bed was designed to accommodate active patients with an increased height for accessibility.

## Key Features and Benefits

- Easy assembly, lightweight rust proof aluminum frame weighs only 32 lbs
- Reinforced decking with hook and loop springs provides 450 lbs working capacity
- Spun tube ends with heavy duty leg locks on all legs prevents bed from unintentional moves
- High strength patient restraint, stow on board safety rails contribute to the safety of this patient bed
- Fire resistant mattress meets FED STD 1633 and ADA compliant
- Spring and deck design, 2" convoluted foam mattress for a comfortable sleeping surface
- 18" Wheelchair transferable height - or choose 30" active patient care procedure height, depending on the needs of your staff
- 2 position Trendelenburg foot elevator and 5 position head elevator with locking cord provides high degree of adjustability
- Lightweight foldable aluminum frame for stacked storage

## Standard Components

- Head elevator lock: simple, reliable locking cord keeps the adjuster in place
- High strength springs: looped and crimped for safety and comfort
- Stow on board IV pole and safety rails
- Leg locks on all legs
- Waterproof, Antimicrobial mattress

## Optional Components

- Disposable linens

## SA-MEWC18 Specifications NSN Pending

<b>Dimensions</b>	35" x 81" x 18"	(0.88 x 2 x 0.4 m)
<b>Folded Dimensions</b>	35" x 42" x 8"	(0.88 x 1 x 0.2 m)
<b>Sleeping Surface</b>	32" x 80"	(0.8 x 2 m)
<b>Weight</b>	32 lbs	(14.5 kg)
<b>Capacity</b>	450 lbs	(204 kg)

## SA-MEWC30 Specifications NSN Pending

<b>Dimensions</b>	35" x 81" x 30"	(0.8 x 2 x .76 m)
<b>Folded Dimensions</b>	35" x 42" x 8"	(0.8 x 1 x 0.2 m)
<b>Sleeping Surface</b>	32" x 80"	(0.8 x 2 m)
<b>Weight</b>	40 lbs	(18 kg)
<b>Capacity</b>	450 lbs	(204 kg)



# E-BED MEDICAL TREATMENT BED

Product Number SA-MEBEDCMPT

Versatile, Multi-Use Bed



ISO 9001:2008 Registered Company



E-Bed Medical Treatment Bed is a versatile, sturdy and durable multi-use medical treatment bed. Use it in the ER for additional surge capacity, in mass sheltering deployed as a cot or roll it out to the alternate care shelter for mass casualty triage and treatment. The E-Bed stores in its

own rolling cart system that can store five fully-equipped E-Beds with mattresses or 10 Standard E-BED-50021-32 without mattresses. Carts can be stacked to minimize storage space.

## Key Features and Benefits

- Patient accessibility; bed hand rails quickly remove to access patients
- Adjustable backrest for patient comfort/multiple treatment needs
- Medical grade stainless steel for strength and durability
- RF-welded mattress seams allow for decontamination
- Anti-microbial cover fabric can be disinfected for re-use
- 2" pressure relief convoluted foam mattress provides comfortable sleeping surface
- Constructed of medical grade stainless steel for strength and durability
- Locking caster wheels with 10" leg extensions keeps bed safely in place
- Complies with WCFR 1633 fire code

## Standard Components

- 1 Standard E-Bed
- Adjustable leg extensions with locking casters
- Handrails
- 2" pressure relief convoluted foam mattress
- Adjustable backrest and molded ABS patient deck
- Adjustable IV pole
- Linen kit and pillow case
- Mesh shelf
- 2 caster storage bags

## Optional Equipment

Cart stores 10 E-Beds in 34" x 84" x 72" (0.9 x 2.1 x 1.8 m)

## SA-MEBEDCMPT Specifications NSN Pending

<b>Dimensions</b>	6' 8" x 2' 7"	(2.0 x 0.8 m)
<b>Height</b>	Adjustable up to 35"	(0.9 m)
<b>Weight</b>	92 lb	(41.7 kg)



Schedule  
Contract GS03F084CA



International  
Organization for  
Standardization



# MEDICAL ORGANIZER BAG

Part Number SA-MEMOBAG

Convenient Work Station and Storage



ISO 9001:2008 Registered Company



The Medical Organizer Bag (MO-Bag) was designed to help the medical provider organize, store and have medical supplies readily available at the patient's side while in the field. This unique bag has a built-in work station that provides much needed flat space for documentation, drug preparation, etc. Two convenient positions accommodate both standing and sitting heights.

## Key Features and Benefits

- 32 mesh pouches allow for organized storage
- Various sized pouches with hook and loop closures facilitates secure storage for small and large supplies
- Medical glove boxes with quick-grab openings
- Durable 18 oz. vinyl allows for easy disinfection and decontamination
- Hangs from shelter frame or optional self-supporting stand
- Unique Built-in adjustable desktop allow operator work space at the bed side or where MO bag is hung
- Rolls up for transport and storage without having to unpack supplies

## SA-MEMOBAG Specifications

<b>Dimensions</b>	27 x 60"	(0.7 x 1.5 m)
<b>Desk Space</b>	24 x 17"	(0.6 x 0.4 m)
<b>Weight</b>	6 lb	(2.7 kg)



# BUMP DOORS

Part Number SO-D046GKB

Move Patients Easily Through Doorways



ISO 9001:2008 Registered Company



The Bump Door was developed with emergency medicine in mind. It allows EMTs, nurses, or doctors to transport their patients quickly through the hospital without the burden of opening and closing doors. Designed for use as an interior door only, it can be hung between vestibule connections to allow separation from shelter to shelter while providing easy access.

## Key Features and Benefits

- Double acting opening motion allows for hands free, easy to open, smooth operation and allows for safe passage of personnel and equipment.
- Designed for interior usage
- Trip hazard reduction: threshold lies flat on ground, allowing gurneys to roll over it
- Simple storage: folds in half for easy storage and includes storage bag to maintain all components together
- Kick plate protects door from damage
- Clear pane windows resist condensation while maintaining clarity and insulating properties

## Standard Components

- 6063-T5 Aluminum Door Frame
- Two 72" Tall Doors
- Beige And Clear Vinyl
- Storage Bag

## SO-D046GKB Specifications NSN Pending

<b>Dimensions</b>	6' 1" x 4' 2"	(1.8 x 1.3 m)
<b>Total Weight</b>	72 lbs	(32.65 kg)
<b>Packaged Dimensions</b>	28 x 73 x 6.5"	(0.7 x 1.85 x 0.16 m)
<b>Hinges</b>	603 spring hinges	
<b>Windows</b>	Standard size	
<b>Kick Plate</b>	1/8" (0.3 cm) ABS plastic	



Schedule  
Contract GS03F084CA



International  
Organization for  
Standardization

# EMERGENCY SAFETY KIT

Part Number SHL-EMRKIT10

Keep Your Shelter Safe

**WESTERN SHELTER** SYSTEMS

ISO 9001:2008 Registered Company



While deployed in the field, your team should be focused on completing the mission at hand. That is why keeping your team and shelter system safe is one of our top priorities. We recommend the installation of these kits in each shelter to provide a heightened level of safety to all your operations.

## Key Features and Benefits

- Fully adjustable lamp heads for proper positioning
- Designed to be easily accessible to improve the safety of your team
- Universal custom mounting bracket allows the safety kit to be securely attached to shelter leg bars
- Easy access to batteries eliminates the need to remove the alarm from the ceiling for battery changes
- UL listed and meets or exceeds the following: UL 924, NEC, OSHA and NFPA 101 Life Safety Code requirements
- Efficient and secure Exit sign / Emergency Light Combo-LED light uses long lasting NiCads that are very low maintenance
- Talking combination smoke & carbon monoxide alarm safety feature alerts you to both smoke and/or carbon monoxide
- ABC rated fire extinguisher is a versatile solution for nearly any fire risk, from Class A (trash, wood, and paper), to Class B (liquids and gases), and Class C (electrical fires)

## Standard Components

- Heavy Duty Storage Case
- One Safety Mounting Plate
- Leg Bracket
- Emergency Light
- Lighted Exit Sign
- Fire Extinguisher And Indicator Sign
- Smoke/Carbon Monoxide Detector

## SHL-EMRKIT10 Specifications

<b>Packaged Dimensions</b>	31 x 12 x 12"	(0.78 x 0.3 x 0.3 m)
<b>Weight</b>	33 lb	(15 kg)



Safety Kit mounted conveniently on wall of shelter.

**GSA** Schedule  
Contract GS03F084CA

**ISO** International  
Organization for  
Standardization

# DECON SYSTEM

Part Number HZ-DS3LSII-4

Inflatable Shower Handles 80 Persons Per Hour



ISO 9001:2008 Registered Company



The HZ-DS3LSII-4 DECON System is a fast deployment three lane, four station inflatable mass decontamination shower.

The shower system is capable of handling three parallel lines of casualties at the same time passing four stations: undress area, detergent shower, rinse shower and redress area.

The undress and redress areas are dry areas. Shower stations are placed above a built-in waste water storage basin with a raised grid floor. Both outer lanes have three fixed spray nozzles per detergent and rinse station. The middle lane has two spray nozzle guns on a coiled hose line for soaping and two for rinsing. In total the decontamination shower system has sixteen discharge points.

## Key Features and Benefits

- Fast deployment, ready for use in 4 minutes
- 3 lanes handle 3 parallel lines of casualties simultaneously
- 4 stations, 1 shelter: undress, detergent shower, rinse shower and redress
- Dry undress and redress areas with overlapping curtains for privacy
- Shower stations located above a waste water storage basin with a raised grid floor safely catches grey water
- Outer lanes have 3 fixed spray nozzles per detergent and rinse station
- Center lane has 2 spray nozzle guns on a coiled hose for soaping and rinsing
- Shower groups connect to water supply via quick connection couplings
- Waste water storage basin holds over 250 gallon/1000 liters, pump removes excess water
- PVC coated canopy and divider curtains remove for easy cleaning or replacement
- Undress stations have a pass-through chute for clothing
- 4 skylights eliminate need for interior lighting
- All air beams, cover and floor are constructed of heavy-duty PVC coated polyester, high-frequency welded for strength and durability

## HZ-DS3LSII-4 Dimensions

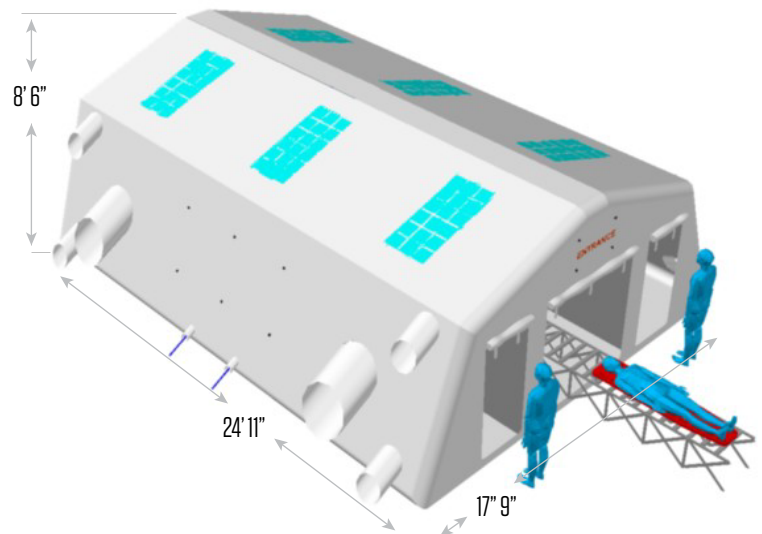

## Standard Components

- High-pressure inflation valve kit
- Waste water pump
- 11 plastic grid panels
- Protective ground cover
- Anchoring kit

# DECON SYSTEM

Part Number HZ-DS3LSII-4

Inflatable Shower Handles 80 Persons Per Hour



ISO 9001:2008 Registered Company

## HZ-DS3LSII-4 Specifications

<b>Shelter Dimensions</b>	24'11" x 17'9" x 8'6"	(7.6 x 5.4 x 2.6 m)
Door Dimensions	3'11" x 6'1"	(1 x 2.1 m)
Undress Dimensions	98 x 59"	(250 x 150 cm)
Detergent Dimensions	49" x 59"	125 x 150 cm
Rinse Dimensions	49" x 59"	(125 x 150 cm)
Redress Dimensions	98" x 59"	(250 x 150 cm)
<b>Airframe Diameter</b>	14" )	(35 cm)
<b>Working Pressure</b>	4.4 psi	(0.3 bar)
<b>Shelter Weight</b>	353 lbs	(160 kg)
Grid Panel Weight	170 lbs	(1.8m)
Pump Weight	13 lbs	(6 kg)
Inflator Weight	26 lbs	(12 kg)
<b>Packaged Dimensions</b>		
Shelter	28 x 39 x 47"	(70 x 100 x 120 cm)
Grid	31 x 47 x 47"	(80 x 120 x 120 cm)
<b>Water Requirements</b>	23 gal per min at 58 psi	(85 liter per min at 4 bar)
<b>Capacity</b>	80 people per hour	

## Recommended Support Systems

- Hot Water Generator
- Detergent Injector
- Water Ballast Tanks
- Stretcher Conveyor
- Lighting



# RTOC PROJECTION

Part Number AV-S02SD72  
Single Case Solution  
For Mobile Operations



ISO 9001:2008 Registered Company



## Key Features and Benefits

- The RTOC series display systems are single case solutions for mobile Operations Centers
- Components are stored within and assembled upon a single, rugged, weatherproof, aluminum case
- RTOCs can be operational in less than ten minutes and provide eyes-on Command and Control access to mission critical data.

## Standard Components

- Dual projector display system consisting of a lightweight, aluminum frame set
- Single 9.6 ft x 3.6 ft screen supporting two 72 inch diagonal viewing areas
- Two 1024 x 768 (XGA) DLP Projectors utilizing front over head projection
- Includes two 50" VGA Cables and spare bulbs
- Rugged aluminum case

## Optional Components

- Case options include D-ring tie downs, wheels, and color
- Single and triple display options available



Schedule  
Contract GS03F084CA



International  
Organization for  
Standardization

# RTOC LED+AUTO LIFT

Part Number AV-SOISD55 | AV-SOAL55

Fastest Eyes-On Command And Control



ISO 9001:2008 Registered Company



RTOC Auto Lift display systems provide visually impacting, Command and Control platforms for mobile operation centers. Utilizing a highly reliable, ultra-quiet, screw lift mechanism, the RTOC Auto Lift raises the display to an ideal viewing height with a push of a button.

RTOC Auto Lifts were developed with the mobile, tactical end user in mind. They combine the high contrast and sharp image of the latest LED monitors with the rugged portability of the RTOC product line.

## Key Features and Benefits

- External waterproof electronic I/O panel for power, audio, and video inputs.
- Aluminum transit case designed to meet US Military transit and vibration.
- Sets up/strikes in minutes with single button auto lift feature.
- Supports single panel and multi-display panel display arrangements
- Case I/O Panel: Power (120 VAC), HDMI, VGA and component

## Standard Components

- Mobile, rugged display system with 55" HD (1080p) monitor/TV and 240 Hz refresh rate

## Optional Components

- Lightweight aluminum frame set
- Interactive operational software with finger gestures or special pens
- Case options include D-ring tie downs, wheels, color
- Video Distribution Units (VDU) expand display capabilities by supporting multiple inputs and optional Quadview images

## AV-SOISD55 Specifications (RTOC w/55" LED)

<b>Deployed Dimensions</b>	65 x 34.1 x 72.2"	(1.7 x 0.9 x 1.8 m)
<b>Packaged Dimensions</b>	65 x 16.2 x 32.75"	(1.45 x 0.4 x 1 m)
<b>Total Weight</b>	178 lbs	(80.7 kg)
<b>Cube</b>	19.3 ft <sup>3</sup>	(0.5 m <sup>3</sup> )

## AV-SOAL55 Specifications (RTOC w/55" LED with Auto Lift)

<b>Deployed Dimensions</b>	56 x 16.3 x 78"	(1.4 x 0.4 x 1.9 m)
<b>Packaged Dimensions</b>	56.3 x 16.3 x 39"	(1.4 x 0.4 x 1 m)
<b>Total Weight</b>	222 lbs	(100.6 kg)
<b>Cube</b>	20.2 ft <sup>3</sup>	(0.6 m <sup>3</sup> )



Schedule  
Contract GS03F084CA



International  
Organization for  
Standardization

# RAPID SETUP/STRIKE DISPLAY SYSTEM

Part Number AV-S01D75

Eyes-On Access To Mission Critical Data



ISO 9001:2008 Registered Company



## Key Features and Benefits

- Rugged yet lightweight display system is operational in minutes
- Ultra-bright, high resolution images makes this system ideal for displaying C4ISR computer applications, surveillance feeds, UAV ops and mission planning
- System utilizes front, overhead screen projection.
- Deploy as a single unit or place multiple systems side-by-side to create a larger C2 picture

## Standard Components

- Lightweight aluminum frameset
- 75" diagonal screen
- 1400 x 1050 (SXGA+) DLP projector
- 25' VGA cable
- 25' Power cord

## AV-S01D75 Specifications

<b>Dimensions</b>	62 x 59 x 92.25"	(51.57 x 1.5 x 2.3 m)
<b>Weight</b>	180 lbs	(81.6 kg)
<b>Packaged Dimensions</b>		
1 case	50 x 18 x 14"	(1.27 x 0.45 x 0.35 m)
1 case	20 x 16 x 7.5"	(0.5 x 0.4 x 0.19 m.)



Schedule  
Contract GS03F084CA



International  
Organization for  
Standardization



# C2 COMMUNICATIONS TABLES

Part Number AV-SOCLST5 | AV-SOCLST6 | AV-SOCLSTC  
 AV-SOCLST5.31 | AV-SOCLST6.31 | AV-SOCLST5.170 | AV-SOCLST6.170  
 Pre-Wired Communications Tables



Made from lightweight, rugged aluminum, tables are pre-wired for power, classified and unclassified data networks, voice and video distribution. Standard Communications Tables come in lengths of 5 and 6 feet and corner table.

With integrated wiring and daisy-chaining C2 Communication Tables significantly reduce cable management issues and reduce setup/strike time and costs in both deployable and fixed TOCs/EOCs.

## Key Features and Benefits

- Ultra-durable, extruded aluminum table prewired for networks, voice, and video distribution
- Numerous table arrangement capabilities
- Storage and transit options include rugged, aluminum cases or economical padded bags

## Standard Components

- Data and Power Tables: 5 ft, 6 ft in length, corner table, 24 in deep, lightweight, integrated 120 VAC power, one TCP/IP switched data networks (8-port 10/100/1000, 4-Port PoE unamanged), VGA-based video distributions network. Includes one 12 ft. power cable
- Standard Table: 5 ft., 6ft. in length, corner table, 24 in deep, lightweight, channel brackets on table bottom to manage power, data, and video cable home runs

## Specifications

AV- SOCLST5	5' X 24", Standard	
Packaged Dimensions	60" x 24" x 2.88"	(1.5 x .6 x .07 m)
Deployed Dimensions	60" x 24" x 29.74"	(1.5 x .6 x .75 m)
Weight	30 lbs	(13.6 kg)
AV- SOCLST6	6' x 24", Standard	
Packaged Dimensions	72" x 24" x 2.88"	(1.8 x .6 x .07 m)
Deployed Dimensions	72" x 24" x 29.75"	(1.8 x .6 x .75 m)
Weight	35 lbs	(15.8 kg)
AV- SOCLSTC	Corner Standard	
Packaged Dimensions	60" x 24" x 2.88"	(1.5 x .6 x .07 m)
Deployed Dimensions	60" x 24" x 29.75"	(1.5 x .6 x .75 m)
Weight	26 lbs	(11.8 kg)
AV- SOCLST5.31	5' x 24", Power	
Packaged Dimensions	60" x 24" x 2.88"	(1.5 x .6 x .07 m)
Deployed Dimensions	60" x 24" x 29.75"	(1.5 x .6 x .75 m)
Weight	35 lbs	(15.8 kg)
AV- SOCLST6.31	6' x 30", Power	
Packaged Dimensions	72" x 24" x 2.88"	(1.8 x .6 x .07 m)
Deployed Dimensions	72" x 24" x 29.75"	(1.8 x .6 x .75 m)
Weight	40 lbs	(18.1 kg)
AV- SOCLST5.170	5'x 24", Data/Power	
Packaged Dimensions	60" x 24" x 5.88"	(1.5 x .6 x .75 m)
Deployed Dimensions	60" x 24" x 29.75"	(1.5 x .6 x .75 m)
Weight	47 lbs	(21.3 kg)
AV- SOCLST6.170	6' x 24", Data/Power	
Packaged Dimensions	72" x 24" x 5.88"	(1.8 x .6 x .15 m)
Deployed Dimensions	72" x 24" x 29.75"	(1.8 x .6 x .75 m)
Weight	52 lbs	(23.5 kg)

# VIDEO DISTRIBUTION UNIT

Part Number AV-SOVDU

Control Multiple Video Inputs / Outputs With One Device



ISO 9001:2008 Registered Company



## Key Features and Benefits

- Video / Audio switching system support
- Video Inputs: Five HD-15 VGA, one composite and one HDMI inputs
- Video Outputs: Four HD-15 VGA outputs
- One multi-image processor capable of displaying up to four separate video/image sources through a single projector or TV / monitor.
- Each of these image windows can be resized, moved, and named.
- Audio system supports two XLR microphones and one line level inputs and two line level outputs
- VDU System operates off of 120 VAC and all components are plugged into an uninterrupted power source (UPS)
- The VDU system is controlled by a touch-panel display or by a browser-based Graphical User Interface (GUI)
- All components mounted inside a rugged, weather-resistant, shock-mitigating case

## Standard Components

- Video/Audio switching system supporting five (5) HD-15 VGA, one (1) composite and one (1) HDMI inputs and four (4) HD-15 VGA output
- All components mounted inside a rugged, weather-resistant, shock-mitigating case.

## AV-SOVDU Specifications

<b>1 Case Dimensions</b>	36.8 x 27.5 x 20.5"	(0.9 x 0.7 x 0.5 m)
<b>Cube</b>	11.3 ft <sup>3</sup>	(0.3 m <sup>3</sup> )
<b>1 Case Dimensions</b>	16 x 13 x 6.9"	(0.4 x 0.3 x 0.2 m)
<b>Cube</b>	0.7 ft <sup>3</sup>	(0.02 m <sup>3</sup> )
<b>Deployed Dimensions</b>	36.8 x 18.5 x 20.5"	(0.9 x 0.5 x 0.5 m)
<b>Weight</b>	122 lbs	(55.4 kg)



Schedule  
Contract GS03F084CA



International  
Organization for  
Standardization

# TYPE W 2000V PORTABLE POWER CABLE ASSEMBLIES



A division of Western Shelter Systems

ISO 9001:2008 Registered Company

Type W Portable Power Cable Assemblies are designed for heavy-duty industrial power applications that require temporary or permanent power including portable generators, grounding, power extension, and mining and oil drilling.



## Key Features and Benefits

- UL Listed Portable Power Cable made from annealed no. 30 gauge bare copper stranding
- Flexible EPR/CPE single conductor portable power cable
- Reinforced strength featuring single faced rubber filled binder tape
- Incredible resistance to impact and abrasion
- Water, flame, ozone, sunlight, grease, weather, and chemical resistant
- Operating temperatures range from -40°C to 90°C dry

## Options

- Custom cable print
- Sequentially marked
- Made-to-order lengths
- Heat shrink logo ID

## Type W Assemblies

AWG	Ampacity* 40°C Ambient Temp.	Description
#2	190 A	#2 Type W w/Black Male & Female CAM Connectors
2/0	300	2/0 Type W w/Black Male & Female CAM Connectors
4/0	405	4/0 Type W w/Black Male & Female CAM Connectors

## Type W Pigtails

AWG	Ampacity* 40°C Ambient Temp.	Description
4/0	405 A	4/0 Type W 6' Pigtail w/Black Male CAM Connector and Bare
4/0	405 A	4/0 Type W 6' Pigtail w/Black Female CAM Connector and Bare
4/0	405 A	4/0 Type W 3' Pigtail w/Black Male CAM Connector and Bare
4/0	405 A	4/0 Type W 3' Pigtail w/Black Female CAM Connector and Bare

\*Ampacity – Free air measure; Based on continuous duty at 90°C conductor temperature no. Termination Options Available: Lug, Center Pin, Offset Pin, Shoo Pin, Barrel Pin

Specifications contained herein reflect current data and are subject to change. Values are nominal and or approximate..



Schedule  
Contract GS03F084CA



International  
Organization for  
Standardization

# NEMA WIRING DEVICE EXTENSIONS

20A extra hard usage cords with plugs and connectors resistant to moisture, chemicals, and environmental concerns so you can use indoors or outdoors.



A division of Western Shelter Systems

ISO 9001:2008 Registered Company



## Key Features and Benefits

- Produced with SOOW cord
- Straight blade, locking, and wetguard devices available
- Factory-tested
- 15A, 20A, and 30A assemblies
- Heavy-duty UL and CSA cable
- Excellent oil, water, abrasion, and UV resistance

## Options

- Carrying strap
- Custom lengths
- Custom cable identification

## Wetguard Locking Extensions

Rating	Cable	NEMA
20A, 125 VAC	12/3 SOOW	L5-20 Locking
20A, 250 VAC	12/3 SOOW	L6-20 Locking
20A, 125/250 VAC	12/4 SOOW	L14-20 Locking'

## SOOW 600V Cable

AWG	No. of Conductors	Stranding/Diameter	Nominal Insulation Thickness.	Nominal Jacket Thickness	Nominal O.D.	Approx. Weight lbs./1000'	Ampacity* 30°C Ambient Temp.
12	3	65/30	0.045" (1.14 mm)	0.095" (2.41 mm)	0.59" (15.2 mm)	217	25.0 A
12	4	65/30	0.045" (1.14 mm)	0.095" (2.41 mm)	0.64" (16.5 mm)	261	20.0 A

\*Ampacity - Free air measured; based on continuous duty at 90°C conductor temperature

Specifications contained herein reflect current data and are subject to change. Values are nominal and or approximate..



Schedule Contract GS03F084CA



International Organization for Standardization

# IEC 60309 PIN AND SLEEVE EXTENSIONS

Safe, reliable power for any type of heavy-duty temporary or permanent equipment. Use to supply power to welders, gen-sets, compressors, conveyors, portable tools and lighting equipment.

# WSPower

A division of Western Shelter Systems

ISO 9001:2008 Registered Company



## Key Features and Benefits

- Assembled with 30A, 60A, and 100A plug and connectors and Type W or Type S00W cable
- Corrosion and impact resistance
- Waterproof seals to resist harsh weather and rough working conditions
- Secure electrical connections and superior performance in high-abuse environments
- Also known as 3 Wire Pin and Sleeve Cables and IEC 309 Power Cords
- Standard lengths: 25' and 50'

## Options

- Tie-ins
- Custom lengths
- Custom cable identification
- Arktite® Plugs, Receptacles and Connectors

## IEC 60309 Pin And Sleeve Extensions

Rating	Cable	Connectors
30A, 4 Pole, 5 Wire, 120/208VAC, 3 Phase	10/5 Type S00W	IEC 60309, Wetright Pin & Sleeve
60A, 4 Pole, 5 Wire, 120/208VAC, 3 Phase	6/5 Type S00W	IEC 60309, Wetright Pin & Sleeve
100A, 4 Pole, 5 Wire, 120/208VAC, 3 Phase	4/5 Type W	IEC 60309, Wetright Pin & Sleeve
30A, 4 Pole, 5 Wire, 600VAC, 3 Phase	10/5 Type S00W	NEMA 4X, Powermate Pin & Sleeve
60A, 4 Pole, 5 Wire, 600VAC, 3 Phase	6/5 Type S00W	NEMA 4X, Powermate Pin & Sleeve
100A, 4 Pole, 4 Wire, 600VAC, 3 Phase	4/4 Type W	NEMA 4X, Powermate Pin & Sleeve

Specifications contained herein reflect current data and are subject to change. Values are nominal and or approximate.



Schedule  
Contract GS03F084CA



# 50A TWIST-LOCK EXTENSIONS AND TIE-INS

Used to provide temporary power for disaster recovery and industrial applications.



A division of Western Shelter Systems

ISO 9001:2008 Registered Company



## Key Features and Benefits

- Assembled with 6/4 cable and black & white 50A Non-NEMA line of industrial-grade locking blade connectors
- Great impact, sunlight, and chemical resistance
- Withstands rough use
- Connectors feature one-piece construction for maximum conductivity
- Also known as California style cords and 6/4 spider box cables
- Brass mounting system for a safer resistance ground path

## Options

- Custom lengths
- Custom cable identification

## Extensions and Tie-Ins

Male Connector	Female Connector	Cable	Lengths
Non-NEMA, 125/250V AC, 3P/4W, Black & White Locking Connector, Industrial Grade, Grounding, California-Style (CS)	Non-NEMA, 125/250V AC, 3P/4W, Black & White Locking Connector, Industrial Grade, Grounding, California-Style (CS)	6/4	25', 50', 75', 100'
Non-NEMA, 125/250V AC, 3P/4W, Black & White Locking Connector, Industrial Grade, Grounding, California-Style (CS)	Bare	6/4	5'
Bare	Non-NEMA, 125/250V AC, 3P/4W, Black & White Locking Connector, Industrial Grade, Grounding, California-Style (CS)	6/4	5'

## S00W Cable

AWG	No. of Conductors	Stranding/Diameter	Nominal Insulation Thickness.	Nominal Jacket Thickness	Nominal O.D.	Approx. Weight lbs./1000'	Ampacity* 30°C Ambient Temp.
6	4	184/0.0117	0.060" (1.52 mm)	0.140" (3.56 mm)	1.05" (26.7 mm)	785	45.0 A

\*Ampacity – Free air measured; based on continuous duty at 90°C conductor temperature

Specifications contained herein reflect current data and are subject to change. Values are nominal and/or approximate.



Schedule Contract GS03F084CA



International Organization for Standardization

# 5-BANDED CAM LOCK CABLE EXTENSIONS

Assembled with UL and c(UL) Listed SC cable made from annealed no. 30 gauge bare copper stranding.



A division of Western Shelter Systems

ISO 9001:2008 Registered Company



## Key Features and Benefits

- Banded every 24" with heavy-duty glued shrink
- Durable CPE insulation
- Meets/exceeds flame test requirements of UL and c(UL)
- Resistant to sunlight, water, ozone, abrasion, acids, heat, flame, and chemicals
- Excellent flexibility and durability
- Standard lengths: 25' and 50'

## Options

- Reversed ground 5-wire sets
- Carrying straps
- Custom lengths
- Custom cable identification

## 5-Banded Cable Assemblies

Male Connector	Female Connector	Length	Description
(5) 16 Series Cams	(5) 16 Series Cams	25', 50'	SC
(5) 16 Series Cams	Bare	25', 50'	SC
Bare	(5) 16 Series Cams	25', 50'	SC

## SC CABLE

Power Conductor Size	Power Conductor Stranding	Nominal Jacket Thickness	Nominal O.D.	Approx. Weight	Ampacity*
6 AWG	# Wires   258/30	0.095" (2.41 mm)	0.371" (9.4 mm)	131 lbs/1000' (195 kgs/km)	105
4 AWG	# Wires   410/30	0.095" (2.41 mm)	0.430" (10.9 mm)	189 lbs/1000' (282 kgs/km)	140
2 AWG	# Wires   649/30	0.106" (2.69 mm)	0.509" (12.9 mm)	285 lbs/1000' (424 kgs/km)	190
1 AWG	# Wires   815/30	0.136" (3.45 mm)	0.611" (15.5 mm)	379 lbs/1000' (564 kgs/km)	220
1/0 AWG	# Wires   1032/30	0.136" (3.45 mm)	0.672" (17.1 mm)	463 lbs/1000' (689 kgs/km)	260
2/0 AWG	# Wires   1287/30	0.136" (3.45 mm)	0.697" (17.1 mm)	549 lbs/1000' (816 kgs/km)	300
3/0 AWG	# Wires   1622/30	0.136" (3.45 mm)	0.777" (19.7 mm)	674 lbs/1000' (1003 kgs/km)	350
4/0 AWG	# Wires   2052/30	0.136" (3.45 mm)	0.803" (20.4 mm)	814 lbs/1000' (1212 kgs/km)	405

\*Ampacities are based on single conductor in free air, 30°C ambient air temperature 90°C conductor operating temperature per Table 400-5 (B) of the 2008 NEC

Specifications contained herein reflect current data and are subject to change. Values are nominal and or approximate.



# FEEDER CABLES WITH CAM-TYPE CONNECTORS

EL-CB40W XX | EL-CB40 XX } EL-CB20W XX | EL-CB20 XX  
 EL-CB5W2526 XX Cable Extensions



A division of Western Shelter Systems

ISO 9001:2008 Registered Company



## Key Features and Benefits

- Thermostat Jacket For Enhanced Durability And Resistance To Oil And Solvents
- Weather And UV Resistant Type Cable
- Custom Cable Labels And Legending Available For Personalization And Theft Deterrence

## Specifications

Part Number	Cable	Rating	Male Connector	Female Connector
EL-CB40W XX	4/0 AWG Type W (Industrial)	400 Amp, 600 VAC	16 Series Inline	16 Series Inline
EL-CB40 XX	4/0 AWG Type SC (Entertainment)	400 Amp, 600 VAC	16 Series Inline	16 Series Inline
EL-CB20W XX	2/0 AWG Type W (Industrial)	200 Amp, 600 VAC	16 Series Inline	16 Series Inline
EL-CB20 XX	2/0 AWG Type SC (Entertainment)	200 Amp, 600 VAC	16 Series Inline	16 Series Inline
EL-CB02 XX	#2 AWG Type SC (Entertainment)	100 Amp, 600 VAC	16 Series Inline	16 Series Inline
EL-CB5W2526 XX	#2 AWG Type SC (5) Wire Banded	100 Amp, 600 VAC	(5) 16 Series Inline	3 Phase, 4 Wire, Grounding**

Add Suffix To Indicate Connector Color: A=Black B=White C=Red D=Blue E=Green      XX To Specify Cable Length



Schedule  
 Contract GS03F084CA



International  
 Organization for  
 Standardization



# FEEDER CABLES WITH CAM-TYPE CONNECTORS **WSPOWER**

A division of Western Shelter Systems

ISO 9001:2008 Registered Company

PART NUMBER EL-CBTS40W XX | EL-CBTS40 XX | EL-CBTS20W XX

ELCBTS20 XX | EL-CBTS02W XX | SS40C | SS20C | SS02C

TIE-IN SETS AND SOFT SIAMESE



## Key Features and Benefits

- Thermoset Jacket Provides Enhanced Durability And Resistance To Oil And Solvents
- Weather And UV Resistant Type Cable
- Custom Cable Labels And Legending Available For Personalization And Theft Deterrence

## Bare End Tie-In Sets Specifications

Part Number	Cable	Rating	Male Connector	Female Connector
EL-CBTS40W XX	4/0 AWG Type W (Industrial)	400 Amp, 600 VAC	Bare Cable End	(5) 16 Series Inline
EL-CBTS40 XX	4/0 AWG Type SC (Entertainment)	400 Amp, 600 VAC	Bare Cable End	(5) 16 Series Inline
EL-CBTS20 XX	2/0 AWG Type W (Industrial)	200 Amp, 600 VAC	Bare Cable End	(5) 16 Series Inline
EL-CBT20 XX	2/0 AWG Type SC (Entertainment)	200 Amp, 600 VAC	Bare Cable End	(5) 16 Series Inline
EL-CBTS02W XX	#2 AWG Type W (Industrial)	100 Amp, 600 VAC	Bare Cable End	(5) 16 Series Inline

XX To Specify Cable Length



Schedule  
Contract GS03F084CA



International  
Organization for  
Standardization

# XLR SHIELDED DATA CABLES

PART NUMBER EL-CBXL3P XX | EL-CBCC4P XX | EL-CBDM5P XX

DMX EXTENSIONS AND SHIELDED XLR DATA CABLES



ISO 9001:2008 Registered Company



## Key Features and Benefits

- Heavy Duty Tour-Grade Polyurethane Jacket Offers Dependability And Long Life
- Rugged Neutrik Black/Silver Connectors Provide Reliable Long-Lasting Connections
- Water And UV Resistant, Suitable For Outdoor Use
- Customer Labeling And/Or Color Code Applied At No Extra Charge
- Extra Flexible For Ease-Of-Use

## Specifications

Part Number	Cable	Type	Male Connector	Female Connector
EL-CBXL3P XX	1 Pair and Shield, 22 AWG black Polyurethane Jacket	3 Pin XLR	3 Pin XLR Neutrick (Black/Silver)	3 Pin XLR Neutrick (Black/Silver)
EL-CBCC4P XX	1 Pair and Shield, 22 AWG (2) 14 AWG Black Polyurethane Jacket	Color Changer	4 Pin XLR Neutrick(Black/Silver)	4 Pin XLR Neutrick(Black/Silver)
EL-CBDM5P XX	2 Pair and 2 Shield, 22 AWG Black Polyurethane Jacket	DMX 512	5 Pin XLR Neutrick(Black/Silver)	5 Pin XLR Neutrick(Black/Silver)

Western Shelter Systems provides a full line of tour-grade DMX extensions and related shielded XLR data cables for intercom, color changers, RFU remote-focus units and LED luminaries  
XX To Specify Cable Length



Schedule  
Contract GS03F084CA



International  
Organization for  
Standardization

# CABLE EXTENSIONS AND TIE-INS

MIL-DTL-22992 CLASS L

Military Class L Cable Extensions

# WSPower

A division of Western Shelter Systems

ISO 9001:2008 Registered Company



## Key Features and Benefits

- Recessed socket contacts within the insert create an arc-suppressing chamber which enhances protection if connectors are separated under load
- A combination of grommets and seals provides waterproof protection when devices are mated or unmated, capped or uncapped
- Extra hard usage Type G cable provides 4 current carrying conductors plus 4 ground conductors
- 4-inch clear heat shrink included for user label customization

## MIL-STD-22992 Cord Assemblies, Class L Specifications

Part Number	Description	Rating	Male Connector	Female Connector	Cable
EL-CB60A25M	Cord Assemblies, Class L, 25', MIL-STD-22992	60 Amp, 120/208 VAC	3 Phase, 4 Wire, Grounding*	3 Phase, 4 Wire, Grounding*	6/4 type G cable
EL-CB60A50M	Cord Assemblies, Class L, 50', MIL-STD-22992	60 Amp, 120/208 VAC	3 Phase, 4 Wire, Grounding*	3 Phase, 4 Wire, Grounding*	6/4 type G cable
EL-CB60A100M	Cord Assemblies, Class L, 100', MIL-STD-22992	60 Amp, 120/208 VAC	3 Phase, 4 Wire, Grounding*	3 Phase, 4 Wire, Grounding*	6/4 type G cable
EL-CB100A25M	Cord Assemblies, Class L, 25', MIL-STD-22992	100 Amp, 120/208 VAC	3 Phase, 4 Wire, Grounding**	3 Phase, 4 Wire, Grounding*	2/4 type G cable
EL-CB100A50M	Cord Assemblies, Class L, 50', MIL-STD-22992	100 Amp, 120/208 VAC	3 Phase, 4 Wire, Grounding**	3 Phase, 4 Wire, Grounding*	2/4 type G cable
EL-CB100A100M	Cord Assemblies, Class L, 100', MIL-STD-22992	100 Amp, 120/208 VAC	3 Phase, 4 Wire, Grounding**	3 Phase, 4 Wire, Grounding*	2/4 type G cable
EL-CB200A25M	Cord Assemblies, Class L, 25', MIL-STD-22992	200 Amp, 120/208 VAC	3 Phase, 4 Wire, Grounding**	3 Phase, 4 Wire, Grounding*	4/0/4 type G cable
EL-CB200A50M	Cord Assemblies, Class L, 50', MIL-STD-22992	200 Amp, 120/208 VAC	3 Phase, 4 Wire, Grounding**	3 Phase, 4 Wire, Grounding*	4/0/4 type G cable
EL-CB200A100M	Cord Assemblies, Class L, 100', MIL-STD-22992	200 Amp, 120/208 VAC	3 Phase, 4 Wire, Grounding**	3 Phase, 4 Wire, Grounding*	4/0/4 type G cable

## MIL-STD-22992 Tie-In (Pigtail) Assemblies, Class L Specifications

EL-TR60A9M	Tie-In Assemblies, Class L, 9', Receptacle x MIL-STD-22992	60 Amp, 120/208 VAC	3 Phase, Bare Cable End	3 Phase, 4 Wire, Grounding*	6/4 type G cable
EL-TR60A12M	Tie-In Assemblies, Class L, 12', Receptacle x MIL-STD-22992	60 Amp, 120/208 VAC	3 Phase, Bare Cable End	3 Phase, 4 Wire, Grounding*	6/4 type G cable
EL-TR60A13M	Tie-In Assemblies, Class L, 13', Receptacle x MIL-STD-22992	60 Amp, 120/208 VAC	3 Phase, Bare Cable End	3 Phase, 4 Wire, Grounding*	6/4 type G cable
EL-TR100A12M	Tie-In Assemblies, Class L, 12', Receptacle x MIL-STD-22992	100 Amp, 120/208 VAC	3 Phase, Bare Cable End	3 Phase, 4 Wire, Grounding*	2/4 type G cable
EL-TP100A15M	Tie-In Assemblies, Class L, 15', Receptacle x MIL-STD-22992	100 Amp, 120/208 VAC	3 Phase, Bare Cable End	3 Phase, 4 Wire, Grounding*	2/4 type G cable
EL-TR200A12M	Tie-In Assemblies, Class L, 12', Receptacle x MIL-STD-22992	200 Amp, 120/208 VAC	3 Phase, Bare Cable End	3 Phase, 4 Wire, Grounding*	4/0/4 type G cable

For custom cable lengths and cable labels, please contact us at 1.800.971.7201

\*Construction includes (5) pins/contacts



Schedule  
Contract GS03F084CA



### MIL-STD-22992 TIE-IN (Pigtail) Assemblies, Class L Specifications

Part Number	Description	Rating	Male Connector	Female Connector	Cable
EL-TP100A15M	Tie-In Assemblies, Class L, 15', Plug x MIL-STD-22992	200 Amp, 120/208 VAC	3 Phase, Bare Cable End	3 Phase, 4 Wire, Grounding*	4/0/4 type G cable
EL-TR200A12M	Tie-In Assemblies, Class L, 12', Receptacle x MIL-STD-22992	200 Amp, 120/208 VAC	3 Phase, Bare Cable End	3 Phase, 4 Wire, Grounding*	4/0/4 type G cable

### MIL-STD-22992 Tie-In (Pigtail) Assemblies, Class L Specifications

EL-TP60A9M	Tie-In Assemblies, Class L, 9', Plug x MIL-STD-22992	60 Amp, 120/208 VAC	3 Phase, Bare Cable End	3 Phase, 4 Wire, Grounding*	6/4 type G cable
EL-TP60A12M	Tie-In Assemblies, Class L, 12', Plug x MIL-STD-22992	60 Amp, 120/208 VAC	3 Phase, Bare Cable End	3 Phase, 4 Wire, Grounding*	6/4 type G cable
EL-TP60A13M	Tie-In Assemblies, Class L, 13', Plug x MIL-STD-22992	60 Amp, 120/208 VAC	3 Phase, Bare Cable End	3 Phase, 4 Wire, Grounding*	6/4 type G cable
EL-TP100A12M	Tie-In Assemblies, Class L, 12', Plug x MIL-STD-22992	100 Amp, 120/208 VAC	3 Phase, Bare Cable End	3 Phase, 4 Wire, Grounding*	2/4 type G cable
EL-TP100A15M	Tie-In Assemblies, Class L, 15', Plug x MIL-STD-22992	100 Amp, 120/208 VAC	3 Phase, Bare Cable End	3 Phase, 4 Wire, Grounding*	6/2/4 type G cable
EL-TP200A12M	Tie-In Assemblies, Class L, 12', Plug x d MIL-STD-22992	200 Amp, 120/208 VAC	3 Phase, Bare Cable End	3 Phase, 4 Wire, Grounding*	4/0/4 type G cable

### MIL-STD-22992 Electrical Accessories, Class L Specifications

EL-RCWM60AM	Receptacle, Wall Mount, Class L, MIL-STD-22992	60 Amp, 120/208 VAC			
EL-PLIN60AM	Plug, Male Inline, Class L, MIL-STD-22993	60 Amp, 120/208 VAC			
EL-CNINGOAM	Connector, Female Inline, Class L, MIL-STD-22994	60 Amp, 120/208 VAC			
EL-PLWM60AM	Plug, Wall Mount, Class L, MIL-STD-22995	60 Amp, 120/208 VAC			
EL-RCWM100AM	Receptacle, Wall Mount, Class L, MIL-STD-22992	100 Amp, 120/208 VAC			
EL-PLIN100AM	Plug, Male Inline, Class L, MIL-STD-22993	100 Amp, 120/208 VAC			
EL-CNIN100AM	Connector, Female Inline, Class L, MIL-STD-22994	100 Amp, 120/208 VAC			
EL-PLWM100AM	Plug, Wall Mount, Class L, MIL-STD-22995	100 Amp, 120/208 VAC			
EL-RCWM200AM	Receptacle, Wall Mount, Class L, MIL-STD-22992	200 Amp, 120/208 VAC			
EL-PLIN200AM	Plug, Male Inline, Class L, MIL-STD-22993	200 Amp, 120/208 VAC			
EL-CNIN200AM	Connector, Female Inline, Class L, MIL-STD-22994	200 Amp, 120/208 VAC			
EL-PLWM200AM	Plug, Wall Mount, Class L, MIL-STD-22995	200 Amp, 120/208 VAC			

For custom cable lengths and cable labels, please contact us at 1.800.971.7201 \*Construction includes (5) pins/contacts



## We Care About Your Success

Field deployments under adverse conditions call for teams that are highly proficient with their equipment. That is why Western Shelter's advanced training center offers instructional programs to support our full line of products.

Over the years we have built an outstanding team of instructors capable of providing a wide range of trainings from basic awareness to advanced preparedness. These courses include:

- **Western Shelter Operations 100 (Awareness Level)**  
Learn to assist in the deployment of the Western Shelter System
- **Western Shelter Operations 200 (Operations Level)**  
A more in-depth training approach for team operators
- **Western Shelter Operations 300 (Technician Level)**  
Designed for the advanced level person to confidently be assigned as Subject Matter Experts (SME's) on particular components of the Western Shelter System
- **Western Shelter Base Camp Operations Training**  
Training for established groups. Test your team's ability to deploy your assets while providing Base of Operations Training on your Western Shelter Systems

Our programs concentrate on three pillars of comprehensive emergency management preparedness: planning, training, and exercises. They are developed with the entire emergency management cycle in mind, which helps us provide comprehensive services from plan development to product specific training, team training to full scale exercises.

Western Shelter Training programs are intended to be collaborative and engaging. Trainees are encouraged to apply their knowledge during the course, which results in greater retention and improved performance under real world conditions.

For additional information on the Western Shelter Advanced Training Center Courses or product information, please visit us at:  
[www.westernshelter.com](http://www.westernshelter.com)

or contact:

**Jean-Louis Gomes**

Western Shelter Systems Training Program Manager

Office: (541) 743-4125

Cell: (910) 354-9239



## Western Shelter Training

Our programs are developed with the entire emergency management cycle in mind, which helps us provide comprehensive services. They concentrate specifically on planning, training and exercises for emergency management preparedness:

- **Planning** – Western Shelter Systems works with local representatives of specific agencies to provide industry best practices in planning for immediate response to emergencies and the deployment of their Western Shelter System assets.
- **Training** – Using adult learning principles, Western Shelter Systems conducts training on newly developed or revised plans to orient employees or members to their roles and responsibilities. Western Shelter Systems can also conduct Incident Command System training and Base of Operations Training.
- **Exercises** – Western Shelter Systems uses the Homeland Security Exercise and Evaluation Program (HSEEP) and FEMA Guidelines to design and conduct base camp operations and full scale exercises. The exercise design process incorporate client needs and objectives.

Interactions with Western Shelter Systems staff will be personal and focused on what works best for the client in order to submit a proposal that outlines the scope of the project and the deliverables. We will guide the client through the project by providing best practices and expertise when necessary.

It is important to us that clients feel like Western Shelter Systems is part of their team and genuinely interested in the growth of the client's emergency readiness.

Participants receive a hard copy of the training manual and a certificate upon completion.

