

SNAPTANK

Part Number ST-1000 | ST-1500 | ST-2000 | ST-2500 | ST-3000

Rigid -Framed Tank



ISO 9001:2008 Registered Company



Realize all the advantages of a rigid-framed relay/dump tank with the mobility and compact packaging of an unsupported freestanding tank. No spill over, no rolling.

Nothing in the industry offers more structural integrity on flat or uneven ground than the SnapTank. With its quality components and interchangeable parts, the SnapTank can add valuable capacity to any response without the expensive apparatus modifications necessary to transport a traditional rigid tank.

Constructed of the finest aircraft quality aluminum components, SnapTank is light, yet durable and can be fully functional in minutes. Five models offer capacities from 1,000 to 3,000 gallons, each plumbed with a standard 3" threaded flange with plug and packaged in a compact field bag.

STORAGE/TRANSPORT

| MODEL | WEIGHT | LENGTH | WIDTH | HEIGHT |
|---------|---------|--------|-------|--------|
| ST 1000 | 74 lbs | 39" | 16" | 14" |
| ST 1500 | 90 lbs | 49" | 16" | 14" |
| ST 2000 | 101 lbs | 56" | 16" | 14" |
| ST 2500 | 110 lbs | 63" | 16" | 14" |
| ST3000 | 121 lbs | 69" | 16" | 14" |

CAPACITIES AND ASSEMBLED DIMENSIONS

| MODEL | Gallons | A | B | C | D |
|---------|---------|------|-----|-----|------|
| ST 1000 | 1,000 | 100" | 33" | 38" | 98" |
| ST 1500 | 1,500 | 136" | 33" | 48" | 122" |
| ST 2000 | 2,000 | 150" | 33" | 55" | 139" |
| ST 2500 | 2,500 | 169" | 33" | 62" | 156" |
| ST3000 | 3,000 | 185" | 33" | 68" | 170" |

SNAPTANK™

WESTERN SHELTER SYSTEMS™
US AND FOREIGN PATENTS

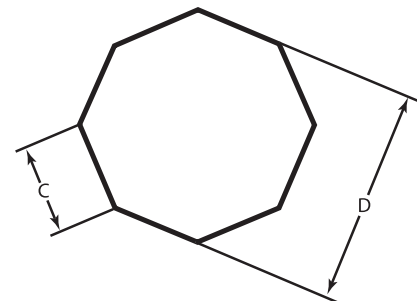
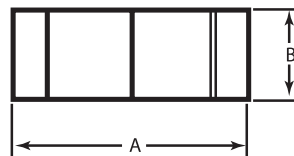

GROUND COVERS

| | |
|--------|-------------------------|
| GC1000 | Ground Cover for ST1000 |
| GC1500 | Ground Cover for ST1500 |
| GC2000 | Ground Cover for ST2000 |
| GC2500 | Ground Cover for ST2500 |
| GC3000 | Ground Cover for ST3000 |



Schedule
Contract GS03F084CA



International
Organization for
Standardization